

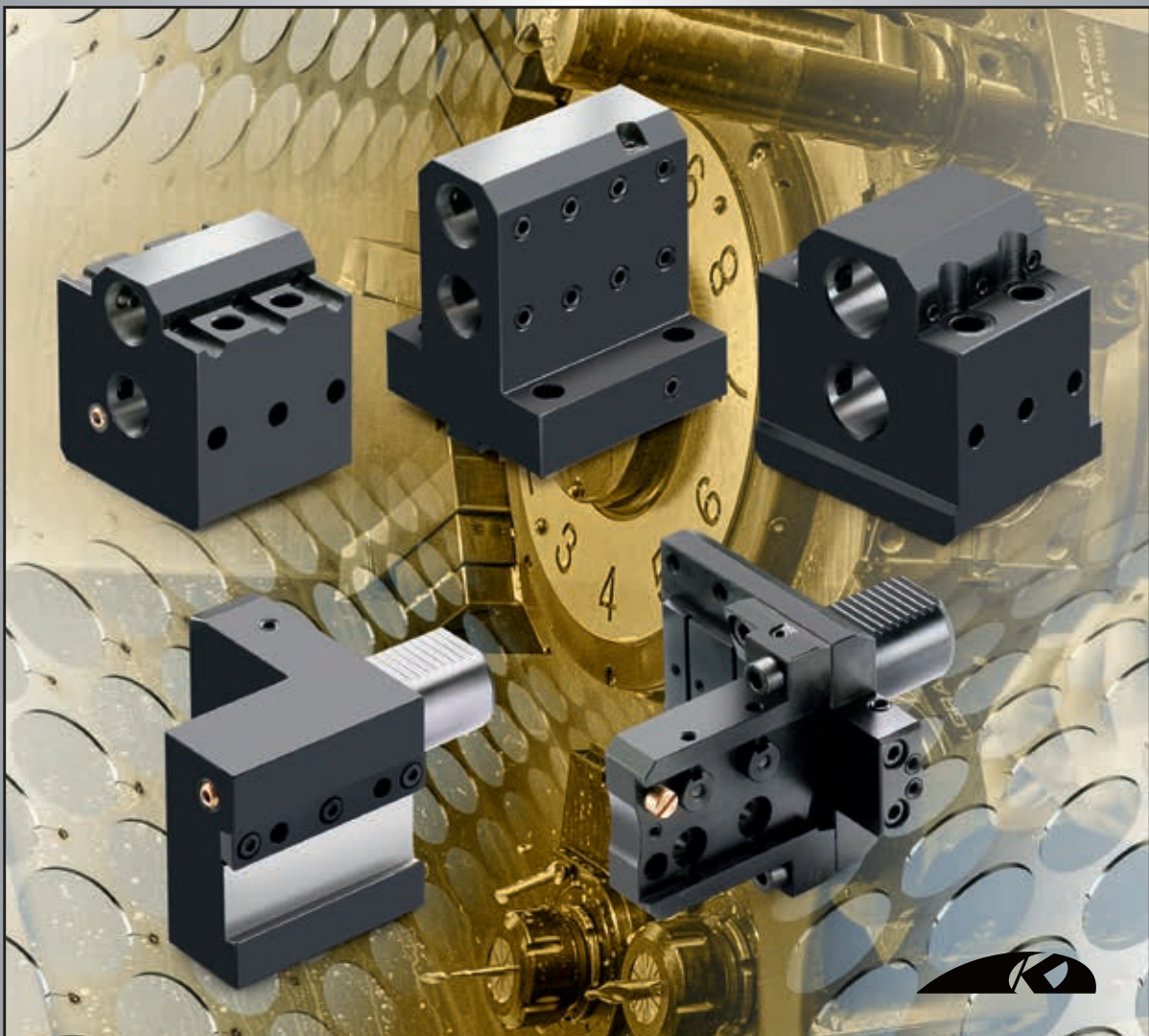

# KINTEK®

COMPONENTI INNOVATIVI TECNOMECCANICI



TOOLHOLDERS FOR CNC LATHES  
**BIGLIA**

**BIGLIA**

B301/445/470/501(Y-S)  
 510/545/550/565/650/658  
 1200/446/465/745  
 765-B750/1250 16 ST.

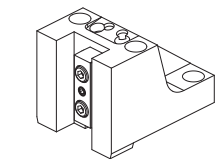

128-41524 (20x20 mm)  
 128-41525 (25x25 mm)

Face and O.D. cutting holder

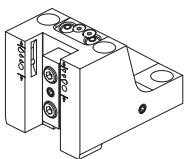

128-41524-IC (20x20 mm)  
 128-41525-IC (25x25 mm)  
 IC-TOOLTEK

Face and O.D. cutting holder

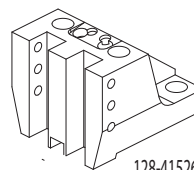

128-41526

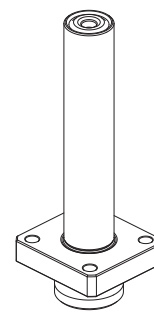

Control pin  
 137-00209

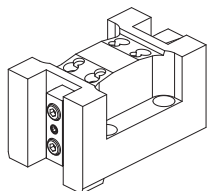

128-41527

Face and O.D. cutting holder

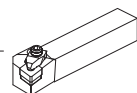

Qualified tool  
 20x20 mm

128-41527-IC

IC-TOOLTEK

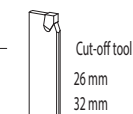
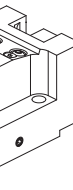

Cut-off tool  
 26 mm  
 32 mm

Cut-off holder

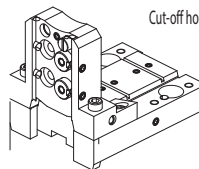

128-11566 (26 mm)  
 128-11567 (32 mm)

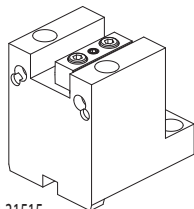

128-31515

Face and O.D. cutting holder

Face and O.D. cutting holder  
 Polygonal C50

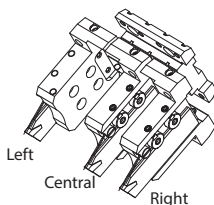

Left  
 Central  
 Right

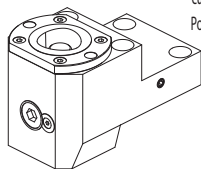

128-11580

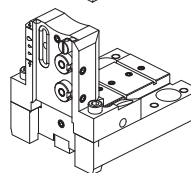

128-11566-IC (26 mm)  
 128-11567-IC (32 mm)  
 IC-TOOLTEK

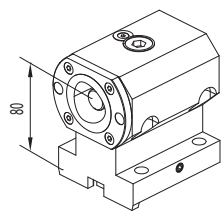

128-11579

Boring bar holder  
 Polygonal C50

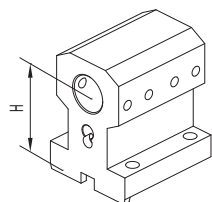

128-21538 D32 H=80  
 128-21540 D32 H=100  
 128-21548 D40 H=80

Toolholder for boring bar

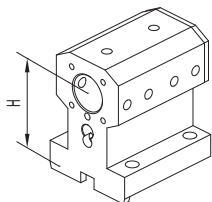

128-21539 D32 H=80  
 128-21541 D32 H=100  
 128-21549 D40 H=80

Combi toolholder for boring bar and insertdrill

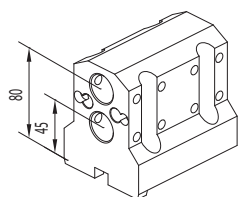

128-21542

Toolholder for boring bar

2xØ25 mm

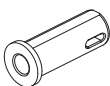

D32  
 Drill socket  
 114-33208 <MT1>  
 114-33209 <MT2>

D40  
 114-34008 <MT2>  
 114-34009 <MT3>

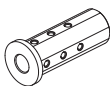

Boring bar sleeve  
 115-63260 (Ø8)  
 115-63261 (Ø10)  
 115-63211 (Ø12)  
 115-63212 (Ø16)  
 115-63213 (Ø20)

115-64043 (Ø8)  
 115-64044 (Ø10)  
 115-64045 (Ø12)  
 115-64046 (Ø16)  
 115-64047 (Ø20)  
 115-64048 (Ø25)

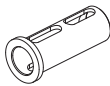

Boring bar sleeve  
 115-63214 (Ø25)

115-64049 (Ø32)

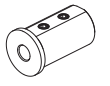

Boring bar sleeve  
 165-63352 (Ø8)  
 165-63353 (Ø10)  
 165-63354 (Ø12)

165-64247 (Ø8)  
 165-64248 (Ø10)  
 165-64249 (Ø12)

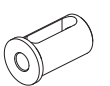

Boring bar sleeve  
 165-63356 (Ø16)  
 165-63358 (Ø20)  
 165-63359 (Ø25)

165-64251 (Ø16)  
 165-64253 (Ø20)  
 165-64254 (Ø25)  
 165-64255 (Ø32)

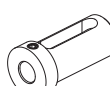

Boring bar sleeve  
 165-63347 (Ø16)  
 165-63349 (Ø20)  
 165-63350 (Ø25)

165-64241 (Ø16)  
 165-64243 (Ø20)  
 165-64244 (Ø25)  
 165-64245 (Ø32)



Boring bar sleeve  
 115-62573 (Ø6)  
 115-62538 (Ø8)  
 115-62539 (Ø10)  
 115-62540 (Ø12)

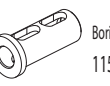

Boring bar sleeve  
 115-62541 (Ø16)

Protection cover  
 137-00244

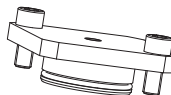

**ACCESSORIES**

**Driven tools**

**FAST-IN**



124-05521  
 124-05522 i.coolant

124-05523  
 124-05524 i.coolant  
 124-05525 i.coolant 80 BAR

**CONNECTION**

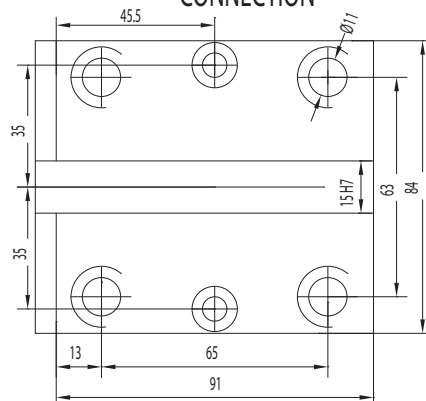

## CONNECTION

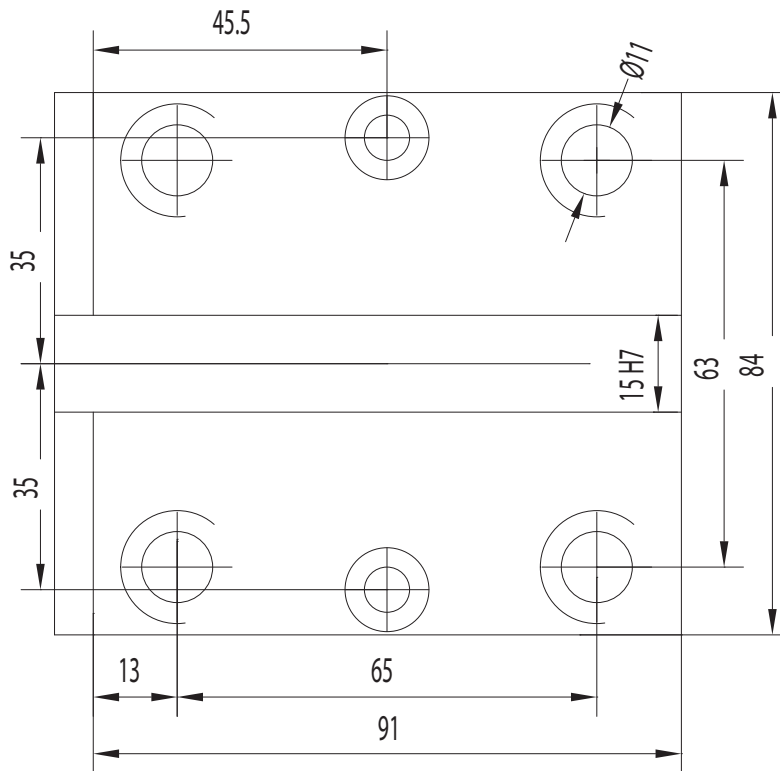

## PORTAUTENSILE RADIALE - RADIAL TOOLHOLDERS

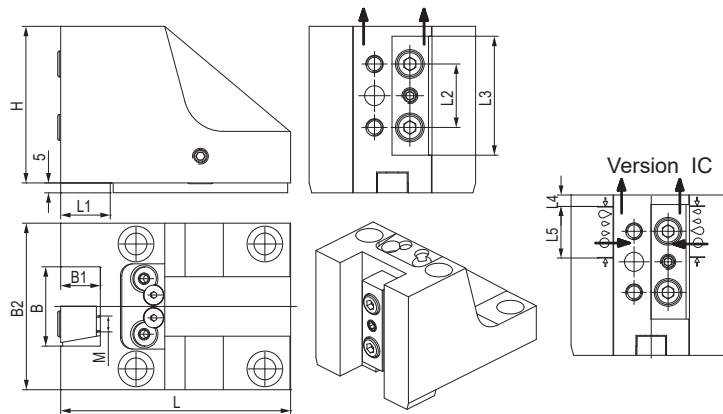

CODE N.	INTERNAL COOLANT	B1	B	B2	L	L1	L2	L3	L4	L5	H	M
128-41524	NO	20	40	84	116	25	32	60	6	27	79	M8
128-41524-IC	YES	20	40	84	116	25	32	60	6	27	79	M8
128-41525	NO	25	50	98	121	30	46	80	8	32	84	M10
128-41525-IC	YES	25	50	98	121	30	46	80	8	32	84	M10

CODE N.	CLAMPING PLATE	KEY	SCREW FOR KEY	COOLANT BALL	SCREW FOR BALL	O RING
128-41524	832-007030	814-203230	811-101016	833-001410	811-108024	823-101015
128-41524-IC	832-007030	814-203230	811-101016	833-001410	811-108024	823-101015
128-41525	832-007540	814-203230	811-101016	833-001410	811-108024	823-101015
128-41525-IC	832-007540	814-203230	811-101016	833-001410	811-108024	823-101015

## PORTAUTENSILE RADIALE - RADIAL TOOLHOLDERS

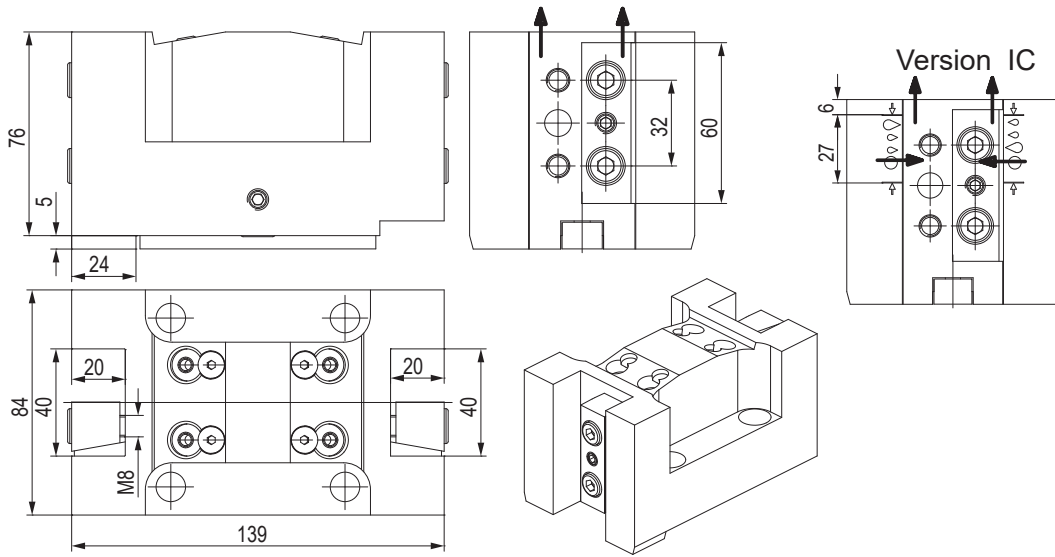

CODE N.	INTERNAL COOLANT	CLAMPING PLATE	KEY	SCREW FOR KEY	COOLANT BALL	SCREW FOR BALL	O RING
128-41527	NO	832-007030	814-203230	811-101016	833-001410	811-108024	823-101015
128-41527-IC	YES	832-007030	814-203230	811-101016	833-001410	811-108024	823-101015

## PORTAUTENSILE RADIALE - RADIAL TOOLHOLDERS

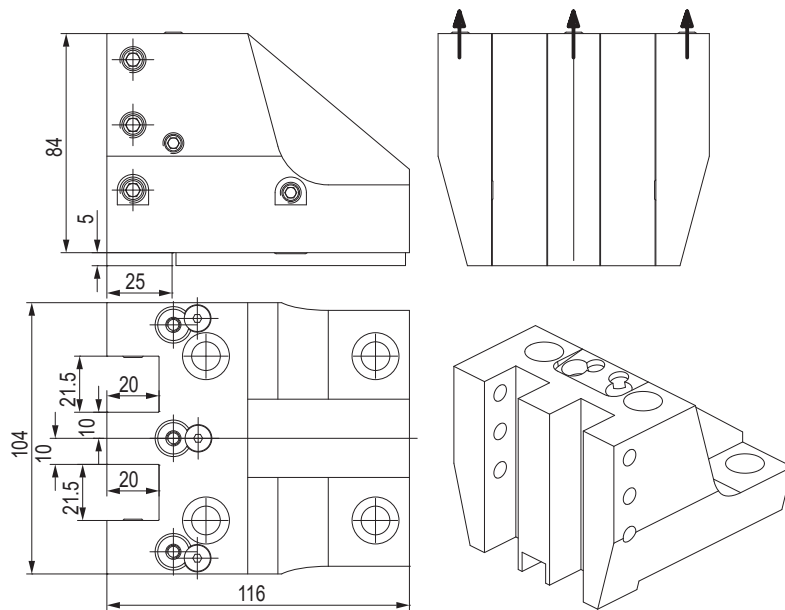

CODE N.	CLAMPING SCREW1 (M10X20)	CLAMPING SCREW2 (M10X16)	KEY	SCREW FOR KEY	COOLANT BALL	SCREW FOR BALL	O RING
128-41526	811-102038	811-102037	814-203230	811-101016	833-001410	811-108024	823-101015

## PORTAUTENSILE ASSIALE - AXIAL TOOLHOLDERS

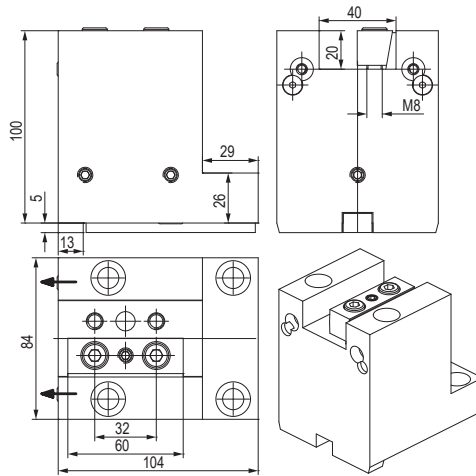

CODE N.	CLAMPING PLATE	KEY	SCREW FOR KEY	COOLANT BALL	SCREW FOR BALL	O RING
128-31515	832-007030	814-203230	811-101016	833-001410	811-108024	823-101015

## PORTALAMA - CUT-OFF HOLDERS

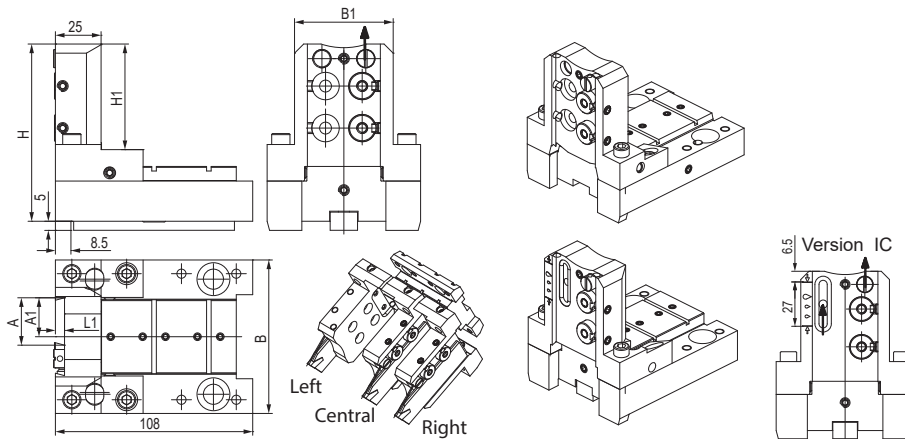

CODE N.	INTERNAL COOLANT	A	A1	L1	B	B1	H	H1
128-11566	NO	26	21.4	5	84	54	97	58
128-11566-IC	YES	26	21.4	5	84	54	97	58
128-11567	NO	32	25	6	94	63	105	66
128-11567-IC	YES	32	25	6	94	63	105	66

CODE N.	KEY	SCREW FOR KEY	COOLANT NOZZLE	O RING FOR COOLANT NOZZLE	O RING FOR INT. COOLANT	O RING FOR BODY	O RING FOR COOLANT INTAKE
128-11566	814-203230	811-101015	833-001490	823-101058	-	823-101061	823-101015
128-11566-IC	814-203230	811-101015	833-001490	823-101058	823-201140	823-101061	823-101015
128-11567	814-203230	811-101015	833-001490	823-101058	-	823-101061	823-101015
128-11567-IC	814-203230	811-101015	833-001490	823-101058	823-201140	823-101061	823-101015

CODE N.	SHIM PLATE	SCREW FOR PLATE	CLAMPING PIN	SPRING	CLAMPING SCREW	SCREW
128-11566	832-014448	811-108037	832-014447	824-300012	811-101028	811-104013
128-11566-IC	832-014448	811-108037	832-014447	824-300012	811-101028	811-104013
128-11567	832-014448	811-108037	832-014450	824-300012	811-101029	811-104013
128-11567-IC	832-014448	811-108037	832-014450	824-300012	811-101029	811-104013

## PORTAUTENSILE PER BARENI - TOOLHOLDER FOR BORING BAR

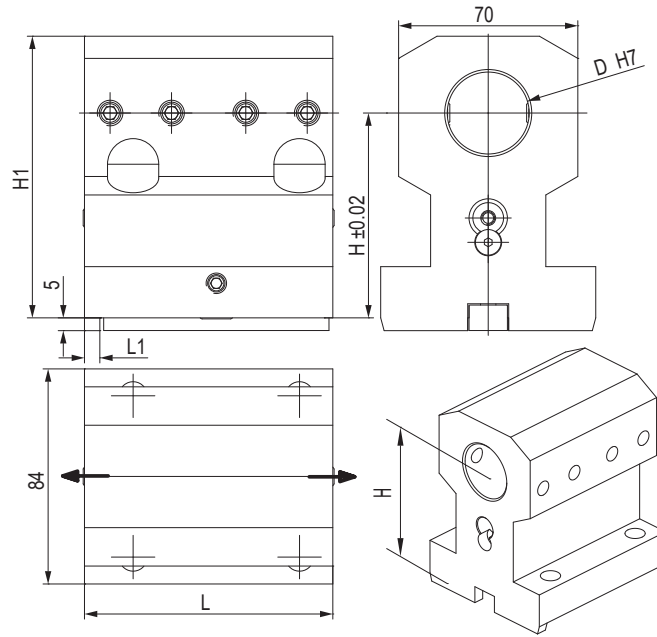

CODE N.	D	H	H1	L	L1	CLAMPING SCREW	KEY	SCREW FOR KEY	COOLANT BALL	SCREW FOR BALL	O RING
128-21538	32	80	110	97	6	811-102038	814-203230	811-101016	833-001410	811-108024	823-101015
128-21540	32	100	130	97	6	811-102038	814-203230	811-101016	833-001410	811-108024	823-101015
128-21548	40	80	110	106	15	811-102037	814-203230	811-101016	833-001410	811-108024	823-101015

## PORTAUTENSILE COMBINATO PER BARENI E PUNTE A INSERTI COMBI TOOLHOLDER FOR BORING BAR AND INSERT DRILL

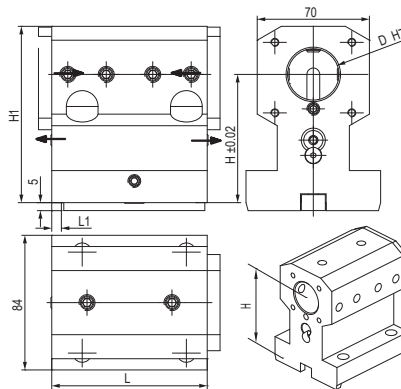

CODE N.	D	H	H1	L	L1	CLAMPING SCREW1 (D32 M10X20) (D40 M10X16)	CLAMPING SCREW2 (D32 M10X16) (D40 M10X12)	KEY	SCREW FOR KEY
128-21539	32	80	110	97	6	811-102038	811-102037	814-203230	811-101016
128-21541	32	100	130	97	6	811-102038	811-102037	814-203230	811-101016
128-21549	40	80	110	106	15	811-102037	811-102036	814-203230	811-101016

CODE N.	COOLANT BALL	SCREW FOR BALL	COVER	SCREW FOR COVER	O RING
128-21539	833-001410	811-108024	832-003363	811-101016	823-101015
128-21541	833-001410	811-108024	832-003363	811-101016	823-101015
128-21549	833-001410	811-108024	832-003363	811-101016	823-101015

## PORTAUTENSILE PER BARENI - TOOLHOLDER FOR BORING BAR

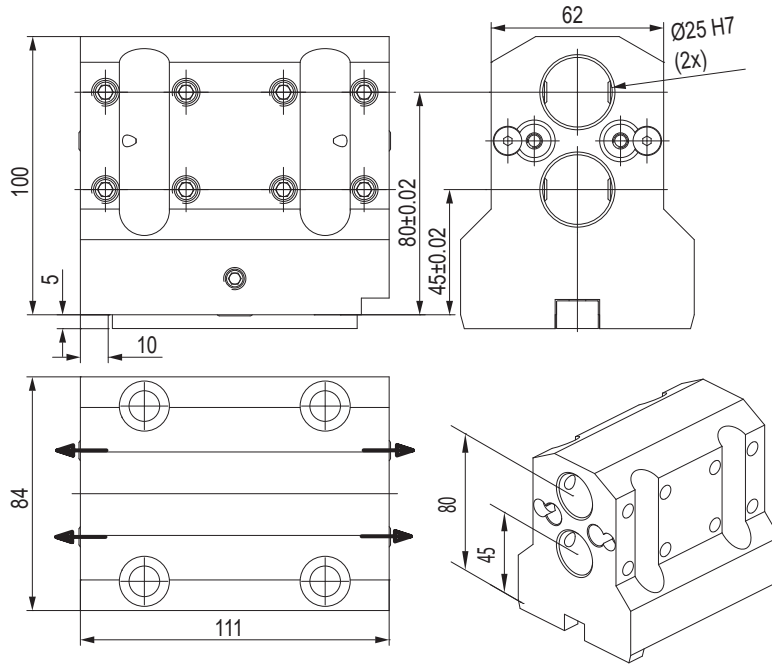

CODE N.	CLAMPING SCREW	KEY	SCREW FOR KEY	COOLANT BALL	SCREW FOR BALL	O RING
128-21542	811-102038	814-203230	811-101016	833-001410	811-108024	823-101015

## PORTAUTENSILE CON USCITA POLIGONALE POLIGONAL TOOLHOLDERS

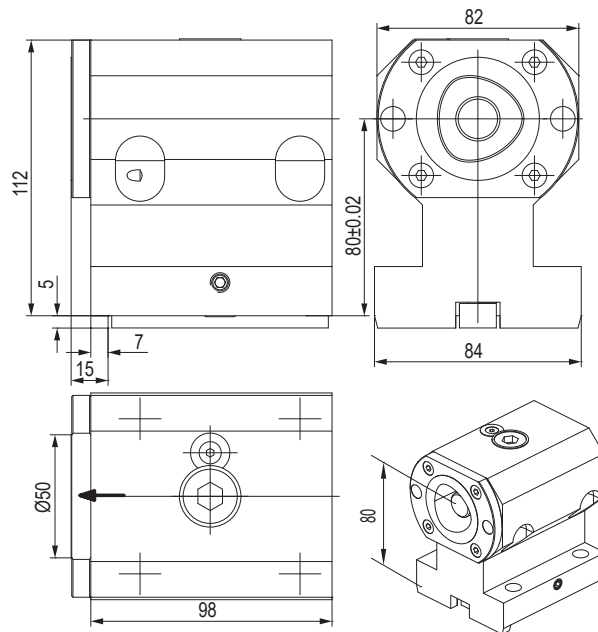

CODE N.	CAPTO	CLAMPING UNIT	KEY	SCREW FOR KEY	O RING
128-11579	C50	CXC50-10	814-203230	811-101016	823-101015

## PORTAUTENSILE CON USCITA POLIGONALE POLIGONAL TOOLHOLDERS

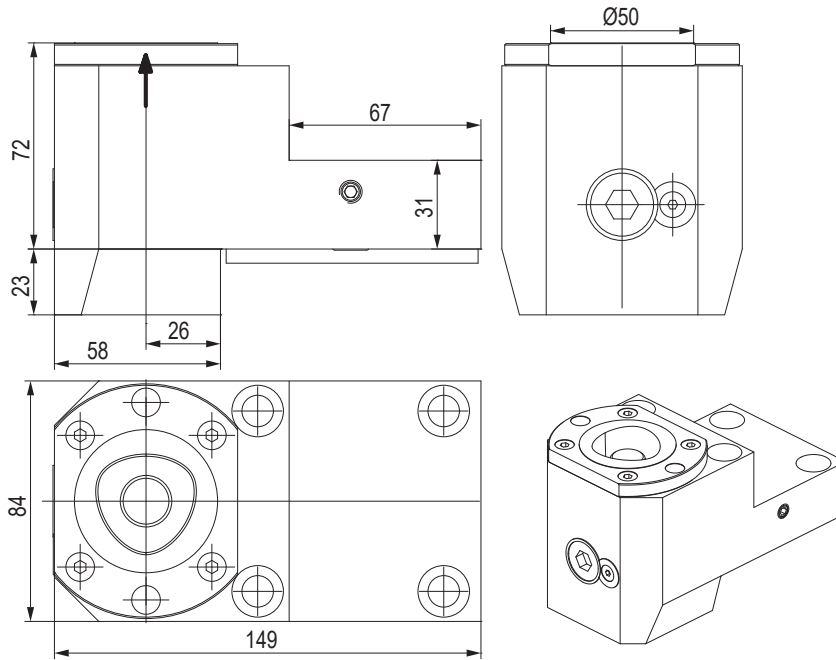

CODE N.	CAPTO	CLAMPING UNIT	KEY	SCREW FOR KEY	O RING
128-11580	C50	CXC50-10	814-203230	811-101016	823-101015

## PORTAUTENSILE MOTORIZZATO ASSIALE STRAIGHT DRILLING AND MILLING HEAD

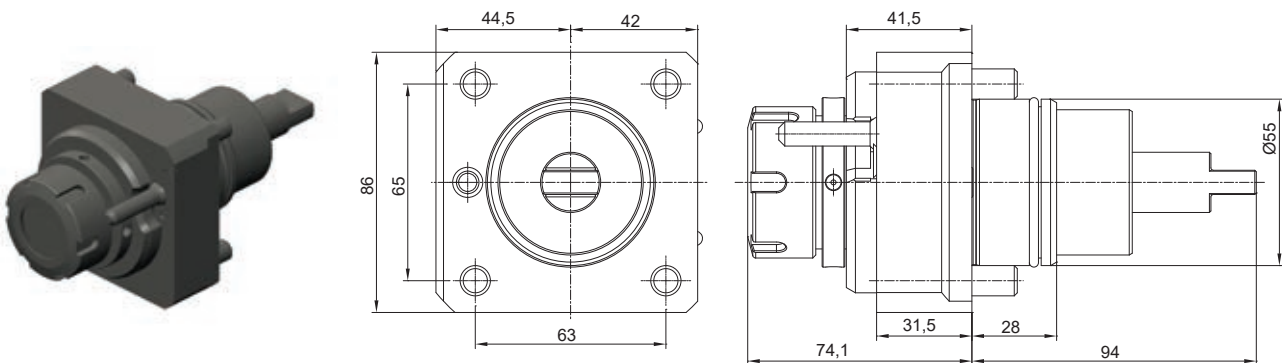

CODE N.	ER	MAX SPEED (Rpm)	I	Max. Torque (Nm)	INTERNAL COOLING	P Bar
124-05521	ER32	6000	1:1	50	no	-
124-05522	ER32	6000	1:1	50	yes	20



## PORTAUTENSILE MOTORIZZATO RADIALE ANGULAR DRILLING AND MILLING HEAD

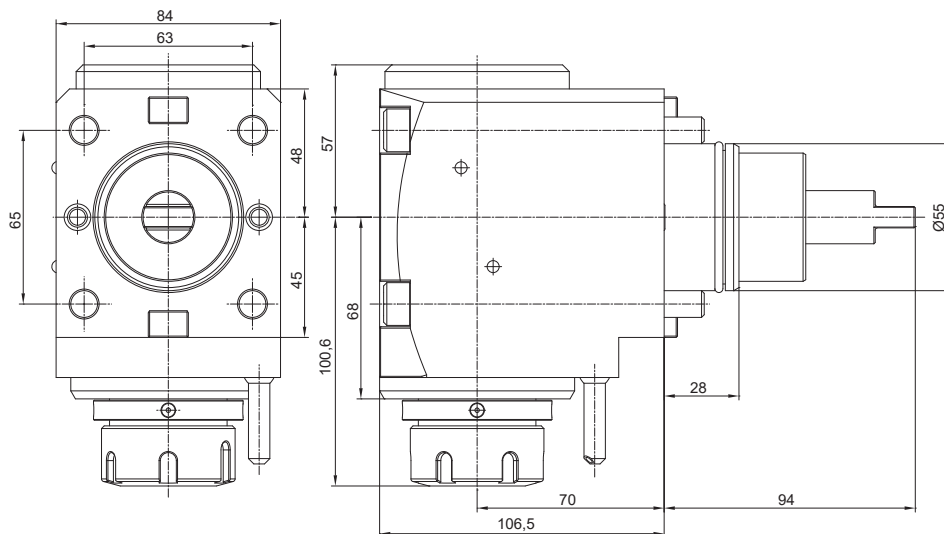

CODE N.	ER	MAX SPEED (Rpm)	I	Max. Torque (Nm)	INTERNAL COOLING	P Bar
124-05523	ER32	6000	1:1	50	no	-
124-05524	ER32	6000	1:1	50	yes	20
124-05525	ER32	6000	1:1	50	yes	80
124-05526	ER25	6000	1:1	50	yes	80

## BARRA DI CONTROLLO - CONTROL PIN

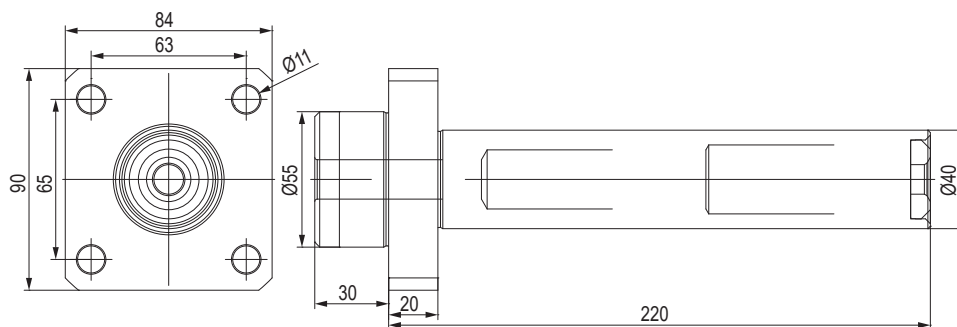
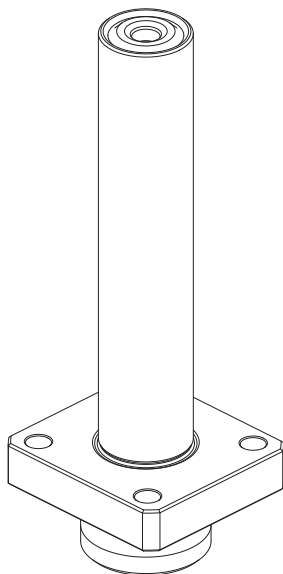

CODE N.

137-00209

## TAPPO DI PROTEZIONE - PROTECTION COVER

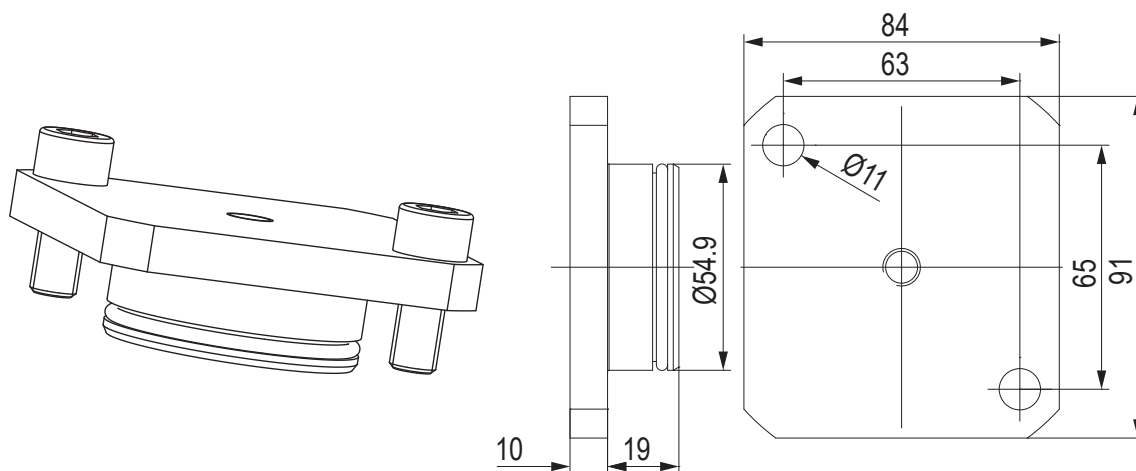

CODE N.	O RING
137-00244	823-101064



## BUSSOLA PER PORTABARENI DRILL SOCKET FOR TOOLHOLDER

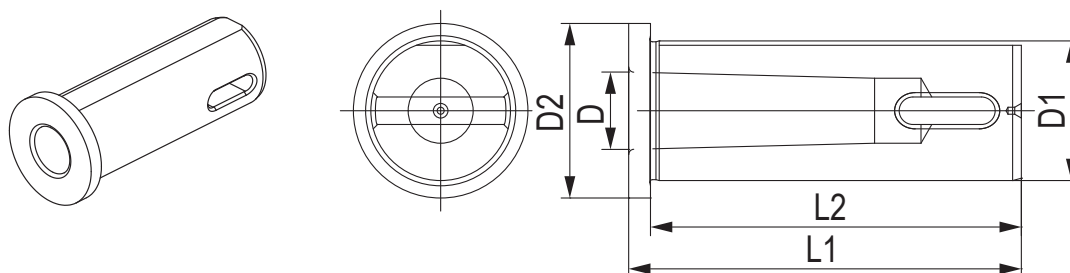

CODE N.	Ø	MORSE	D	D1	D2	L1	L2
114-33208	32	1	12,065	32	40	90	85
114-33209	32	2	17,780	32	40	90	85
114-34008	40	2	17,780	40	50	110	105
114-34009	40	3	23,825	40	50	110	105

## BUSSOLA PER PORTABARENI BORING BAR SLEEVE FOR TOOLHOLDER

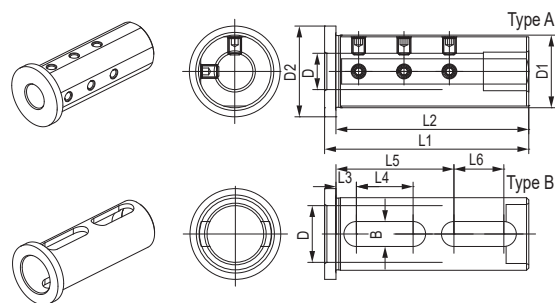

CODE N.	D1	D	D2	L1	L2	L3	L4	L5	L6	B	TYPE	SCREW
115-63260	32	8	40	90	85	-	-	-	-	-	A	811-10219
115-63261	32	10	40	90	85	-	-	-	-	-	A	811-10219
115-63211	32	12	40	90	85	-	-	-	-	-	A	811-10218
115-63212	32	16	40	90	85	-	-	-	-	-	A	811-10218
115-63213	32	20	40	90	85	-	-	-	-	-	A	811-10217
115-63214	32	25	40	90	85	9	25	52	22	11	B	-
115-64043	40	8	50	110	105	-	-	-	-	-	A	811-10221
115-64044	40	10	50	110	105	-	-	-	-	-	A	811-10220
115-64045	40	12	50	110	105	-	-	-	-	-	A	811-10220
115-64046	40	16	50	110	105	-	-	-	-	-	A	811-10228
115-64047	40	20	50	110	105	-	-	-	-	-	A	811-10227
115-64048	40	25	50	110	105	-	-	-	-	-	A	811-10226
115-64049	40	32	50	110	105	10	35	65	28	13	B	-

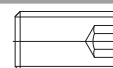

## BUSSOLA PER PORTABARENI BORING BAR SLEEVE FOR TOOLHOLDER

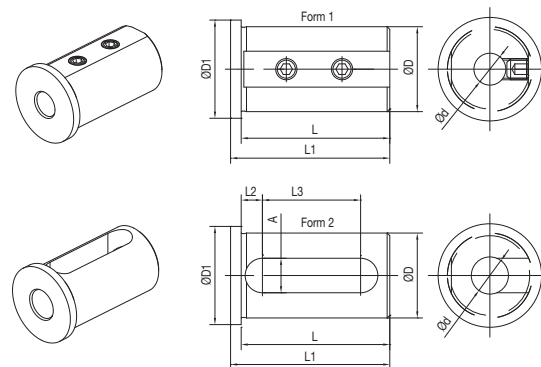

CODE N.	D	d	FORM	L	L1	L2	L3	A	D1
165-63352	32	8	1	56	60	-	-	-	37
165-63353	32	10	1	56	60	-	-	-	37
165-63354	32	12	1	56	60	-	-	-	37
165-63356	32	16	2	56	60	8	37	13	37
165-63358	32	20	2	56	60	8	37	13	37
165-63359	32	25	2	56	60	8	37	13	37
165-64247	40	8	1	71	75	-	-	-	45
165-64248	40	10	1	71	75	-	-	-	45
165-64249	40	12	1	71	75	-	-	-	45
165-64251	40	16	2	71	75	8	52	13	45
165-64253	40	20	2	71	75	8	52	13	45
165-64254	40	25	2	71	75	8	52	13	45
165-64255	40	32	2	71	75	8	52	13	45

## BUSSOLA PER PORTABARENI BORING BAR SLEEVE FOR TOOLHOLDER

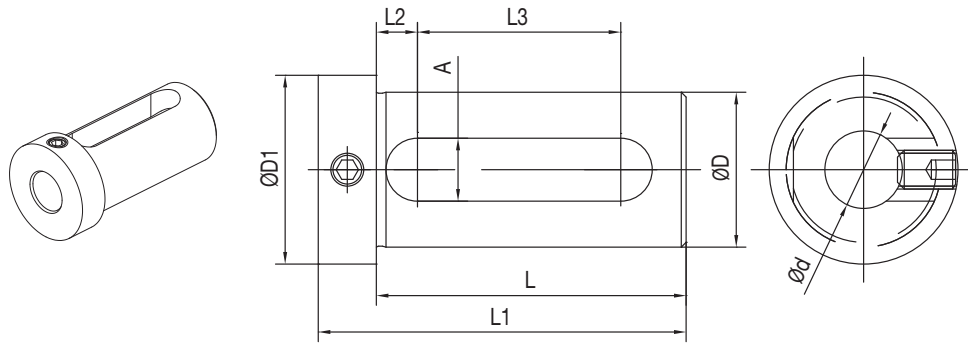

CODE N.	D	d	L	L1	L2	L3	A	D1	SCREW
165-63347	32	16	64	76	8,5	42	13	39	811-102028
165-63349	32	20	64	76	8,5	42	13	39	811-102027
165-63350	32	25	64	76	8,5	42	13	39	811-102027
165-64241	40	16	74	88	9	51	14	48	811-102038
165-64243	40	20	74	88	9	51	14	48	811-102038
165-64244	40	25	74	88	9	51	14	48	811-102037
165-64245	40	32	74	88	9	51	14	48	811-102037

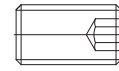

## BUSSOLA PER PORTABARENI BORING BAR SLEEVE FOR TOOLHOLDER

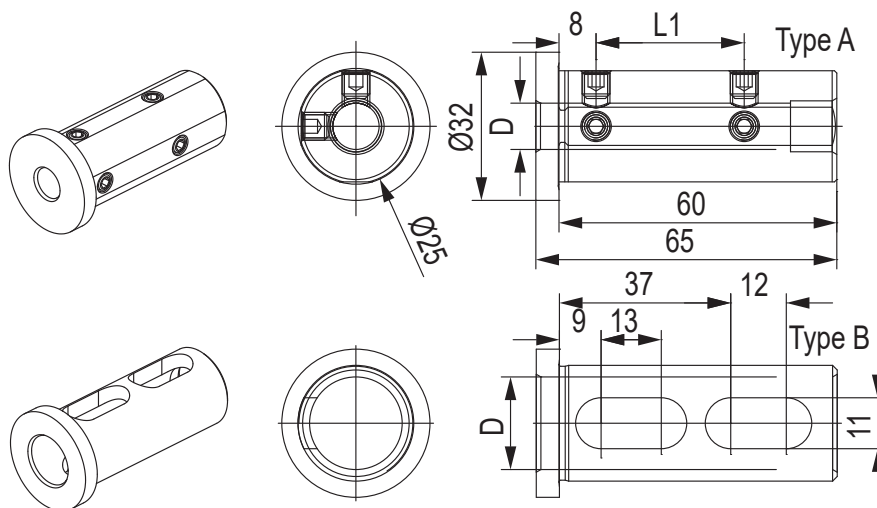

CODE N.	Ø	D	L1	TYPE	SCREW
115-62573	25	6	22	A	811-102011
115-62538	25	8	27	A	811-102018
115-62539	25	10	32	A	811-102017
115-62540	25	12	32	A	811-102017
115-62541	25	16	-	B	-

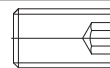

# KINTEK®



NEW PRODUCTION PLANT  
A.M.T S.R.L. - CASELLE T.SE - TORINO - ITALY



HEAD OFFICE  
KINTEK S.R.L. - MAPPANO - TORINO - ITALY



MAIN PRODUCTION PLANT  
KINTEK TOOLING KFT - BEKESCSABA - HUNGARY

## **KINTEK s.r.l.**

Via Goretta 88/G - 10079 MAPPANO - (TO) - ITALY  
Tel. +39 011 99 68 065 - Fax +39 011 99 65 662  
e-mail: [info@kintek.it](mailto:info@kintek.it)  
<http://www.kintek.it>