

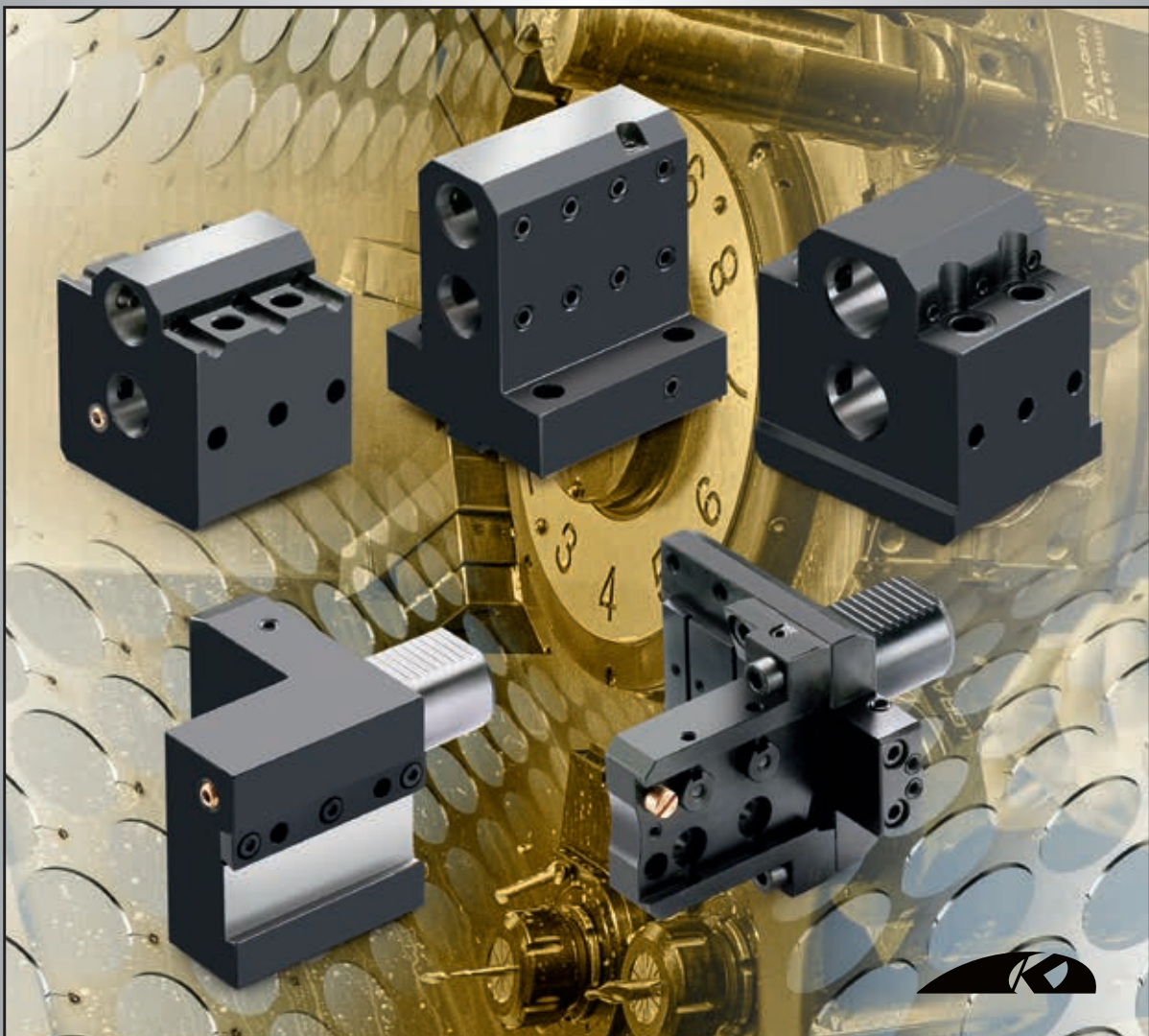

KINTEK®

COMPONENTI INNOVATIVI TECNOMECCANICI



TOOLHOLDERS FOR CNC LATHES
GOODWAY

DMG MORI
(BMT60)

NLX1500 (12 stazioni) - NLX2000
 NLX2500 - NLX3000 - NLX4000
 NL2000 (S)MC - 2500 (S)MC
 NL3000MC (12 STATIONS)
 NT3250 - NT4200 - NT4250
 NT4300 - NT5400 - NZL2500
 NT4000 - NT5000
 NZL 2000/2500
 NZX 2500 (station turret)
 NTX 2000/2500/3000
 2ND GEN. 10ST. - (TX2500 BMT60)

GOODWAY

G4/G5 200
 2600/280
 3000/3300
 3600
 GS2000 SERIES
 GS3000 SERIES
 GS4000 SERIES

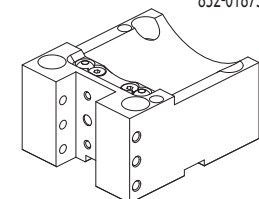
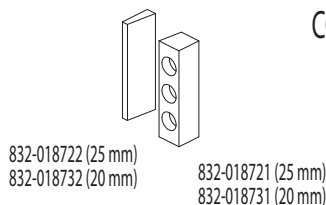

KMS-T00186 (25x25 mm)
 KMS-T00187 (20x20 mm)

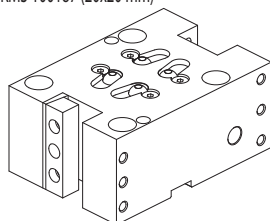

KMS-T00184 (25x25 mm)
 KMS-T00185 (20x20 mm)

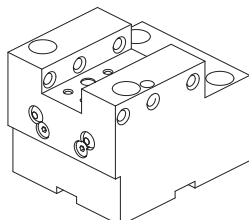

KMS-T03005 (25x25 mm)
 KMS-T03006 (20x20 mm)

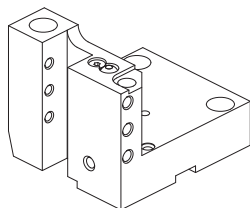

KMS-T00197 (25x25 mm)

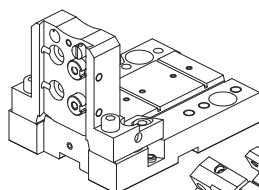

137-00092 (32 mm)

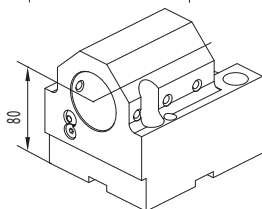
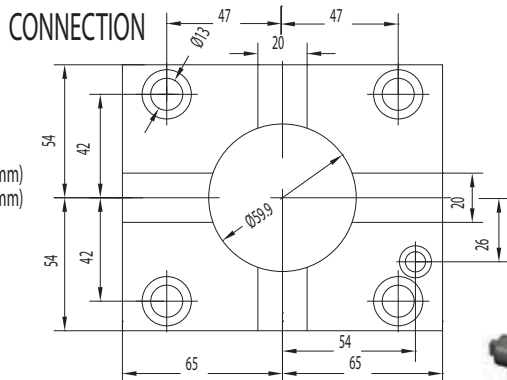
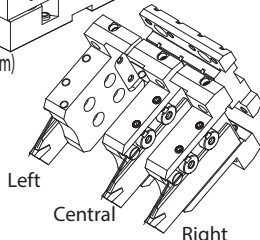

KMS-T10097 (Ø40 mm)
 KMS-T10098 (Ø50 mm)

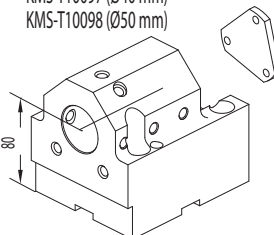

KMS-T13128 (Ø40 mm)
 with internal coolant

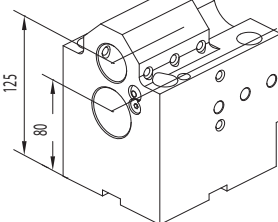

KMS-T10096 (Ø32 mm)

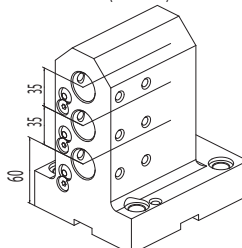

KMS-T10104 (Ø25 mm)

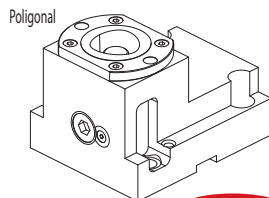

137-00241 (C40)
 137-00187 (C50)

NEWS

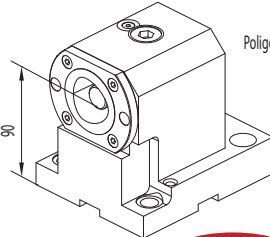

137-00242 (C40)
 137-00183 (C50)

NEWS

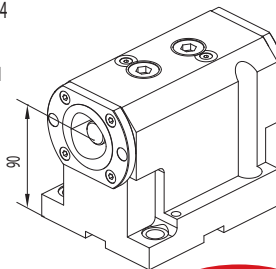

137-00243 (C40)
 137-00185 (C50)

NEWS



124-06001
 124-06003 i.Coolant



124-06002
 124-06004 i.Coolant
 124-06015 i.Coolant 80 BAR

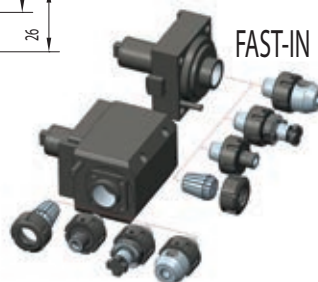

124-06003
 124-06004

ACCESSORIES

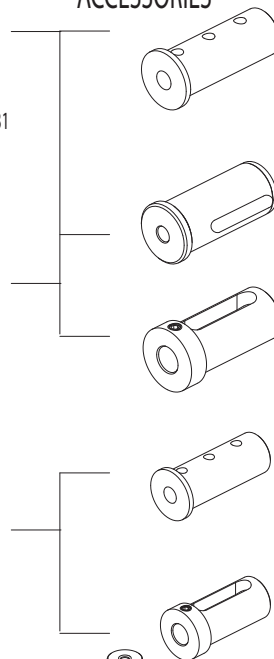

KMS-T20098 (Ø32 mm)
 KMS-T20096 (Ø25 mm)
 KMS-T20094 (Ø20 mm)
 KMS-T20092 (Ø16 mm)
 KMS-T20090 (Ø12 mm)
 KMS-T20088 (Ø10 mm)
 KMS-T20086 (Ø8 mm)

KMS-T22042 (MT3)
 KMS-T22046 (MT2)

165-64241 (Ø16 mm)
 165-64243 (Ø20 mm)
 165-64244 (Ø25 mm)
 165-64245 (Ø32 mm)

KMS-T20122 (Ø25 mm)
 KMS-T20120 (Ø20 mm)
 KMS-T20118 (Ø16 mm)
 KMS-T20116 (Ø12 mm)
 KMS-T20114 (Ø10 mm)
 KMS-T20112 (Ø8 mm)

165-63347 (Ø16 mm)
 165-63349 (Ø20 mm)
 165-63350 (Ø25 mm)

Protection cover
 137-00246

Control pin
 137-00194

CONNECTION

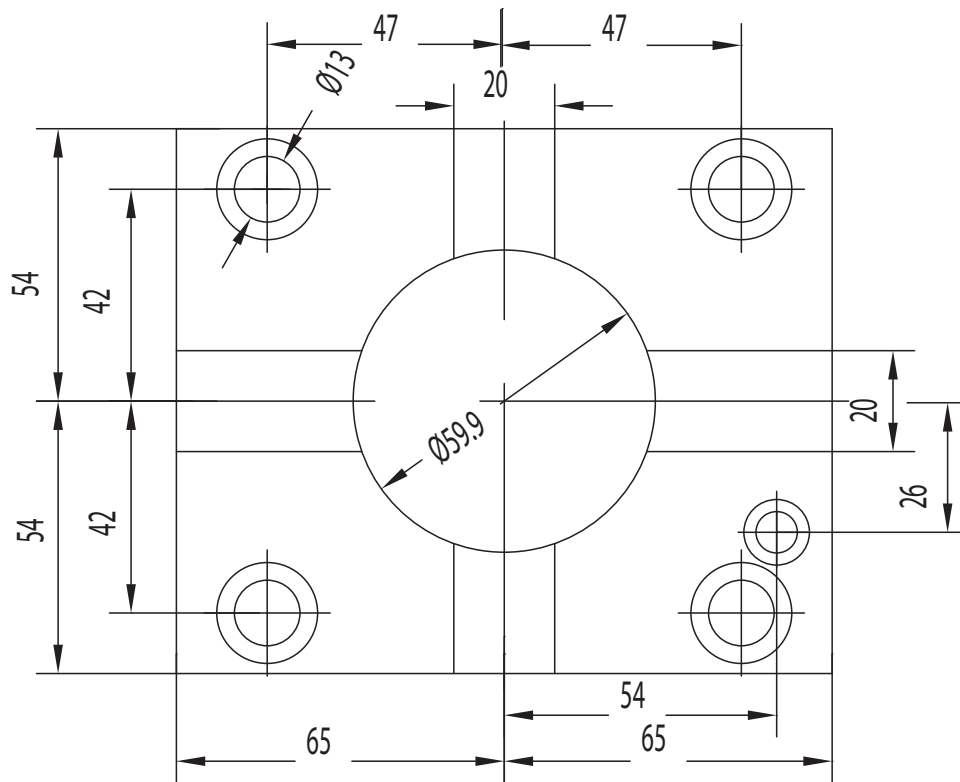

PORTAUTENSILE RADIALE - RADIAL TOOLHOLDERS

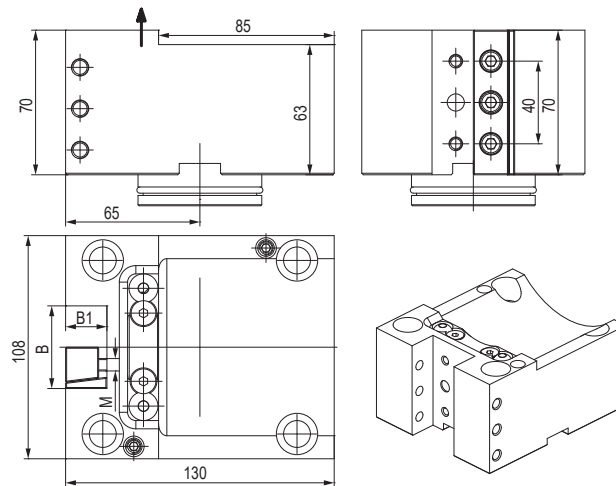

| CODE N. | B | B1 | M | CLAMPING PLATE | CLAMPING SCREW | SCREW FOR DISASSEMBLE | COOLANT BALL | SCREW FOR BALL |
|------------|----|----|----|----------------|----------------|-----------------------|--------------|----------------|
| KMS-T00186 | 50 | 25 | M8 | | | | | |
| KMS-T00187 | 40 | 20 | M6 | | | | | |

| CODE N. | CENTRAL PIN | SCREW FOR PIN | O RING FOR PIN (54X3) | O RING FOR PIN (44.5X3) | O RING FOR COOLANT (9.25X1.78) |
|------------|-------------|---------------|-----------------------|-------------------------|--------------------------------|
| KMS-T00186 | | | | | |
| KMS-T00187 | | | | | |

PORTAUTENSILE RADIALE - RADIAL TOOLHOLDERS

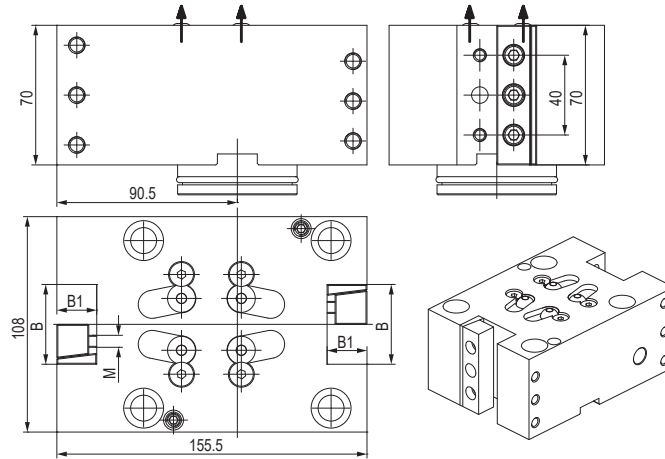

| CODE N. | B | B1 | M | CLAMPING PLATE | CLAMPING SCREW | SCREW FOR DISASSEMBLE | COOLANT BALL | SCREW FOR BALL |
|------------|----|----|----|----------------|----------------|-----------------------|--------------|----------------|
| | | | | | | | | |
| KMS-T00184 | 50 | 25 | M8 | 832-018720 | 811-104021 | 811-102102 | 833-001470 | 811-108018 |
| KMS-T00185 | 40 | 20 | M6 | 832-018730 | 811-104021 | 811-102102 | 833-001470 | 811-108018 |

| CODE N. | CENTRAL PIN | SCREW FOR PIN | O RING FOR PIN (54X3) | O RING FOR PIN (44.5X3) | O RING FOR COOLANT (9.25X1.78) |
|------------|-------------|---------------|-----------------------|-------------------------|--------------------------------|
| | | | | | |
| KMS-T00184 | 832-018741 | 811-101041 | 823-101077 | 823-101069 | 823-101076 |
| KMS-T00185 | 832-018741 | 811-101041 | 823-101077 | 823-101069 | 823-101076 |

PORTAUTENSILE ASSIALE - AXIAL TOOLHOLDERS

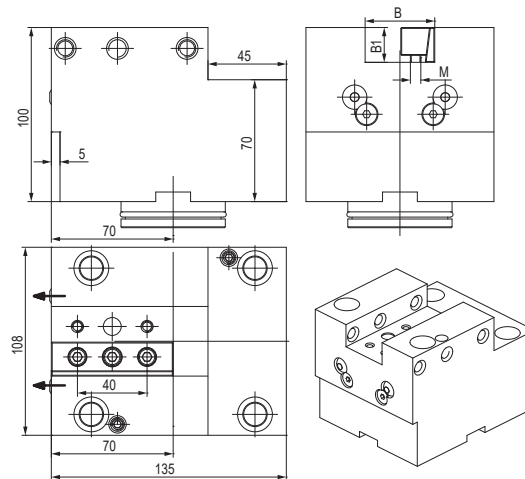

| CODE N. | B | B1 | M | CLAMPING PLATE | CLAMPING SCREW | SCREW FOR DISASSEMBLE | COOLANT BALL | SCREW FOR BALL |
|------------|----|----|----|----------------|----------------|-----------------------|--------------|----------------|
| | | | | | | | | |
| KMS-T03005 | 50 | 25 | M8 | 832-018720 | 811-104030 | 811-102102 | 833-001470 | 811-108018 |
| KMS-T03006 | 40 | 20 | M6 | 832-018730 | 811-104030 | 811-102102 | 833-001470 | 811-108018 |

| CODE N. | CENTRAL PIN | SCREW FOR PIN | O RING FOR PIN (54X3) | O RING FOR PIN (44.5X3) | O RING FOR COOLANT (9.25X1.78) |
|------------|-------------|---------------|-----------------------|-------------------------|--------------------------------|
| | | | | | |
| KMS-T03005 | 832-018741 | 811-101041 | 823-101077 | 823-101069 | 823-101076 |
| KMS-T03006 | 832-018741 | 811-101041 | 823-101077 | 823-101069 | 823-101076 |

PORTALAMA - CUT-OFF TOOLHOLDERS

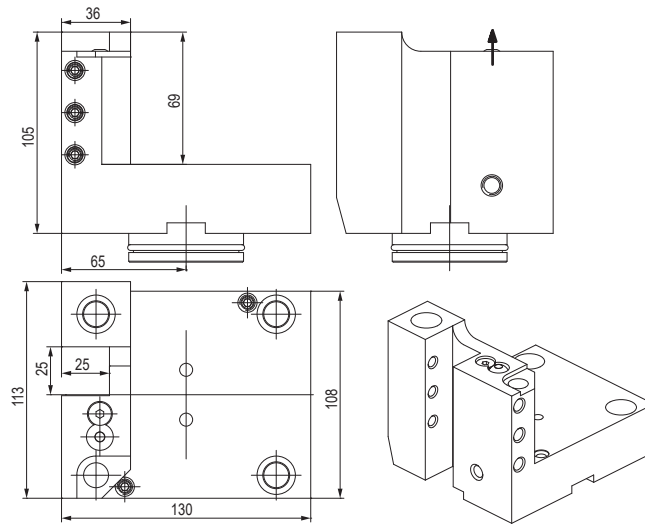

| CODE N. | CLAMPING SCREW | SCREW FOR DISASSEMBLE | COOLANT BALL | SCREW FOR BALL |
|------------|----------------|-----------------------|--------------|----------------|
| KMS-T00197 | 811-104021 | 811-102032 | 833-001470 | 811-108018 |

| CODE N. | CENTRAL PIN | SCREW FOR PIN | O RING FOR PIN (54X3) | O RING FOR PIN (44.5X3) | O RING FOR COOLANT (9.25X1.78) |
|------------|-------------|---------------|-----------------------|-------------------------|--------------------------------|
| KMS-T00197 | 832-018741 | 811-101041 | 823-101077 | 823-101069 | 823-101076 |

PORTALAMA - CUT-OFF TOOLHOLDERS

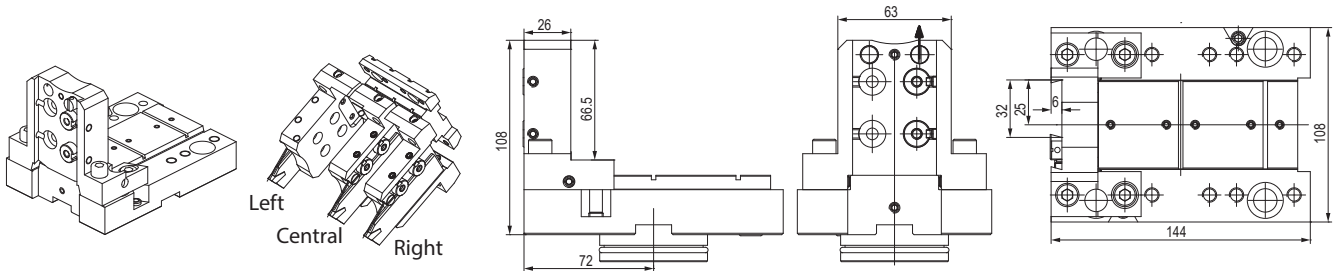

| CODE N. | SCREW FOR DISASSEMBLE | COOLANT NOZZLE | O RING FOR COOLANT NOZZLE | O RING FOR BODY |
|-----------|-----------------------|----------------|---------------------------|-----------------|
| 137-00092 | 811-102028 | 833-001490 | 823-101058 | 823-101061 |



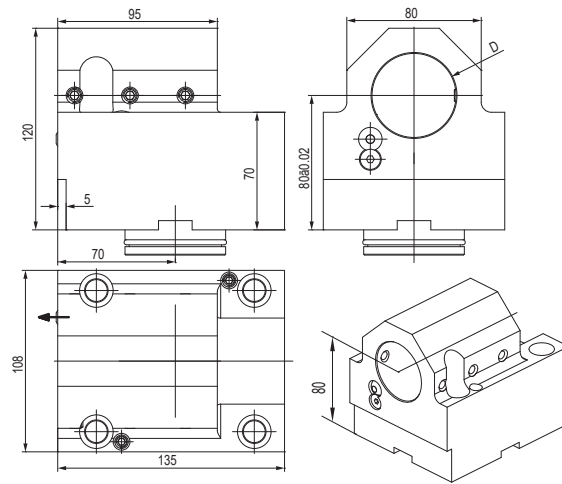

| CODE N. | SHIM PLATE | SCREW FOR PLATE | CLAMPING PIN | SPRING | CLAMPING SCREW | SCREW |
|-----------|------------|-----------------|--------------|------------|----------------|------------|
| 137-00092 | 832-014449 | 811-108037 | 832-014450 | 824-300012 | 811-101028 | 811-104013 |

| CODE N. | CENTRAL PIN | SCREW FOR PIN | O RING FOR PIN (54.5X3) | O RING FOR PIN (44.5X3) | O RING FOR COOLANT (9X2) |
|-----------|-------------|---------------|-------------------------|-------------------------|--------------------------|
| 137-00092 | 832-018741 | 811-101041 | 823-101070 | 823-101069 | 823-101015 |

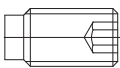
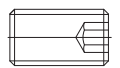
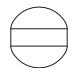
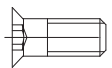
PORTAUTENSILE PER BARENI - TOOLHOLDER FOR BORING BAR

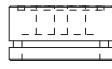
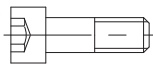



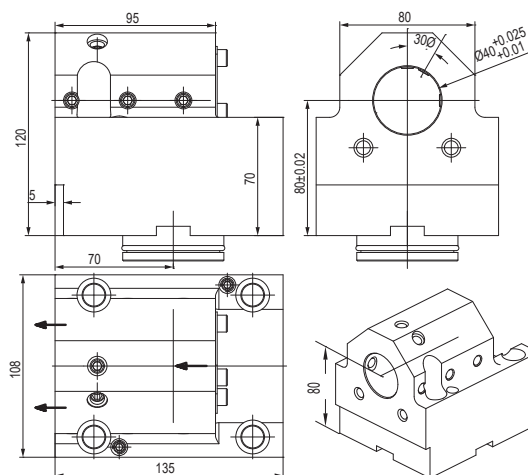

| CODE N. | D | CLAMPING SCREW | SCREW FOR DISASSEMBLE | COOLANT BALL | SCREW FOR BALL |
|------------|----|-----------------------------------------------------------------------------------|-----------------------------------------------------------------------------------|-------------------------------------------------------------------------------------|-------------------------------------------------------------------------------------|
| | |  |  |  |  |
| KMS-T10097 | 40 | 811-104028 | 811-102102 | 833-001470 | 811-108018 |
| KMS-T10098 | 50 | 811-104028 | 811-102102 | 833-001470 | 811-108018 |

| CODE N. | CENTRAL PIN | SCREW FOR PIN | O RING FOR PIN (54X3) | O RING FOR PIN (44.5X3) | O RING FOR COOLANT (9.25X1.78) |
|------------|------------------------------------------------------------------------------------|------------------------------------------------------------------------------------|------------------------------------------------------------------------------------|--------------------------------------------------------------------------------------|--------------------------------------------------------------------------------------|
| |  |  |  |  |  |
| KMS-T10097 | 832-018741 | 811-101041 | 823-101077 | 823-101069 | 823-101076 |
| KMS-T10098 | 832-018741 | 811-101041 | 823-101077 | 823-101069 | 823-101076 |

PORTAUTENSILE COMBINATO PER BARENI E PUNTE A INSERTI COMBI TOOLHOLDER FOR BORING BAR AND INSERT DRILL

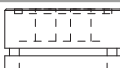
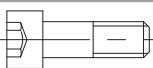

| CODE N. | CLAMPING SCREW | SCREW FOR DISASSEMBLE | COVER F70031 | SCREW FOR COVER |
|------------|-------------------------------------------------------------------------------------|-------------------------------------------------------------------------------------|--------------------------------------------------------------------------------------|---------------------------------------------------------------------------------------|
| |  |  |  |  |
| KMS-T13128 | 811-104028 | 811-102032 | 832-003229 | 811-101028 |

| CODE N. | CENTRAL PIN | SCREW FOR PIN | O RING FOR PIN (54X3) | O RING FOR PIN (44.5X3) | O RING FOR COOLANT (9.25X1.78) |
|------------|-------------------------------------------------------------------------------------|-------------------------------------------------------------------------------------|-------------------------------------------------------------------------------------|---------------------------------------------------------------------------------------|---------------------------------------------------------------------------------------|
| |  |  |  |  |  |
| KMS-T13128 | 832-018741 | 811-101041 | 823-101077 | 823-101069 | 823-101076 |

PORTAUTENSILE DOPPIO PER BARENI DOUBLE TOOLHOLDER FOR BORING BAR

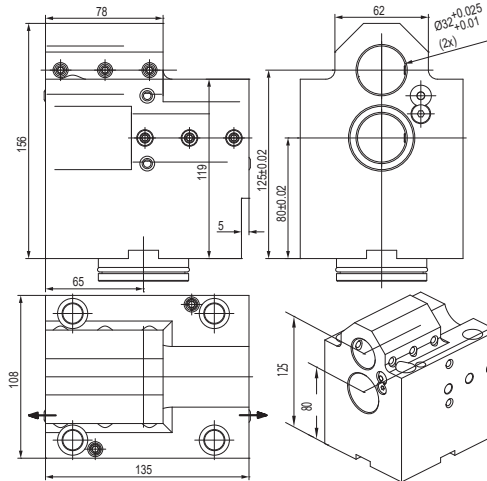

| CODE N. | CLAMPING SCREW | SCREW FOR DISASSEMBLE | COOLANT BALL | SCREW FOR BALL |
|------------|----------------|-----------------------|--------------|----------------|
| KMS-T10096 | 811-104021 | 811-102102 | 833-001470 | 811-108018 |

| CODE N. | CENTRAL PIN | SCREW FOR PIN | O RING FOR PIN (54X3) | O RING FOR PIN (44.5X3) | O RING FOR COOLANT (9.25X1.78) |
|------------|-------------|---------------|-----------------------|-------------------------|--------------------------------|
| KMS-T10096 | 832-018741 | 811-101041 | 823-101077 | 823-101069 | 823-101076 |

PORTAUTENSILE TRIPLO PER BARENI TOOLHOLDER FOR BORING BAR

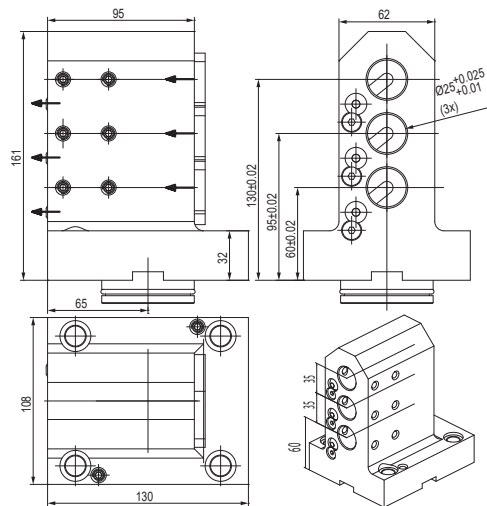

| CODE N. | CLAMPING SCREW | SCREW FOR DISASSEMBLE | COVER T10104-2 | COOLANT BALL | SCREW FOR BALL AND COVER |
|------------|----------------|-----------------------|----------------|--------------|--------------------------|
| KMS-T10104 | 811-104021 | 811-102032 | 832-003241 | 833-001470 | 811-108018 |

| CODE N. | CENTRAL PIN | SCREW FOR PIN | O RING FOR PIN (54X3) | O RING FOR PIN (44.5X3) | O RING FOR COOLANT (9.25X1.78) |
|------------|-------------|---------------|-----------------------|-------------------------|--------------------------------|
| KMS-T10104 | 832-018741 | 811-101041 | 823-101077 | 823-101069 | 823-101076 |

PORTAUTENSILE CON USCITA POLIGONALE POLIGONAL TOOLHOLDERS

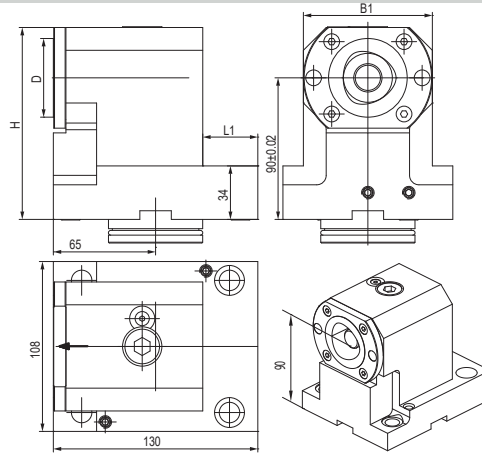

| CODE N. | CAPTO | D | H | L1 | B1 | CLAMPING UNIT | SCREW FOR DISASSEMBLE |
|---------|-------|---|---|----|----|---------------|-----------------------|
|---------|-------|---|---|----|----|---------------|-----------------------|

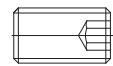

| | | | | | | | |
|-----------|-----|----|-----|----|----|----------|------------|
| 137-00242 | C40 | 40 | 114 | 45 | 67 | CXC40-10 | 811-102032 |
| 137-00183 | C50 | 50 | 122 | 35 | 82 | CXC50-10 | 811-102032 |

| CODE N. | CENTRAL PIN | SCREW FOR PIN | O RING FOR PIN (54X3) | O RING FOR PIN (44.5X3) | O RING FOR COOLANT (9.25X1.78) |
|---------|-------------|---------------|-----------------------|-------------------------|--------------------------------|
|---------|-------------|---------------|-----------------------|-------------------------|--------------------------------|

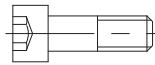

| | | | | | |
|-----------|------------|------------|------------|------------|------------|
| 137-00242 | 832-018741 | 811-101041 | 823-101077 | 823-101069 | 823-101076 |
| 137-00183 | 832-018741 | 811-101041 | 823-101077 | 823-101069 | 823-101076 |

PORTAUTENSILE CON USCITA POLIGONALE POLIGONAL TOOLHOLDERS

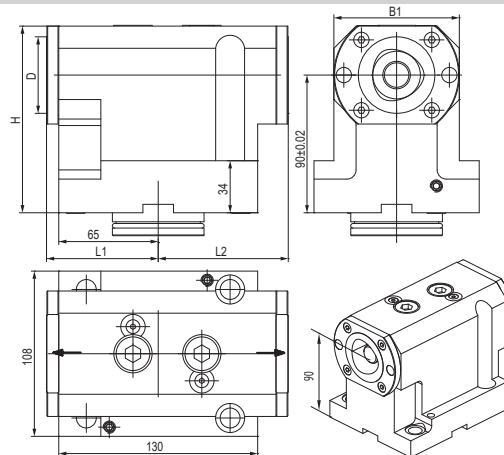

| CODE N. | CAPTO | D | D | H | L1 | B1 | CLAMPING UNIT | SCREW FOR DISASSEMBLE |
|---------|-------|---|---|---|----|----|---------------|-----------------------|
|---------|-------|---|---|---|----|----|---------------|-----------------------|

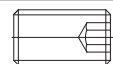

| | | | | | | | | |
|-----------|-----|----|-----|----|----|----|----------|------------|
| 137-00243 | C40 | 40 | 114 | 71 | 71 | 67 | CXC40-10 | 811-102032 |
| 137-00185 | C50 | 50 | 122 | 73 | 85 | 82 | CXC50-10 | 811-102032 |

| CODE N. | CENTRAL PIN | SCREW FOR PIN | O RING FOR PIN (54X3) | O RING FOR PIN (44.5X3) | O RING FOR COOLANT (9.25X1.78) |
|---------|-------------|---------------|-----------------------|-------------------------|--------------------------------|
|---------|-------------|---------------|-----------------------|-------------------------|--------------------------------|

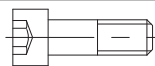

| | | | | | |
|-----------|------------|------------|------------|------------|------------|
| 137-00243 | 832-018741 | 811-101041 | 823-101077 | 823-101069 | 823-101076 |
| 137-00185 | 832-018741 | 811-101041 | 823-101077 | 823-101069 | 823-101076 |

PORTAUTENSILE CON USCITA POLIGONALE POLIGONAL TOOLHOLDERS

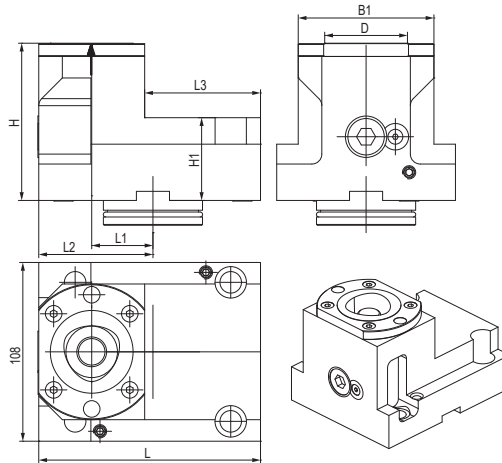

| CODE N. | CAPTO | D | H | H1 | L | L1 | L2 | L3 | B1 | CLAMPING UNIT | SCREW FOR DISASSEMBLE |
|-----------|-------|----|----|----|-----|----|----|----|----|---------------|-----------------------|
| 137-00241 | C40 | 40 | 80 | 42 | 130 | 41 | 65 | 82 | 67 | CXC40-10 | 811-102032 |
| 137-00187 | C50 | 50 | 95 | 50 | 134 | 37 | 69 | 70 | 82 | CXC50-10 | 811-102032 |

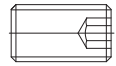

| CODE N. | CENTRAL PIN | SCREW FOR PIN | O RING FOR PIN (54X3) | O RING FOR PIN (44.5X3) | O RING FOR COOLANT (9.25X1.78) |
|-----------|-------------|---------------|-----------------------|-------------------------|--------------------------------|
| 137-00241 | 832-018741 | 811-101041 | 823-101077 | 823-101069 | 823-101076 |
| 137-00187 | 832-018741 | 811-101041 | 823-101077 | 823-101069 | 823-101076 |

PORTAUTENSILE MOTORIZZATO ASSIALE STRAIGHT DRILLING AND MILLING HEAD

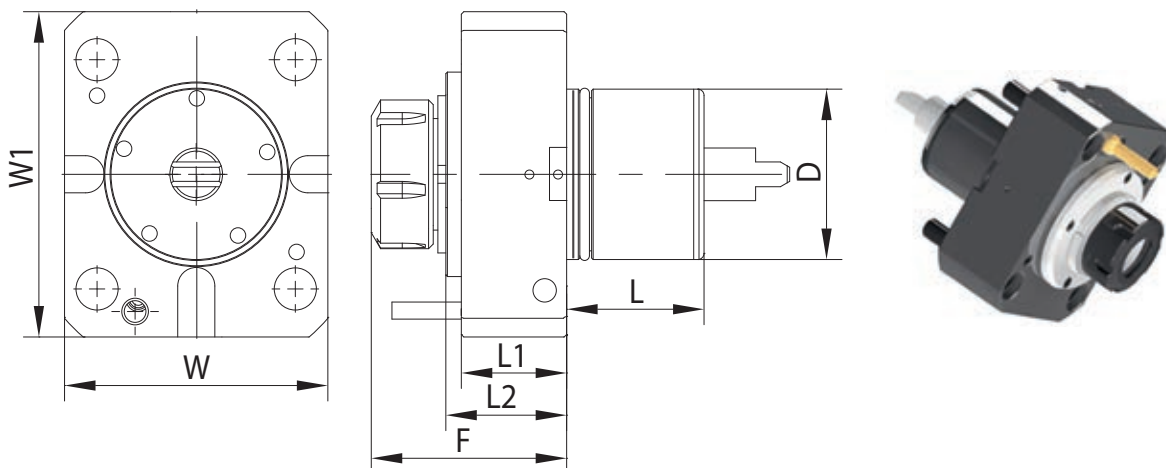

| CODE N. | ER | D | F | L | L1 | L2 | W | W1 | MAX. TORQUE (Nm) | NMAX (Rpm) | I | INTERNAL COOLING | P Bar |
|-----------|------|----|----|----|------|----|-----|-----|------------------|------------|-----|------------------|-------|
| 124-06001 | ER32 | 60 | 89 | 53 | 48.5 | 58 | 108 | 130 | 70 | 6000 | 1:1 | no | - |
| 124-06003 | ER32 | 60 | 89 | 53 | 48.5 | 58 | 108 | 130 | 70 | 6000 | 1:1 | yes | 20 |

PORTAUTENSILE MOTORIZZATO RADIALE ANGULAR DRILLING AND MILLING HEAD

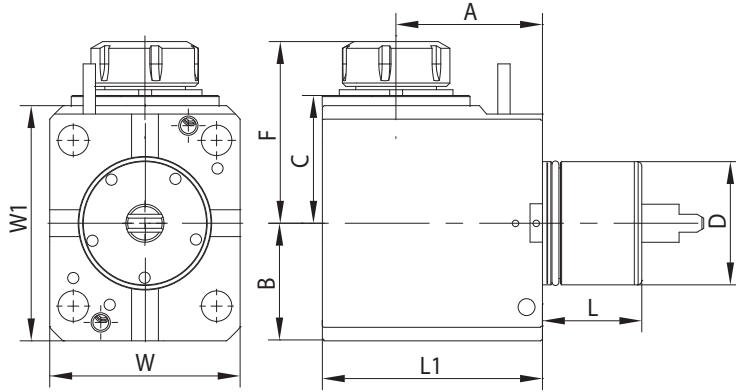

| CODE N. | ER | D | F | L | L1 | A | B | C | W | W1 | MAX. TORQUE (Nm) | NMAX (Rpm) | I | INTERNAL COOLING | P Bar |
|-----------|------|----|-----|----|-----|----|----|----|-----|-----|------------------|------------|-----|------------------|-------|
| 124-06002 | ER32 | 60 | 107 | 53 | 128 | 90 | 65 | 78 | 108 | 130 | 70 | 6000 | 1:1 | no | - |
| 124-06004 | ER32 | 60 | 107 | 53 | 128 | 90 | 65 | 78 | 108 | 130 | 70 | 6000 | 1:1 | yes | 20 |
| 124-06015 | ER32 | 60 | 107 | 53 | 128 | 90 | 65 | 78 | 108 | 130 | 70 | 6000 | 1:1 | yes | 80 |

PORTAUTENSILE MOTORIZZATO RADIALE DOPPIO DOUBLE ANGULAR DRILLING AND MILLING HEAD

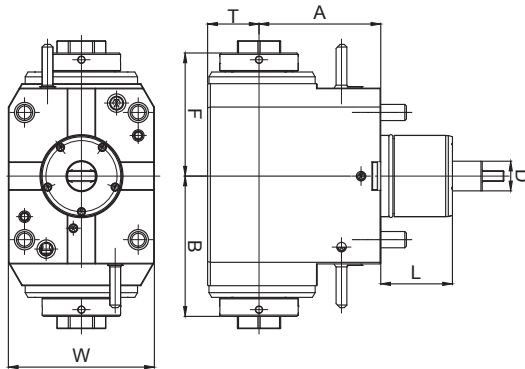

| CODE N. | D | ER | INTERNAL COOLING | DIRECTION | A | B | F | T | W | L | TORQUE (Nm) | Nmax (rpm) | RATIO | P (bar) |
|-----------|----|----|------------------|------------|----|-------|----|----|-----|----|-------------|------------|-------|---------|
| 124-06603 | 60 | 32 | no | right/left | 90 | 103.8 | 91 | 38 | 108 | 53 | 70 | 6000 | 1:1 | - |
| 124-06604 | 60 | 32 | yes | right/left | 90 | 103.8 | 91 | 38 | 108 | 53 | 70 | 6000 | 1:1 | 20 |

BARRA DI CONTROLLO - CONTROL PIN

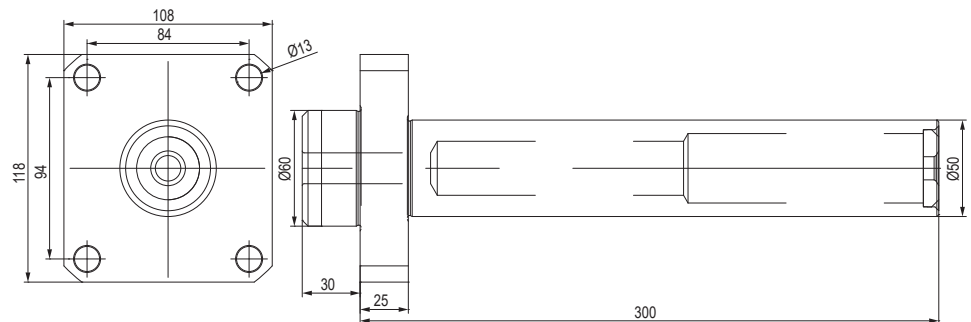
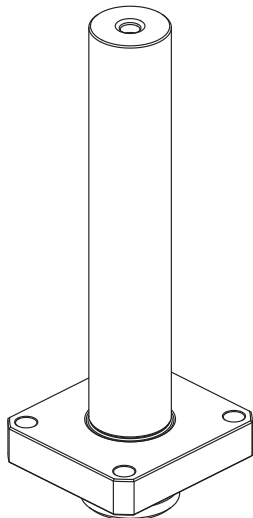

CODE N.

137-00194

TAPPO DI PROTEZIONE - PROTECTION COVER

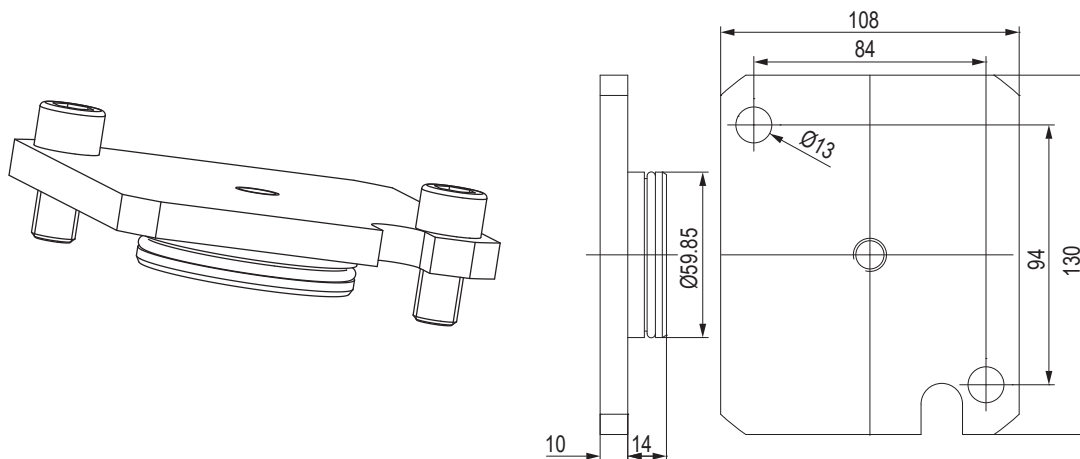

| CODE N. | O RING |
|-----------|------------|
| 137-00246 | 823-101077 |



BUSSOLA PER PORTABARENI BORING BAR SLEEVE FOR TOOLHOLDER

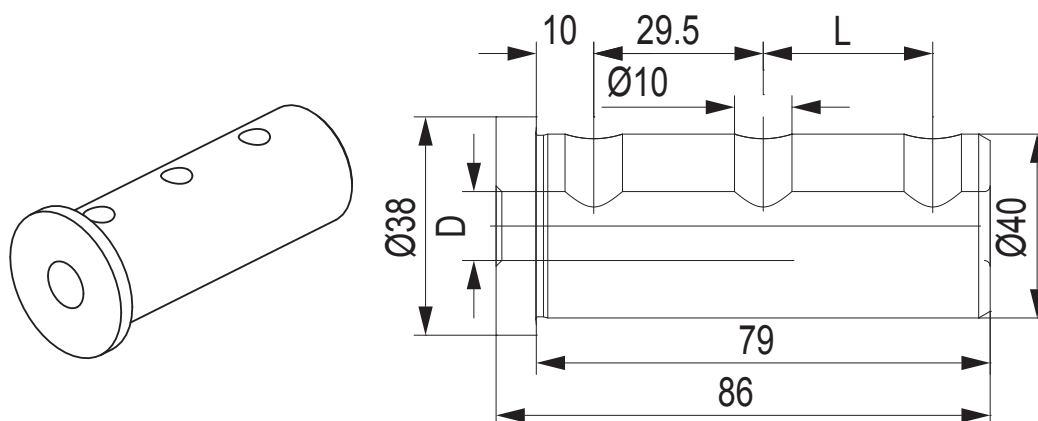

| CODE N. | D | L | TYPE | SCREW |
|------------|----|----|------|------------|
| KMS-T20098 | 32 | 33 | B | - |
| KMS-T20096 | 25 | 33 | B | 811-102017 |
| KMS-T20094 | 20 | 33 | A | 811-102017 |
| KMS-T20092 | 16 | 33 | A | 811-102017 |
| KMS-T20090 | 12 | - | A | 811-102017 |
| KMS-T20088 | 10 | - | A | 811-102017 |
| KMS-T20086 | 8 | - | A | 811-102017 |



BUSSOLA PER PORTABARENI DRILL SOCKET FOR TOOLHOLDER

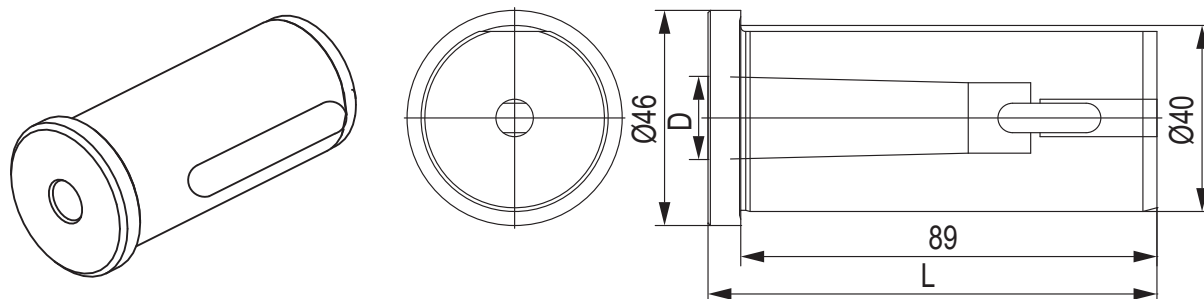

| CODE N. | MORSE | D | H |
|------------|-------|--------|-----|
| KMS-T22042 | 3 | 23.825 | 108 |
| KMS-T22046 | 2 | 17.78 | 96 |

BUSSOLA PER PORTABARENI BORING BAR SLEEVE FOR TOOLHOLDER

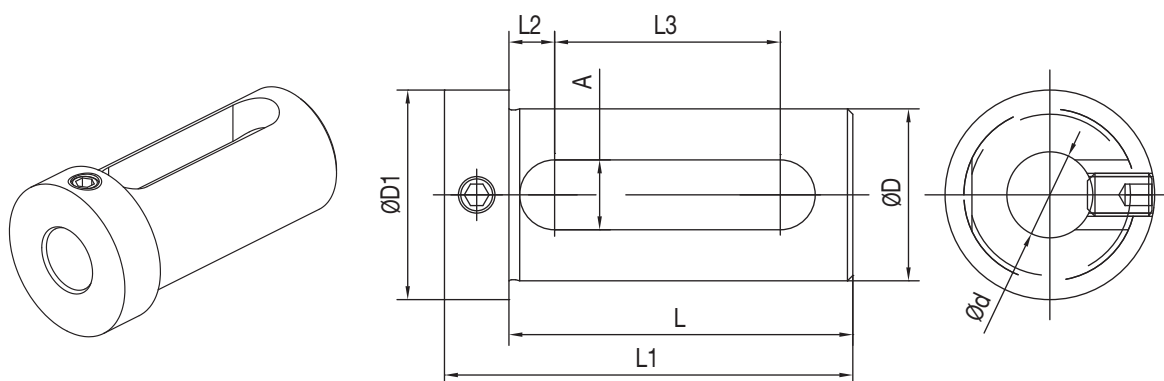

| CODE N. | D | d | L | L1 | L2 | L3 | A | D1 |
|-----------|----|----|----|----|----|----|----|----|
| 165-64241 | 40 | 16 | 74 | 88 | 9 | 51 | 14 | 48 |
| 165-64243 | 40 | 20 | 74 | 88 | 9 | 51 | 14 | 48 |
| 165-64244 | 40 | 25 | 74 | 88 | 9 | 51 | 14 | 48 |
| 165-64245 | 40 | 32 | 74 | 88 | 9 | 51 | 14 | 48 |

BUSSOLA PER PORTABARENI BORING BAR SLEEVE FOR TOOLHOLDER

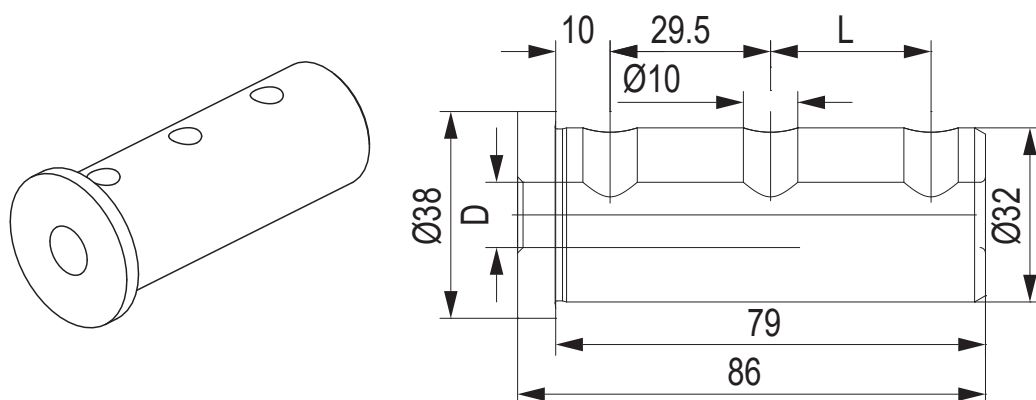

| CODE N. | D | L | TYPE |
|------------|----|------|------|
| KMS-T20122 | 25 | 29.5 | B |
| KMS-T20120 | 20 | 29.5 | B |
| KMS-T20118 | 16 | 29.5 | A |
| KMS-T20116 | 12 | 29.5 | A |
| KMS-T20114 | 10 | - | A |
| KMS-T20112 | 8 | - | A |

BUSSOLA PER PORTABARENI BORING BAR SLEEVE FOR TOOLHOLDER

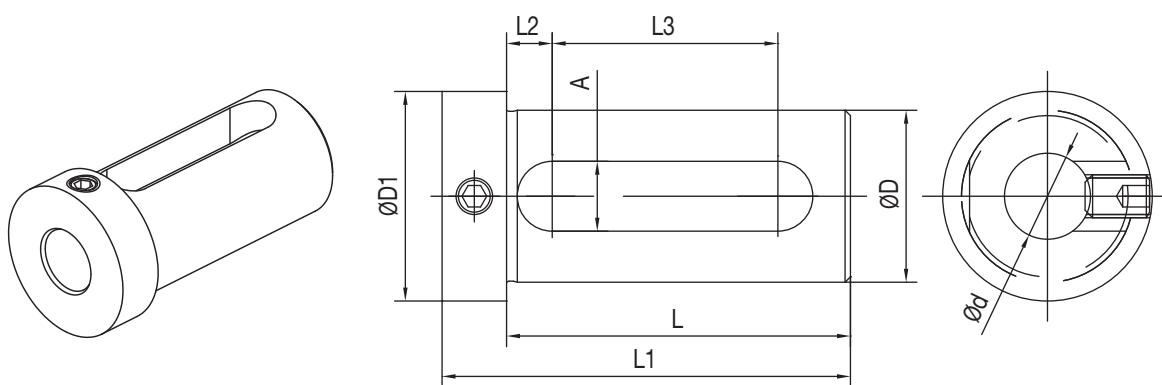

| CODE N. | D | d | L | L1 | L2 | L3 | A | D1 |
|-----------|----|----|----|----|-----|----|----|----|
| 165-63347 | 32 | 16 | 64 | 76 | 8,5 | 42 | 13 | 39 |
| 165-63349 | 32 | 20 | 64 | 76 | 8,5 | 42 | 13 | 39 |
| 165-63350 | 32 | 25 | 64 | 76 | 8,5 | 42 | 13 | 39 |

DMG MORI

CL 200/203
SL 20/25
SL 203/204/250/253
SL 254 (MC, SMC)/2500Y
SL 203MC
SL 253MC
ZL 200MC
ZL 250SMC
SL 204SMC
SL 300MC

CMZ

TBI 520
TL 20/25
TC 15/20/25/30/35
TA 15M/Y/MS/MY/YS
TA 20M/Y/MS/MY/YS
TA 25M/Y/MS/MY/YS
TA 30M/Y/MS/MY/YS
TD 15/20/25/30/35/45
TD 55M/Y/MS/MY/YS

GOODWAY

GS 200/260/280
GA 2000/2600/2800
GA 3000/3300/3600

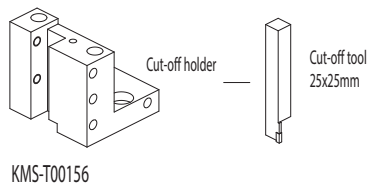
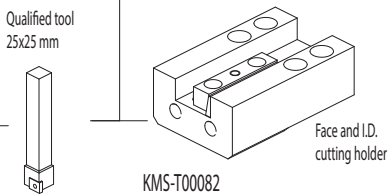
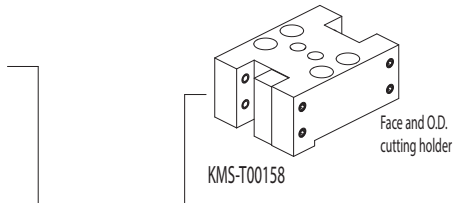
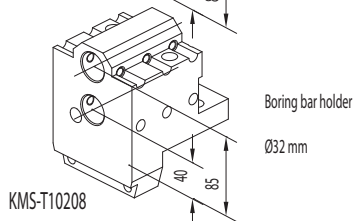
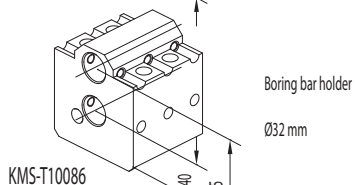
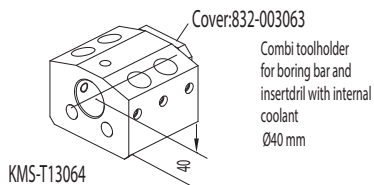
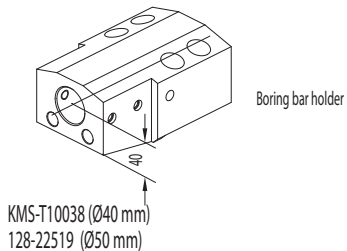
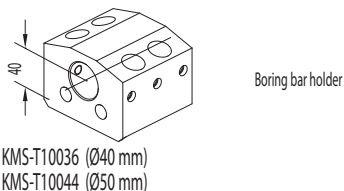
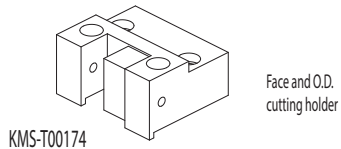
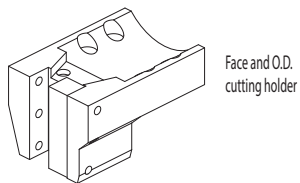
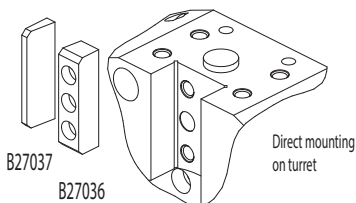

ACCESSORIES

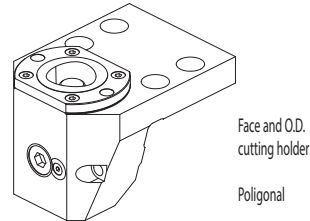
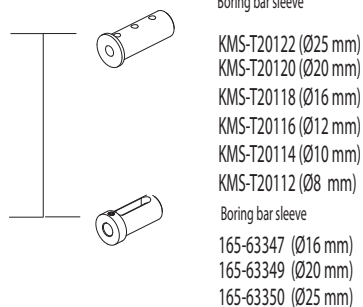
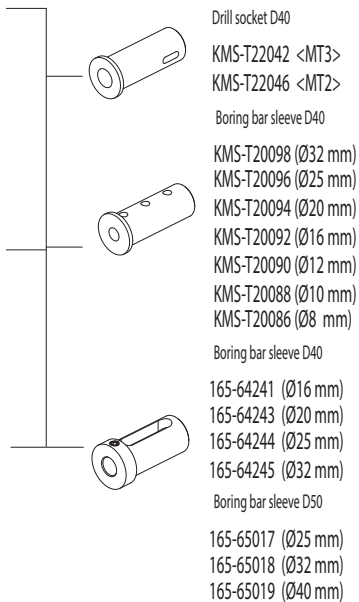

NEWS

Driven tools



CONNECTION

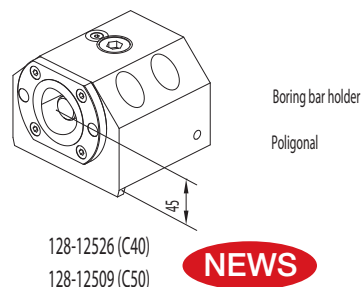
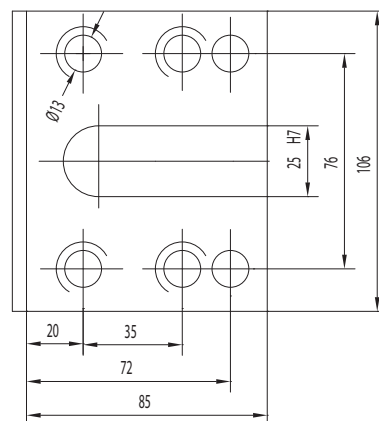

CONNECTION

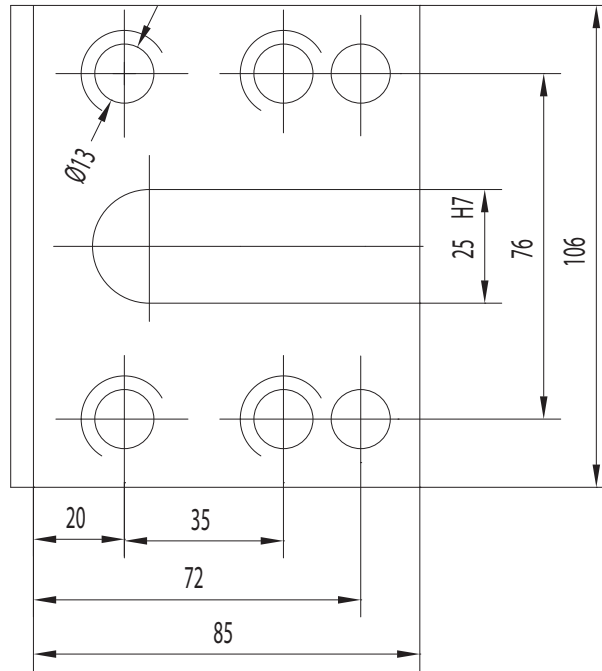

PORTAUTENSILE RADIALE - RADIAL TOOLHOLDERS

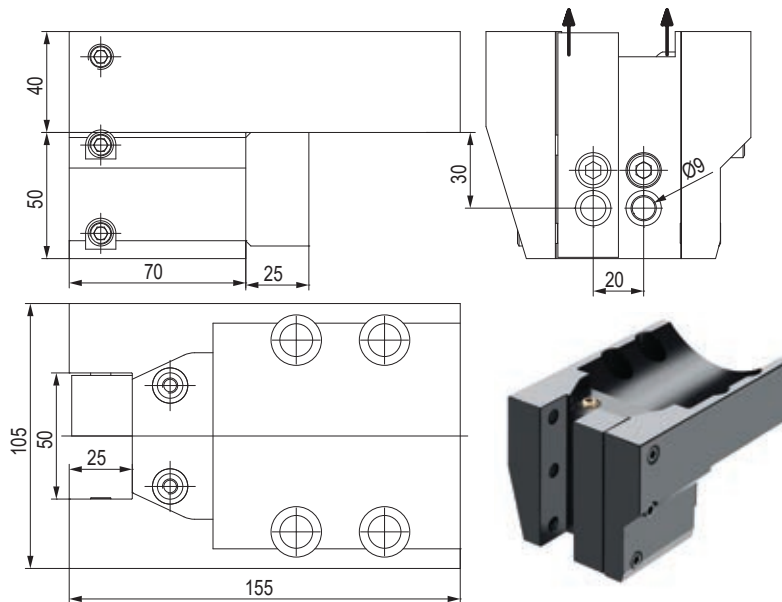

| CODE N. | CLAMPING SCREW1 (M10X25) | CLAMPING SCREW2 (M10X16) | CLAMPING PLATE | COOLANT NOZZLE | SPACER | SCREW FOR SPACER |
|------------|--------------------------|--------------------------|----------------|----------------|------------|------------------|
| KMS-T00076 | 811-104030 | 811-104028 | 832-002117 | 833-001090 | 832-002116 | 811-101046 |

PORTAUTENSILE RADIALE - RADIAL TOOLHOLDERS

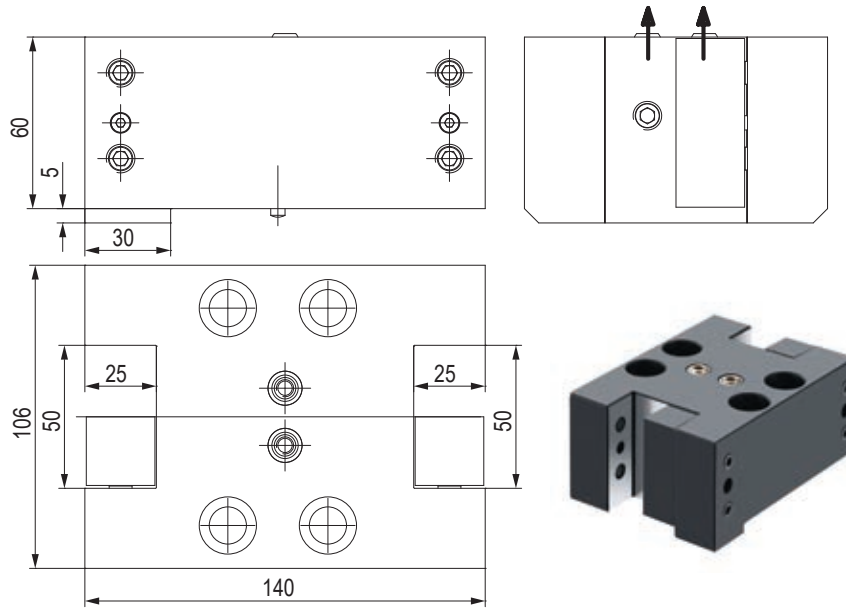

| CODE N. | CLAMPING SCREW | CLAMPING PLATE | SCREW FOR CLAMPING PLATE | SPRING FOR CLAMPING PLATE | COOLANT NOZZLE | PIN |
|------------|----------------|----------------|--------------------------|---------------------------|----------------|------------|
| KMS-T00158 | 811-104030 | 832-002095 | 811-302004 | 824-101010 | 833-001110 | 815-220008 |

PORTAUTENSILE RADIALE - RADIAL TOOLHOLDERS

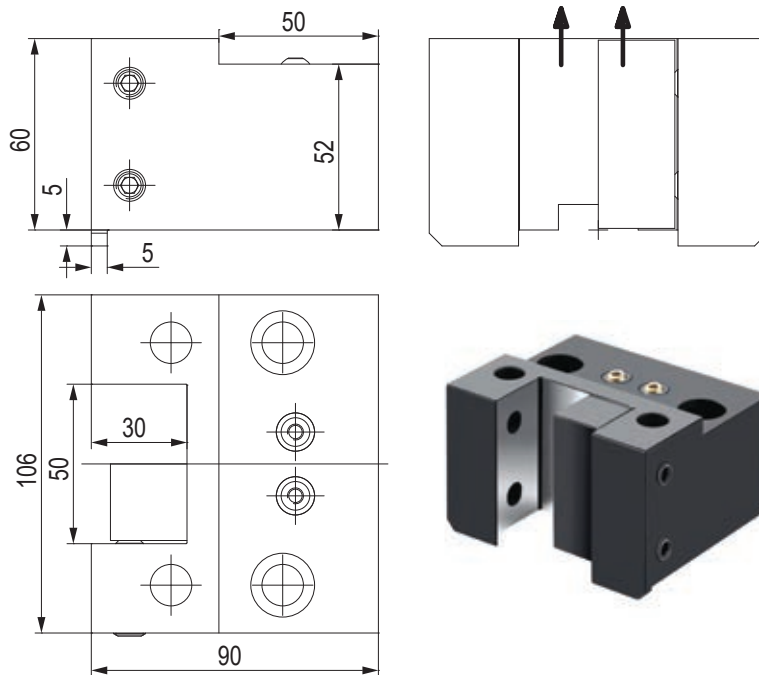

| CODE N. | CLAMPING SCREW | CLAMPING PLATE | COOLANT NOZZLE |
|------------|----------------|----------------|----------------|
| KMS-T00174 | 811-102040 | 832-002095 | 833-001080 |

PORTAUTENSILE ASSIALE - AXIAL TOOLHOLDERS

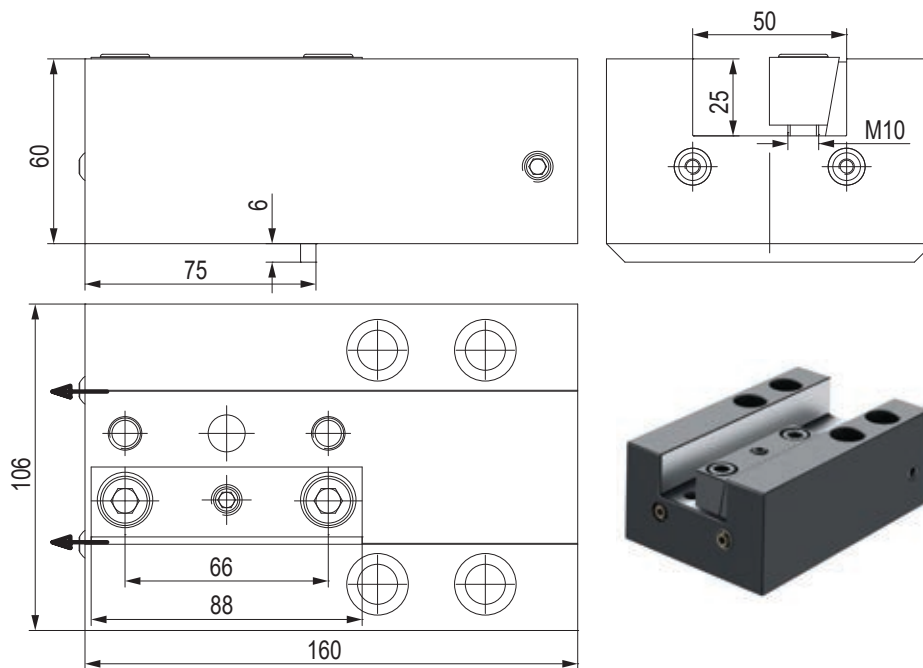

| CODE N. | CLAMPING PLATE | COOLANT NOZZLE |
|------------|----------------|----------------|
| KMS-T00082 | 832-007500 | 833-001080 |

PORTALAMA - CUT-OFF HOLDERS

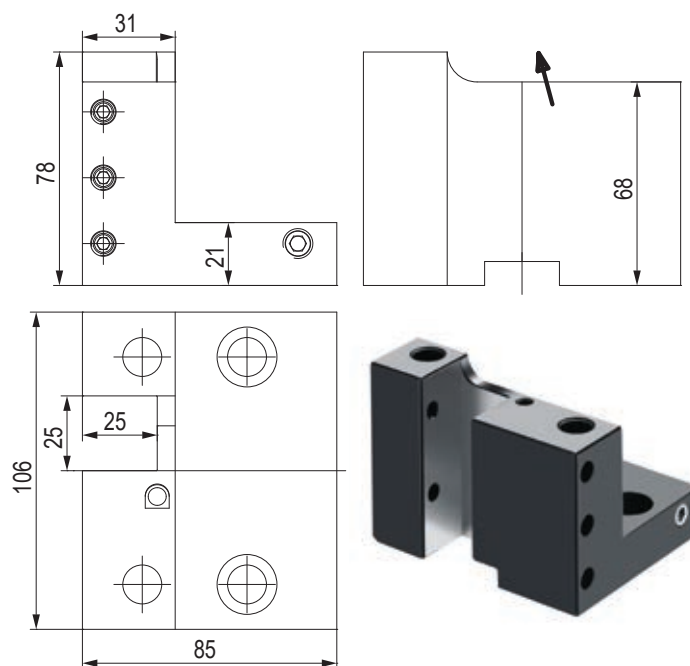

| CODE N. | CLAMPING SCREW |
|------------|----------------|
| KMS-T00156 | 811-104023 |

PORTAUTENSILE PER BARENI TOOLHOLDER FOR BORING BAR

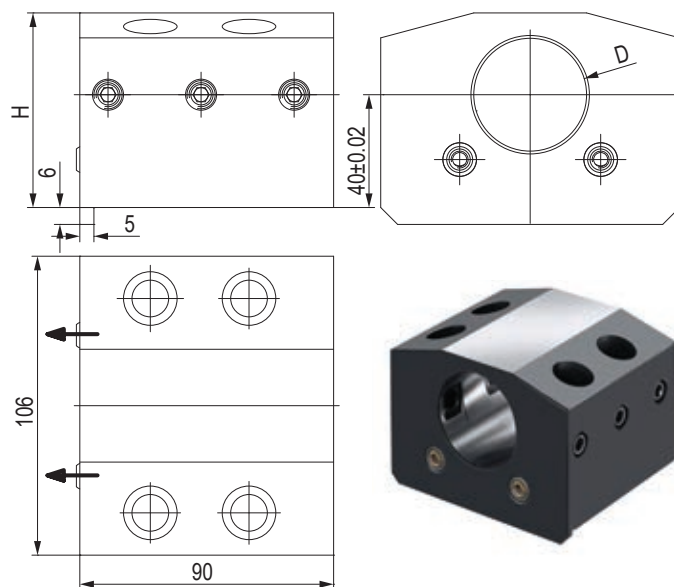

| CODE N. | D | H | CLAMPING SCREW | COOLANT NOZZLE |
|------------|----|----|----------------|----------------|
| KMS-T10036 | 40 | 69 | 811-102039 | 833-001110 |
| KMS-T10044 | 50 | 74 | 811-102038 | 833-001110 |

PORTAUTENSILE PER BARENI TOOLHOLDER FOR BORING BAR

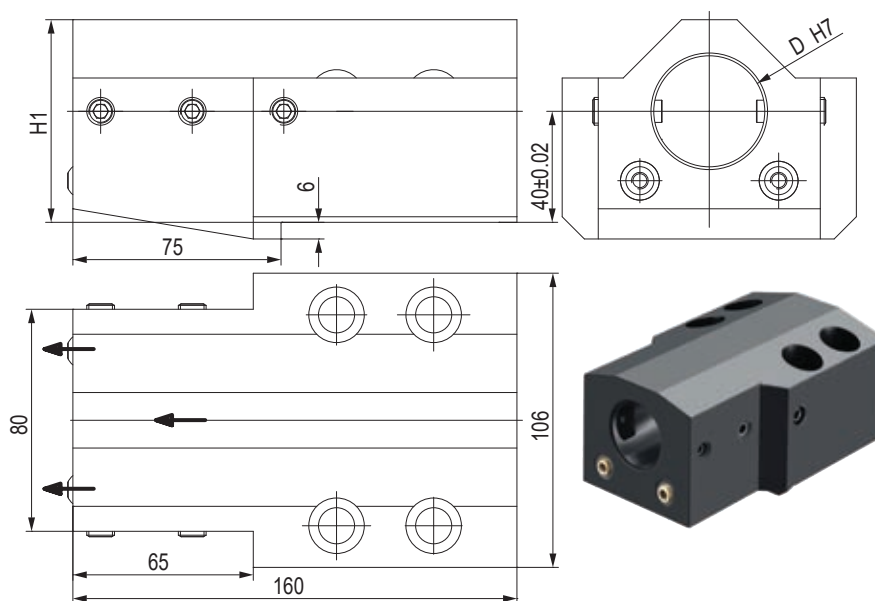

| CODE N. | D | H1 | CLAMPING SCREW | CLAMPING SCREW | COOLANT NOZZLE |
|------------|----|----|----------------|----------------|----------------|
| KMS-T10038 | 40 | 73 | 811-104030 | - | 833-001090 |
| 128-22519 | 50 | 76 | - | 811-102043 | 833-001090 |

PORTAUTENSILE COMBINATO PER BARENI E PUNTE A INSERTI COMBI TOOLHOLDER FOR BORING BAR AND INSERTDRILL

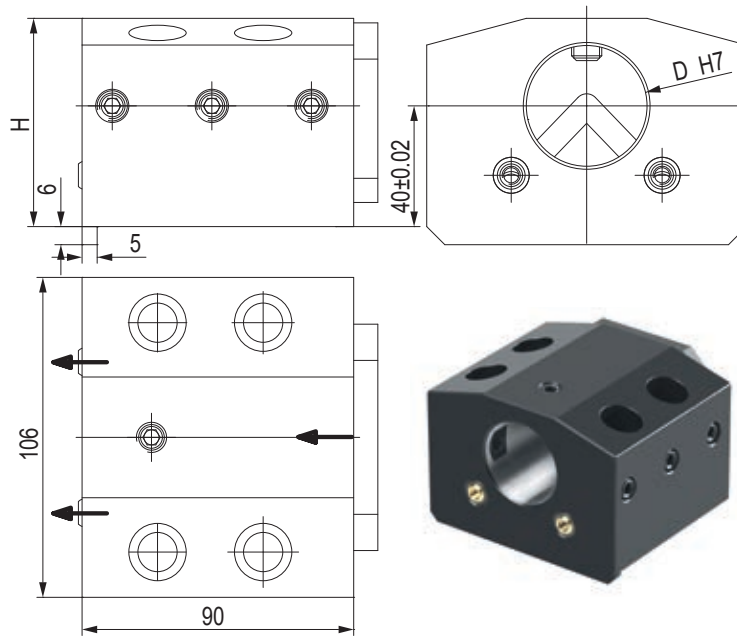

| CODE N. | CLAMPING SCREW1 (M10X25) | CLAMPING SCREW2 (M10X14) | COOLANT NOZZLE | COVER | SCREW FOR COVER |
|------------|--------------------------|--------------------------|----------------|------------|-----------------|
| KMS-T13064 | 811-102039 | 811-102060 | 833-001110 | 832-003063 | 811-101016 |

PORTAUTENSILE PER BARENI - TOOLHOLDER FOR BORING BAR

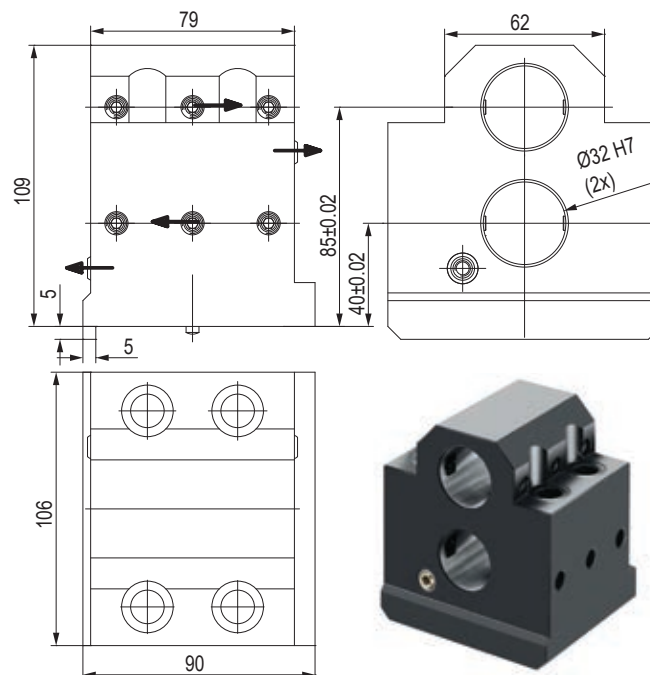

| CODE N. | CLAMPING SCREW | COOLANT NOZZLE | PIN |
|------------|----------------|----------------|------------|
| KMS-T10086 | 811-104021 | 833-001110 | 815-210170 |

PORTAUTENSILE PER BARENI - TOOLHOLDER FOR BORING BAR

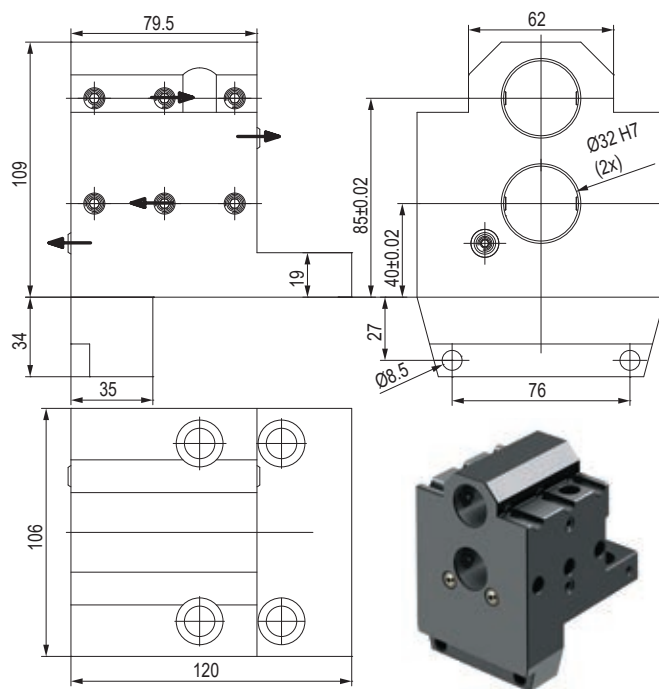

| CODE N. | CLAMPING SCREW | COOLANT NOZZLE |
|------------|----------------|----------------|
| KMS-T10208 | 811-104021 | 833-001110 |

PORTAUTENSILE CON USCITA POLIGONALE
POLIGONAL TOOLHOLDERS

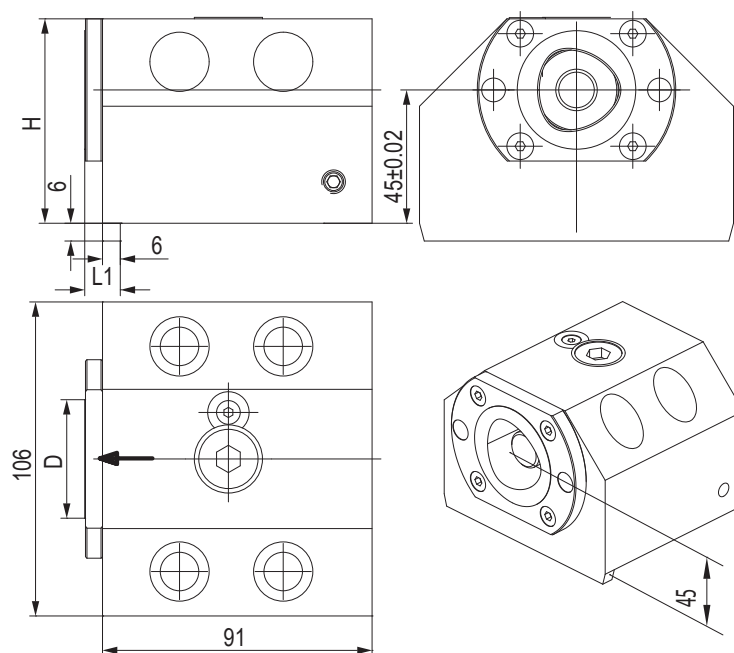

| CODE N. | CAPTO | D | H | L1 | CLAMPING UNIT |
|-----------|-------|----|----|----|---------------|
| 128-12526 | C40 | 40 | 69 | 12 | CXC40-10 |
| 128-12509 | C50 | 50 | 77 | 14 | CXC50-10 |

PORTAUTENSILE CON USCITA POLIGONALE POLIGONAL TOOLHOLDERS

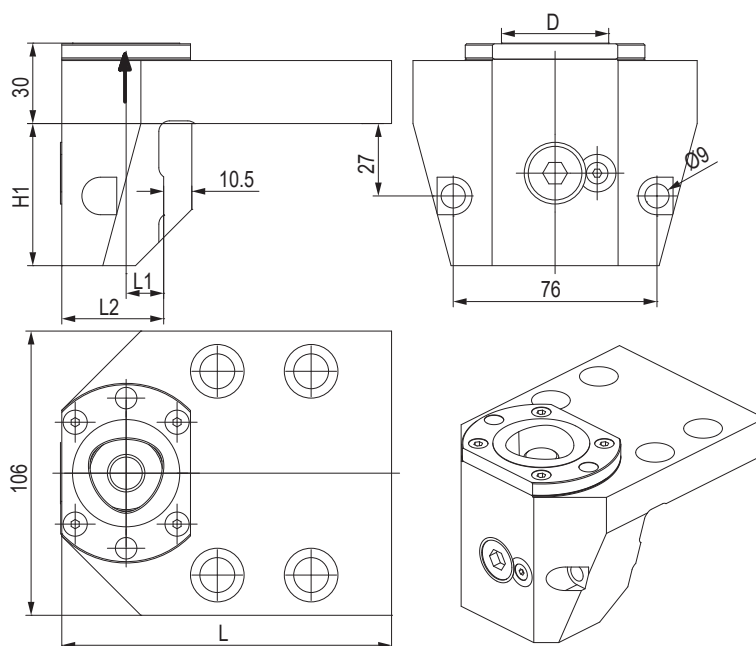

| CODE N. | CAPTO | D | H1 | L | L1 | L2 | CLAMPING UNIT |
|-----------|-------|----|----|-----|----|----|---------------|
| 128-12527 | C40 | 40 | 53 | 123 | 14 | 38 | CXC40-10 |
| 128-12513 | C50 | 50 | 65 | 139 | 22 | 54 | CXC50-10 |

PORTAUTENSILE MOTORIZZATO ASSIALE STRAIGHT DRILLING AND MILLING HEAD

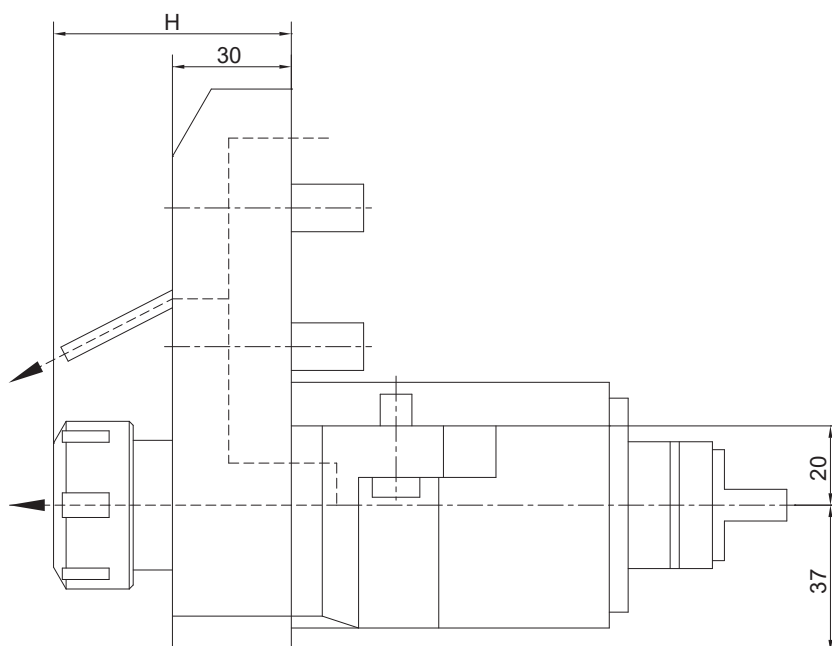

| CODE N. | ER | H | MAX SPEED (Rpm) | I | MAX. TORQUE (Nm) | INTERNAL COOLING | P Bar |
|-----------|------|---------|-----------------|-----|------------------|------------------|-------|
| 124-00001 | ER32 | 55.5-60 | 6000 | 1:1 | 70 | no | - |
| 124-00002 | ER32 | 55.5-60 | 6000 | 1:1 | 70 | yes | 80 |

PORTAUTENSILE MOTORIZZATO RADIALE ANGULAR DRILLING AND MILLING HEAD

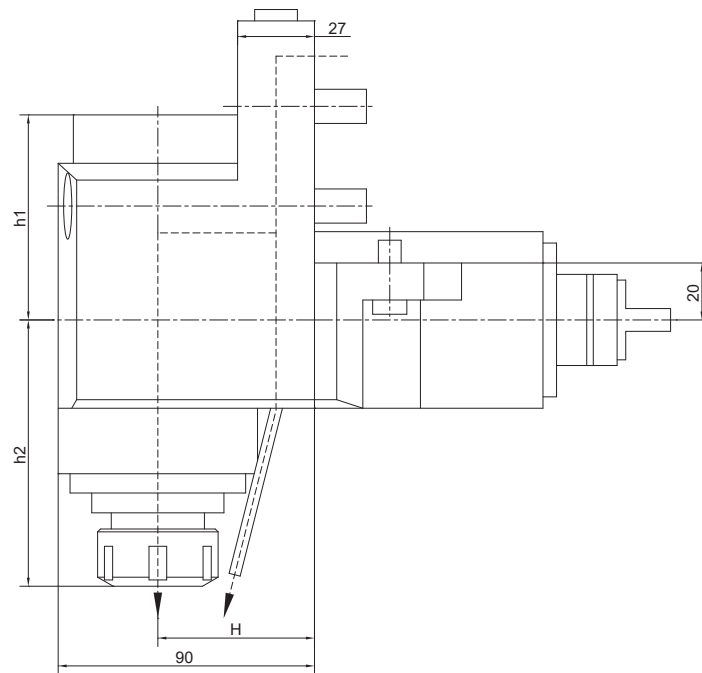

| CODE N. | ER | H | h1 | h2 | MAX SPEED (Rpm) | I | MAX. TORQUE (Nm) | INTERNAL COOLING | P Bar |
|-----------|------|----|----|---------|-----------------|-----|------------------|------------------|-------|
| 124-00003 | ER32 | 55 | 57 | 89-93.5 | 6000 | 1:1 | 70 | no | - |
| 124-00004 | ER32 | 55 | 72 | 89-93.5 | 6000 | 1:1 | 70 | yes | 80 |

BUSSOLA PER PORTABARENI DRILL SOCKET FOR TOOLHOLDER

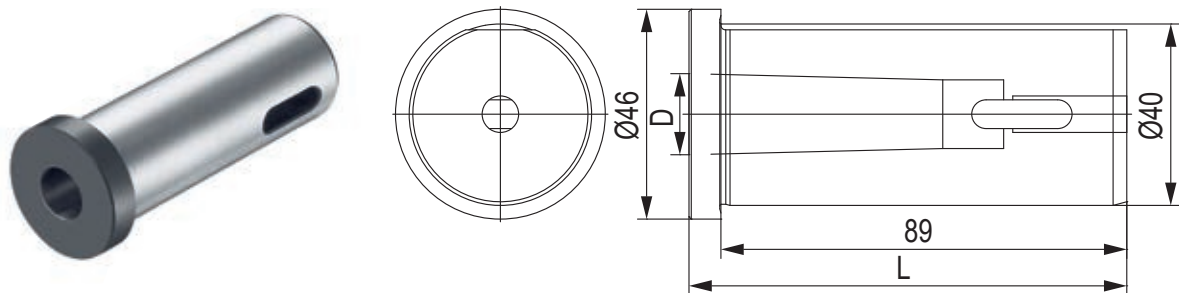

| CODE N. | MORSE | D | H |
|------------|-------|--------|-----|
| KMS-T22042 | 3 | 23.825 | 108 |
| KMS-T22046 | 2 | 17.78 | 96 |

BUSSOLA PER PORTABARENI BORING BAR SLEEVE FOR TOOLHOLDER

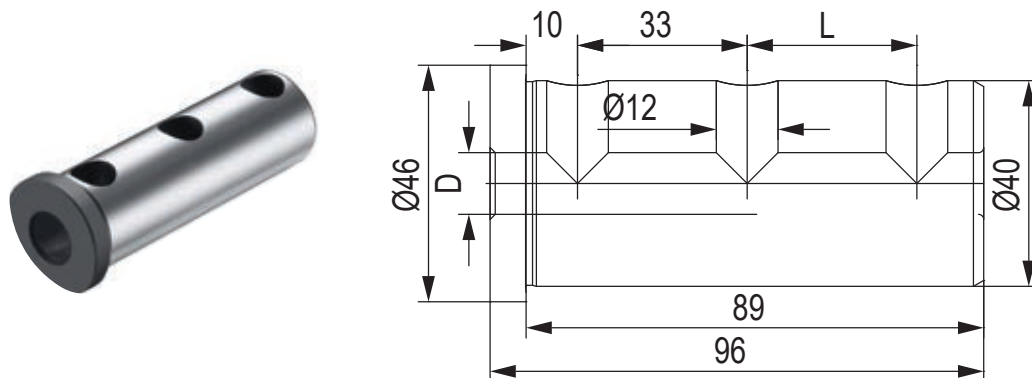

| CODE N. | D | L |
|------------|----|----|
| KMS-T20098 | 32 | 33 |
| KMS-T20096 | 25 | 33 |
| KMS-T20094 | 20 | 33 |
| KMS-T20092 | 16 | 33 |
| KMS-T20090 | 12 | - |
| KMS-T20088 | 10 | - |
| KMS-T20086 | 8 | - |

BUSSOLA PER PORTABARENI BORING BAR SLEEVE FOR TOOLHOLDER

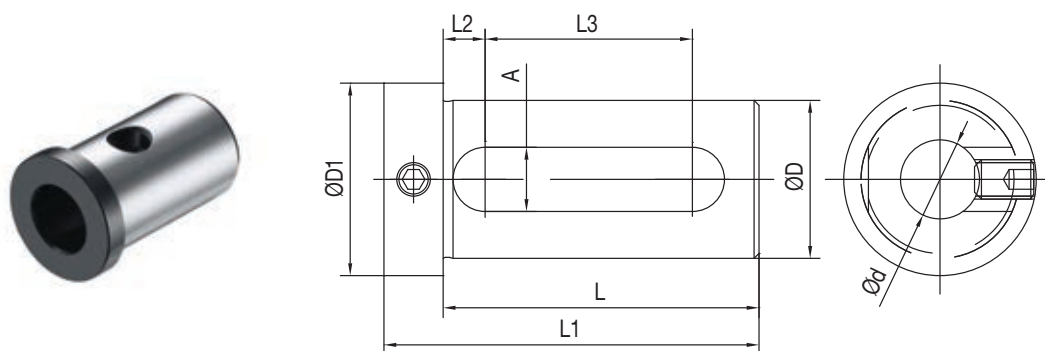

| CODE N. | D | d | L | L1 | L2 | L3 | A | D1 |
|-----------|----|----|----|----|----|----|----|----|
| 165-64241 | 40 | 16 | 74 | 88 | 9 | 51 | 14 | 48 |
| 165-64243 | 40 | 20 | 74 | 88 | 9 | 51 | 14 | 48 |
| 165-64244 | 40 | 25 | 74 | 88 | 9 | 51 | 14 | 48 |
| 165-64245 | 40 | 32 | 74 | 88 | 9 | 51 | 14 | 48 |
| 165-65017 | 50 | 25 | 84 | 98 | 9 | 61 | 14 | 59 |
| 165-65018 | 50 | 32 | 84 | 98 | 9 | 61 | 14 | 59 |
| 165-65019 | 50 | 40 | 84 | 98 | 9 | 61 | 14 | 59 |

DMG MORI

CL 200/203
 SL 20/25
 SL 200/203/204/250
 253/254 (MC, SMD) - 2500Y
 ZL/DL 200/250 (MC)
 DURATURN 2030
 DURATURN 2050
 DURATURN 2550

GOODWAY

GS 200/260/280
 GA 2000/2600
 GA 2800/3000
 GA 3300/3600

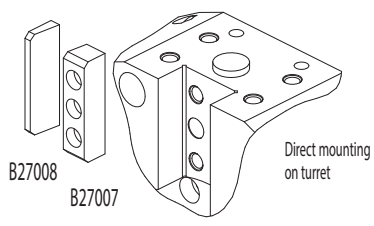

B27008
 B27007
 Direct mounting on turret

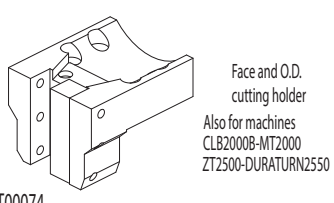

KMS-T00074
 Face and O.D. cutting holder
 Also for machines
 CLB2000B-MT2000
 ZT2500-DURATURN2550

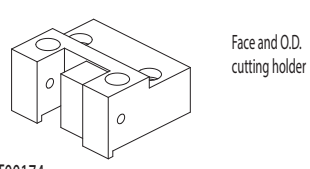

KMS-T00174
 Face and O.D. cutting holder

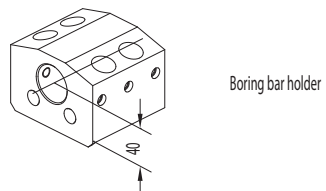

KMS-T10036 (Ø40 mm)
 KMS-T10044 (Ø50 mm)
 Boring bar holder

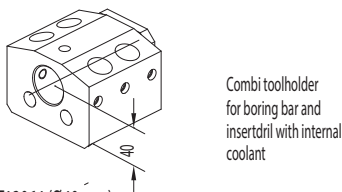

KMS-T13064 (Ø40 mm)
 128-22540 (Ø50 mm)
 Combi toolholder for boring bar and insertdrill with internal coolant

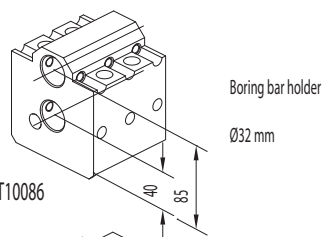

KMS-T10086
 Boring bar holder
 Ø32 mm

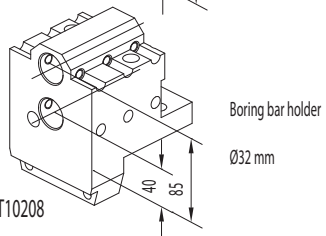

KMS-T10208
 Boring bar holder
 Ø32 mm

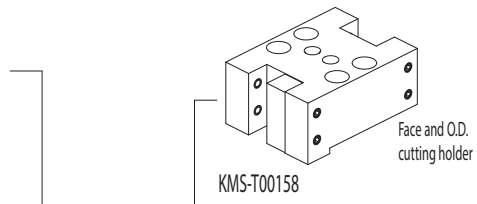

KMS-T00158
 Face and O.D. cutting holder

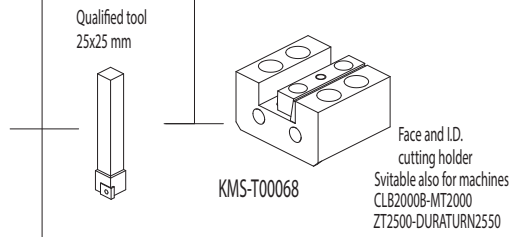

KMS-T00068
 Face and I.D. cutting holder
 Suitable also for machines
 CLB2000B-MT2000
 ZT2500-DURATURN2550

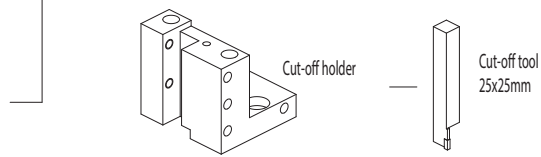

KMS-T00156
 Cut-off holder
 Suitable also for machines
 CLB2000B-MT2000
 ZT2500-DURATURN2550

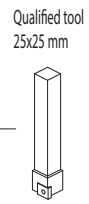

Qualified tool
 25x25 mm

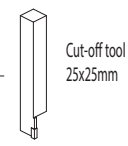

Cut-off tool
 25x25mm

ACCESSORIES

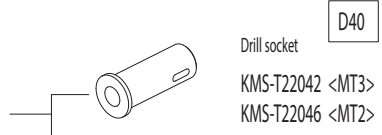

D40
 Drill socket
 KMS-T22042 <MT3>
 KMS-T22046 <MT2>

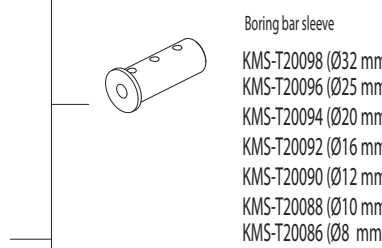

Boring bar sleeve
 KMS-T20098 (Ø32 mm)
 KMS-T20096 (Ø25 mm)
 KMS-T20094 (Ø20 mm)
 KMS-T20092 (Ø16 mm)
 KMS-T20090 (Ø12 mm)
 KMS-T20088 (Ø10 mm)
 KMS-T20086 (Ø8 mm)

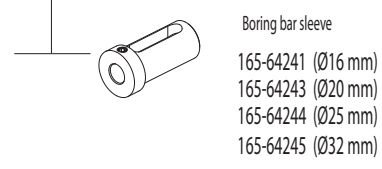

D50
 Boring bar sleeve
 165-64241 (Ø16 mm)
 165-64243 (Ø20 mm)
 165-64244 (Ø25 mm)
 165-64245 (Ø32 mm)

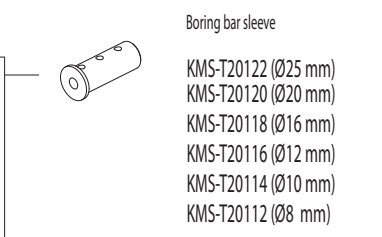

Boring bar sleeve
 KMS-T20122 (Ø25 mm)
 KMS-T20120 (Ø20 mm)
 KMS-T20118 (Ø16 mm)
 KMS-T20116 (Ø12 mm)
 KMS-T20114 (Ø10 mm)
 KMS-T20112 (Ø8 mm)



Boring bar sleeve
 165-63347 (Ø16 mm)
 165-63349 (Ø20 mm)
 165-63350 (Ø25 mm)

CONNECTION

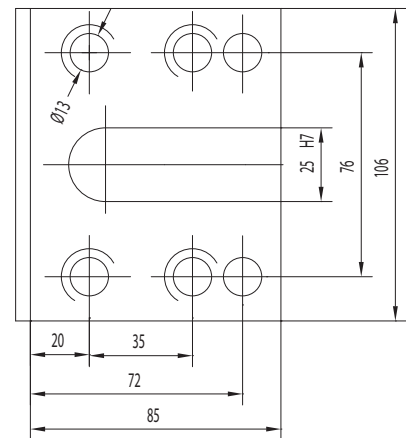

D50
 165-65017 (Ø25 mm)
 165-65018 (Ø32 mm)
 165-65019 (Ø40 mm)

KINTEK

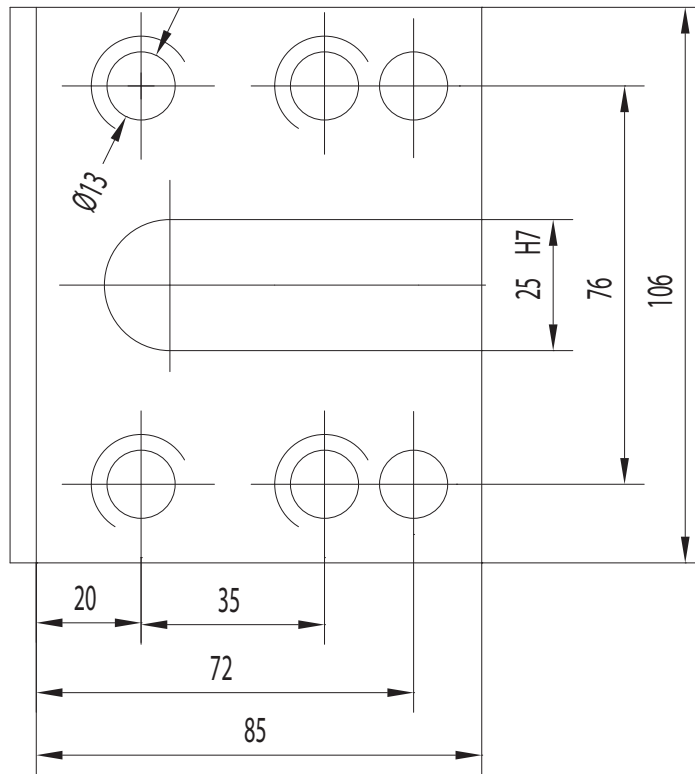

GOODWAY

CONNECTION

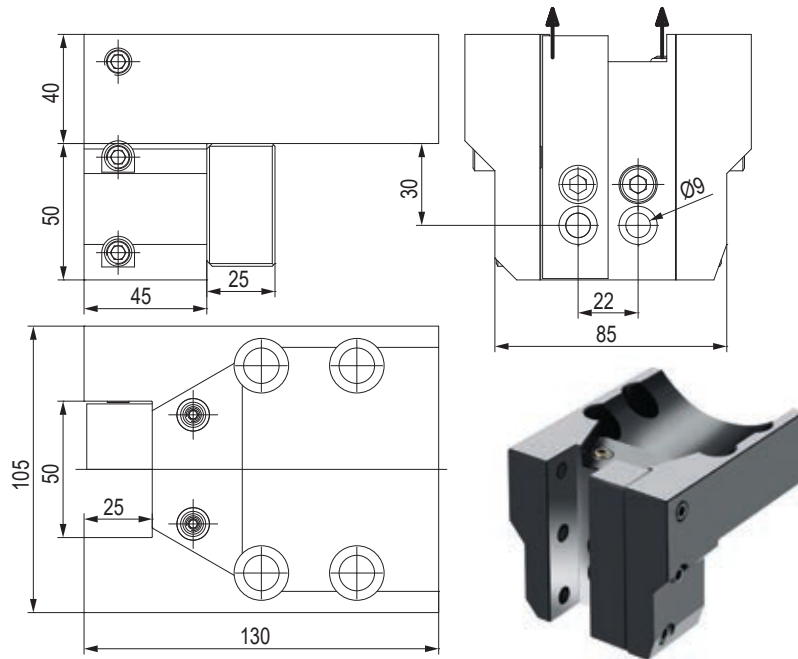

PORTAUTENSILE RADIALE - RADIAL TOOLHOLDERS

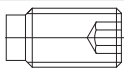
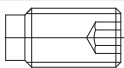

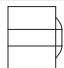
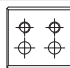
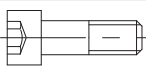
| CODE N. | CLAMPINGSCREW 1 (M10X25) | CLAMPING SCREW 2 (M10X16) | CLAMPING PLATE | COOLANT NOZZLE | SPACER | SCREW FOR SPACER |
|------------|-------------------------------------------------------------------------------------|-------------------------------------------------------------------------------------|-------------------------------------------------------------------------------------|--------------------------------------------------------------------------------------|---------------------------------------------------------------------------------------|---------------------------------------------------------------------------------------|
| KMS-T00074 |  |  |  |  |  |  |
| | 811-104030 | 811-104028 | 832-002117 | 833-001110 | 832-002132 | 811-101041 |

PORTAUTENSILE RADIALE - RADIAL TOOLHOLDERS

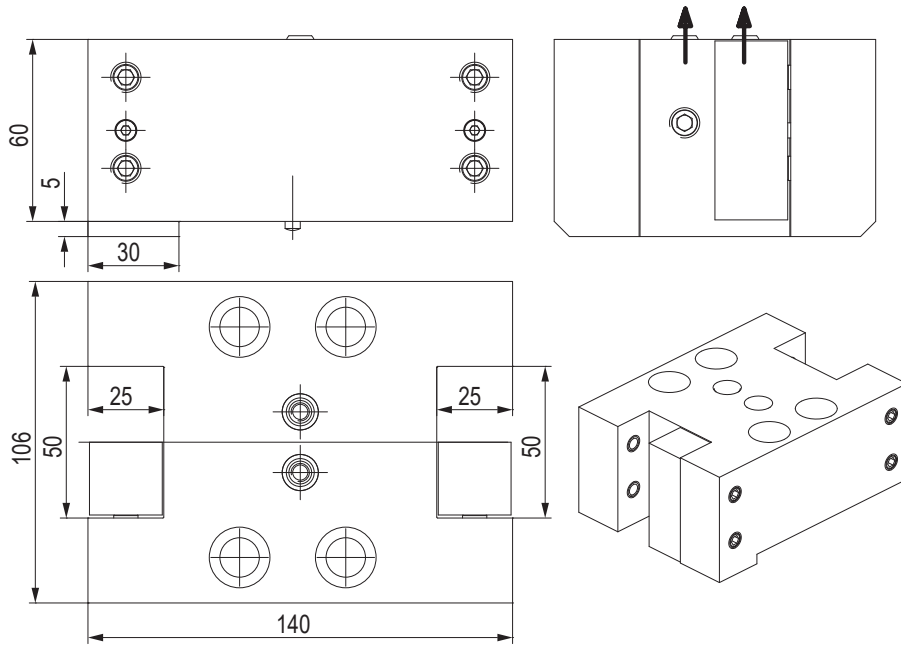

| CODE N. | CLAMPING SCREW | CLAMPING PLATE | SCREW FOR CLAMPING PLATE | SPRING FOR CLAMPING PLATE | COOLANT NOZZLE | PIN |
|------------|----------------|----------------|--------------------------|---------------------------|----------------|------------|
| KMS-T00158 | 811-104030 | 832-002095 | 811-302004 | 824-101010 | 833-001110 | 815-220008 |

PORTAUTENSILE RADIALE - RADIAL TOOLHOLDERS

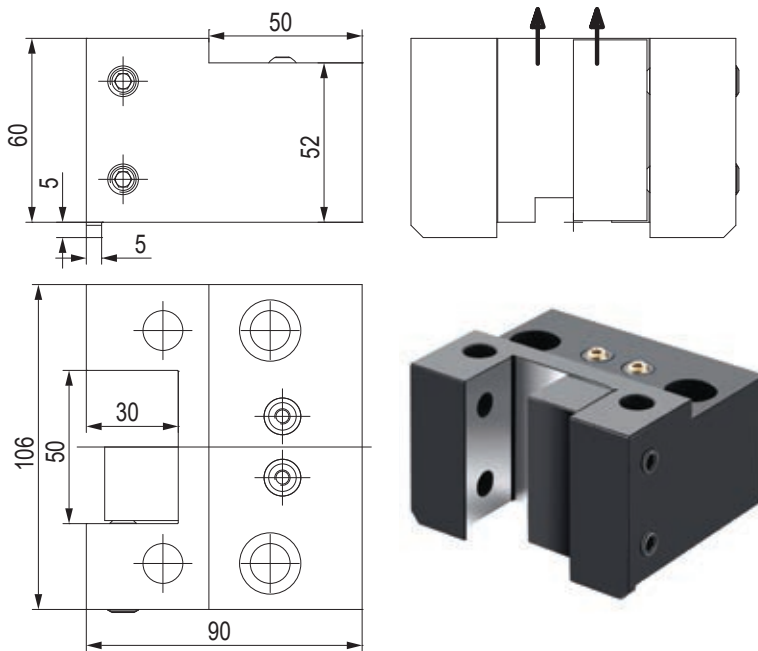

| CODE N. | CLAMPING SCREW | CLAMPING PLATE | COOLANT NOZZLE |
|------------|----------------|----------------|----------------|
| KMS-T00174 | 811-102040 | 832-002095 | 833-001080 |

PORTAUTENSILE ASSIALE - AXIAL TOOLHOLDERS

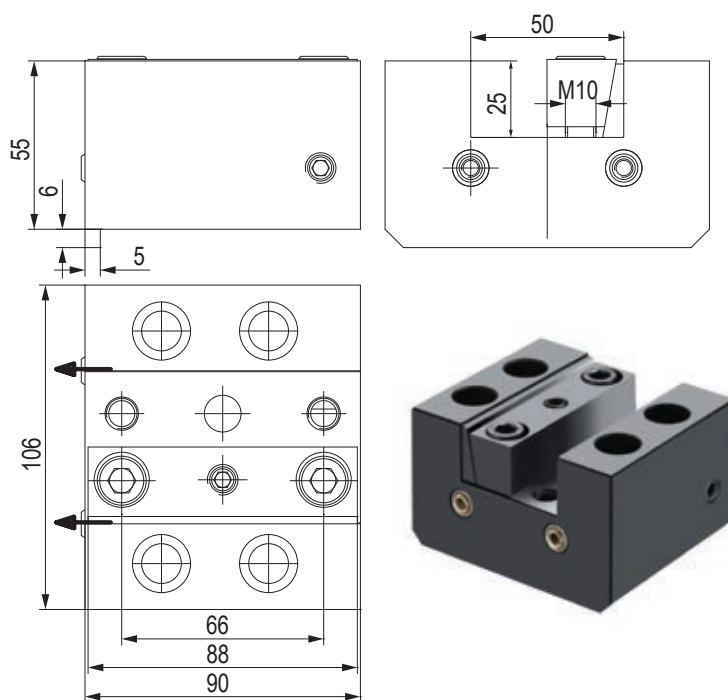

| CODE N. | CLAMPING PLATE | COOLANT NOZZLE |
|------------|----------------|----------------|
| KMS-T00068 | 832-007500 | 833-001110 |

PORTALAMA - CUT-OFF TOOLHOLDERS

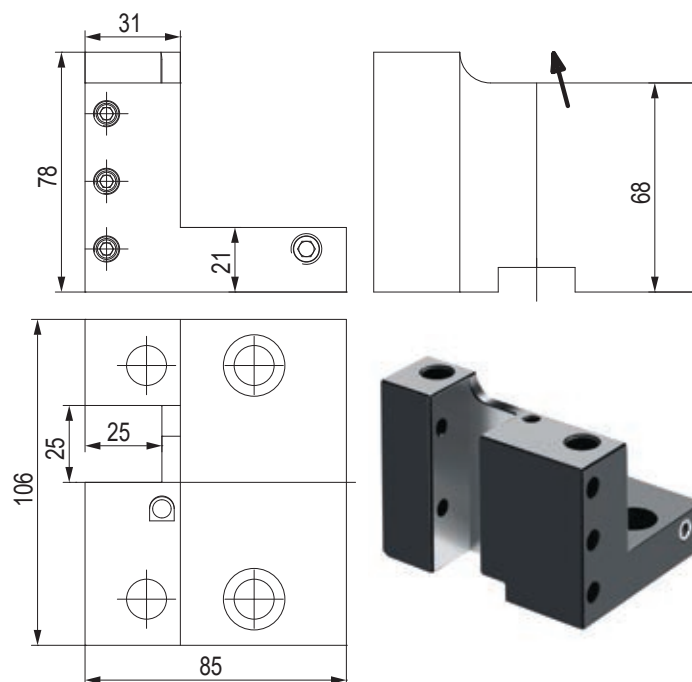

| CODE N. | CLAMPING SCREW |
|------------|----------------|
| KMS-T00156 | 811-104023 |

PORTAUTENSILE PER BARENI - TOOLHOLDER FOR BORING BAR

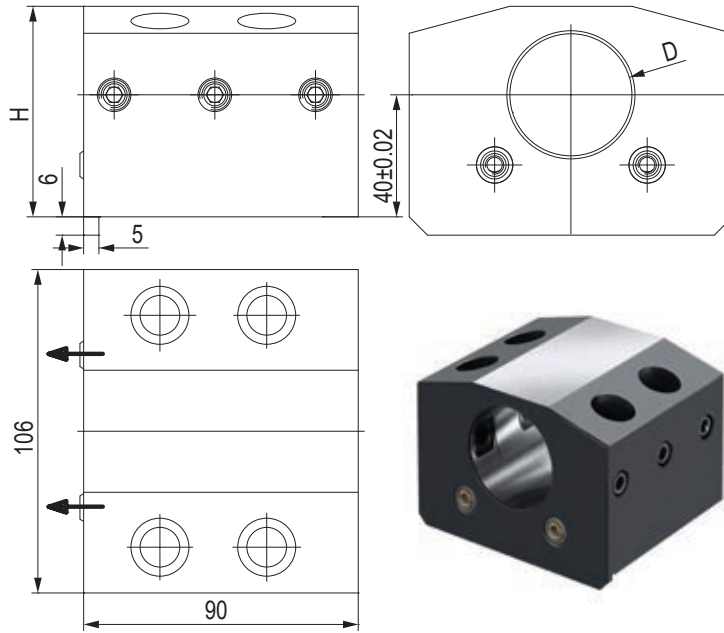

| CODE N. | D | H | CLAMPING SCREW | COOLANT NOZZLE |
|------------|----|----|----------------|----------------|
| KMS-T10036 | 40 | 69 | 811-102039 | 833-001110 |
| KMS-T10044 | 50 | 74 | 811-102038 | 833-001110 |

PORTAUTENSILE COMBINATO PER BARENI E PUNTE A INSERTI COMBI TOOLHOLDER FOR BORING BAR AND INSERT DRILL

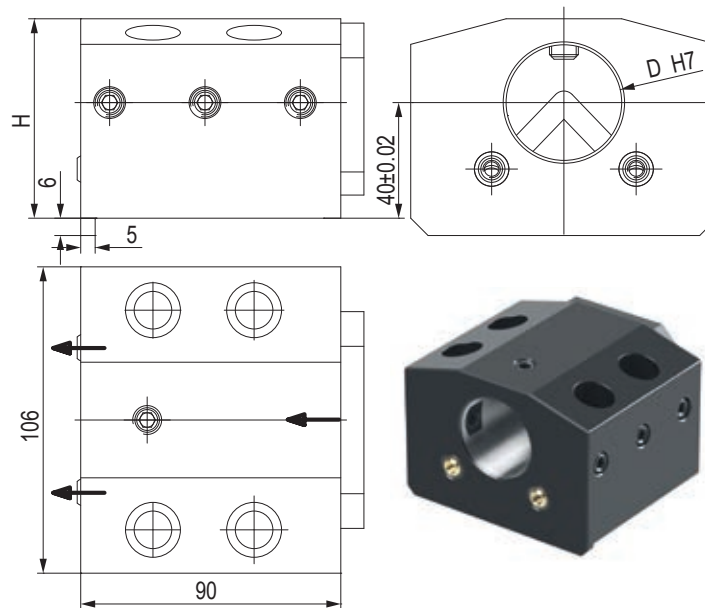

| CODE N. | D | H | CLAMPING SCREW 1 (D40 M10X25) (D50 M10X20) | CLAMPING SCREW 2 (M10X14) | COOLANT NOZZLE | COVER | SCREW FOR COVER |
|------------|----|----|-----------------------------------------------|------------------------------|----------------|------------|-----------------|
| KMS-T13064 | 40 | 69 | 811-102039 | 811-102060 | 833-001110 | 832-003063 | 811-101016 |
| 128-22540 | 50 | 74 | 811-102038 | 811-102060 | 833-001110 | 832-003321 | 811-101016 |

PORTAUTENSILE PER BARENI - TOOLHOLDER FOR BORING

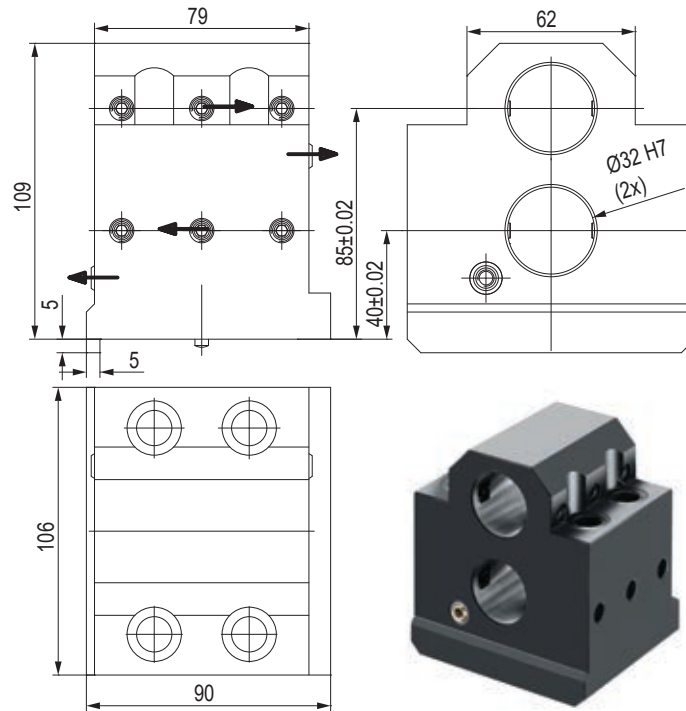

| CODE N. | CLAMPING SCREW | COOLANT NOZZLE | PIN |
|------------|----------------|----------------|------------|
| KMS-T10086 | 811-104021 | 833-001110 | 815-210170 |

PORTAUTENSILE PER BARENI - TOOLHOLDER FOR BORING

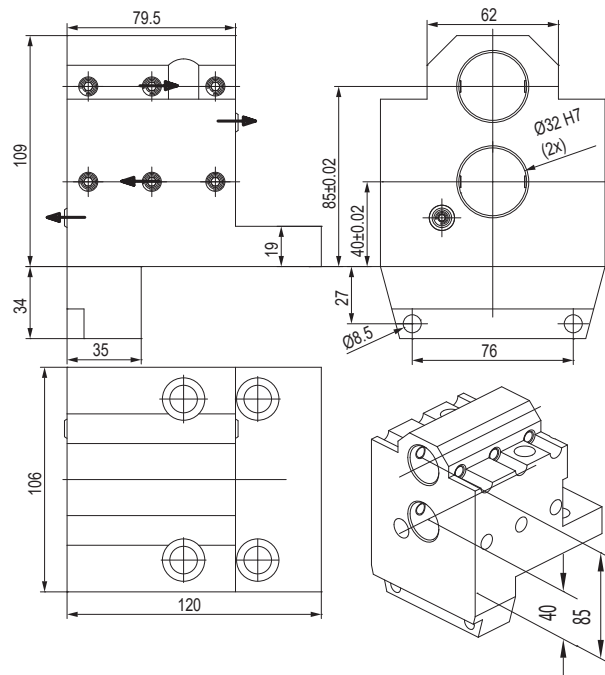

| CODE N. | CLAMPING SCREW | COOLANT NOZZLE |
|------------|----------------|----------------|
| KMS-T10208 | 811-104021 | 833-001110 |

BUSSOLA PER PORTABARENI DRILL SOCKET FOR TOOLHOLDER

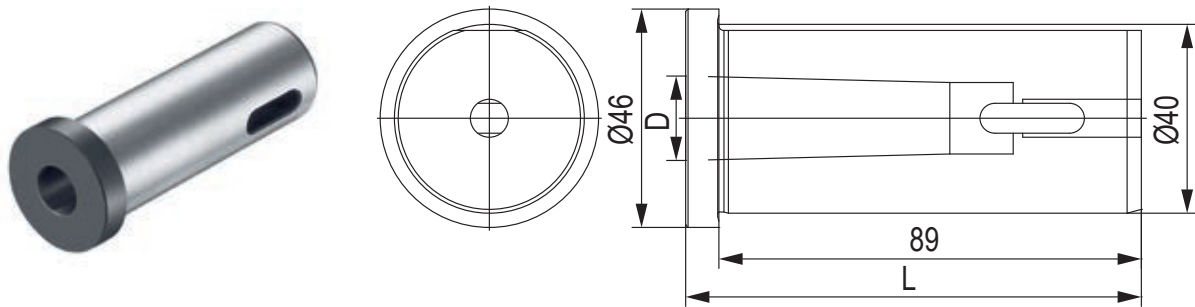

| CODE N. | MORSE | D | H |
|------------|-------|--------|-----|
| KMS-T22042 | 3 | 23.825 | 108 |
| KMS-T22046 | 2 | 17.78 | 96 |

PORTAUTENSILE PER BARENI - TOOLHOLDER FOR BORING

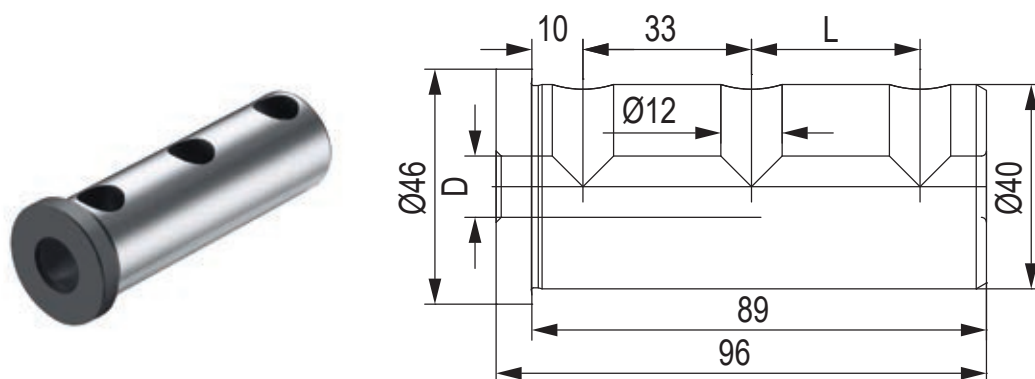

| CODE N. | D | L |
|------------|----|----|
| KMS-T20098 | 32 | 33 |
| KMS-T20096 | 25 | 33 |
| KMS-T20094 | 20 | 33 |
| KMS-T20092 | 16 | 33 |
| KMS-T20090 | 12 | - |
| KMS-T20088 | 10 | - |
| KMS-T20086 | 8 | - |

BUSSOLA PER PORTABARENI BORING BAR SLEEVE FOR TOOLHOLDER

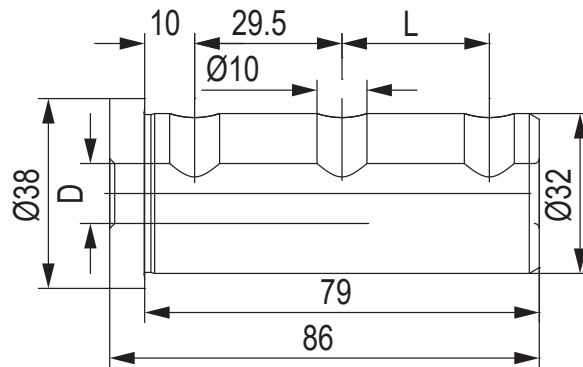

| CODE N. | D | L |
|------------|----|------|
| KMS-T20122 | 25 | 29.5 |
| KMS-T20120 | 20 | 29.5 |
| KMS-T20118 | 16 | 29.5 |
| KMS-T20116 | 12 | 29.5 |
| KMS-T20114 | 10 | - |
| KMS-T20112 | 8 | - |



BUSSOLA PER PORTABARENI BORING BAR SLEEVE FOR TOOLHOLDER

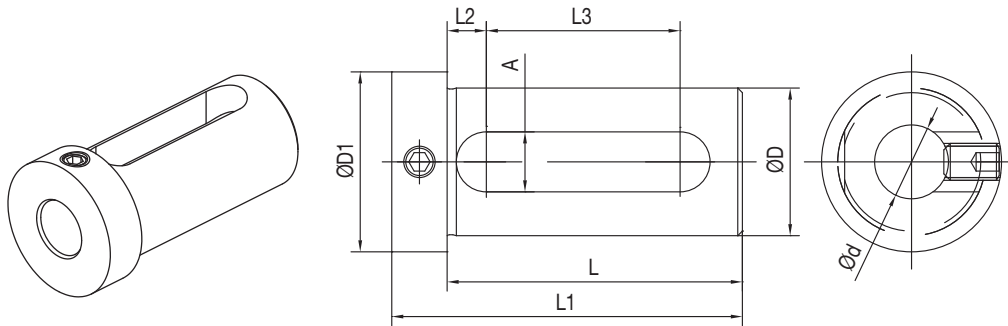

| CODE N. | D | d | L | L1 | L2 | L3 | A | D1 |
|-----------|----|----|----|----|----|----|----|----|
| 165-63347 | 32 | 16 | 65 | 77 | 8 | 42 | 13 | 39 |
| 165-63349 | 32 | 20 | 65 | 77 | 8 | 42 | 13 | 39 |
| 165-63350 | 32 | 25 | 65 | 77 | 8 | 42 | 13 | 39 |
| 165-64241 | 40 | 16 | 75 | 89 | 9 | 51 | 14 | 48 |
| 165-64243 | 40 | 20 | 75 | 89 | 9 | 51 | 14 | 48 |
| 165-64244 | 40 | 25 | 75 | 89 | 9 | 51 | 14 | 48 |
| 165-64245 | 40 | 32 | 75 | 89 | 9 | 51 | 14 | 48 |
| 165-65017 | 50 | 25 | 85 | 99 | 9 | 61 | 14 | 60 |
| 165-65018 | 50 | 32 | 85 | 99 | 9 | 61 | 14 | 60 |
| 165-65019 | 50 | 40 | 85 | 99 | 9 | 61 | 14 | 60 |

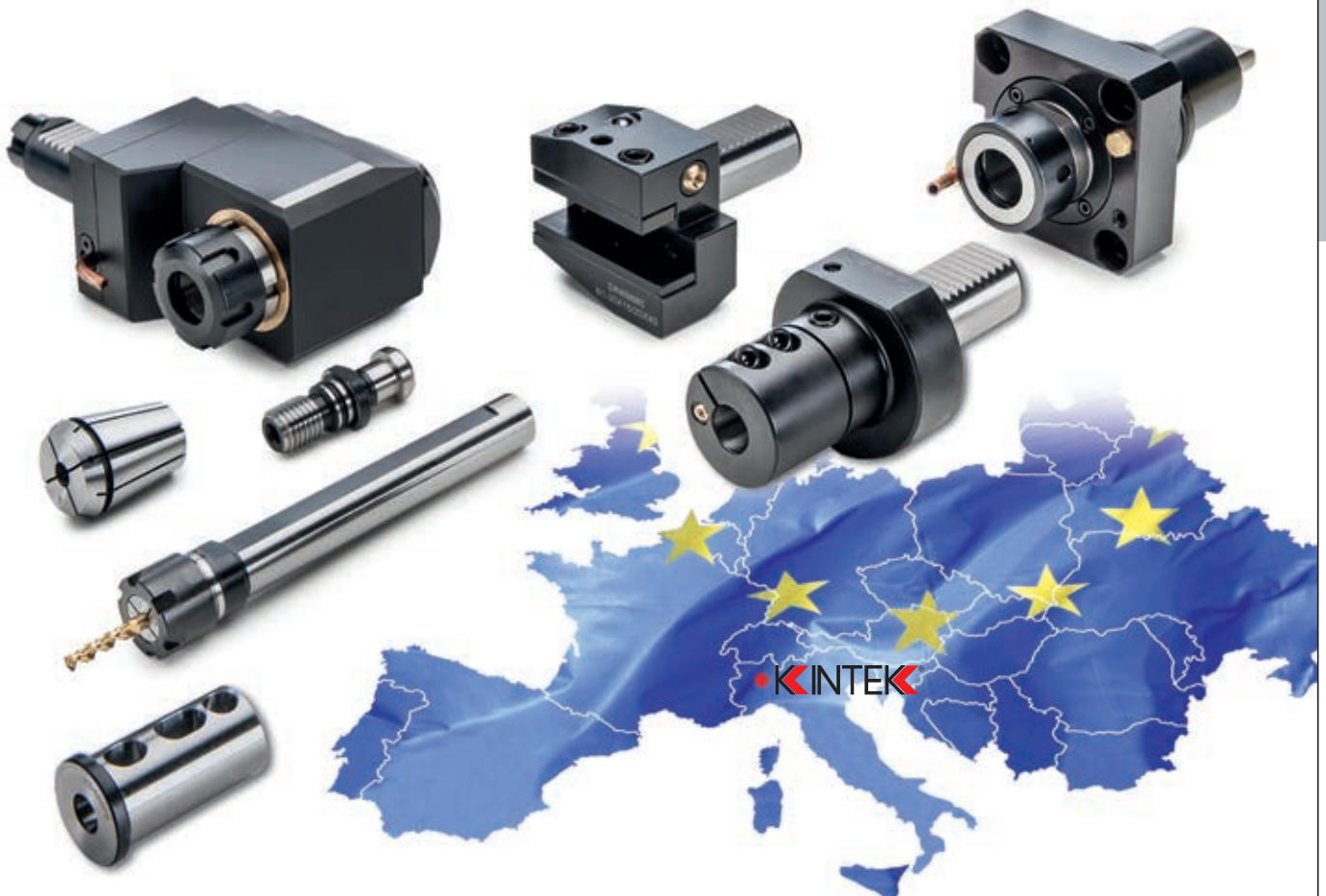

KINTEK®



NEW PRODUCTION PLANT
A.M.T S.R.L. - CASELLE T.SE - TORINO - ITALY



HEAD OFFICE
KINTEK S.R.L. - MAPPANO - TORINO - ITALY



MAIN PRODUCTION PLANT
KINTEK TOOLING KFT - BEKESCSABA - HUNGARY

KINTEK s.r.l.

Via Goretta 88/G - 10079 MAPPANO - (TO) - ITALY
Tel. +39 011 99 68 065 - Fax +39 011 99 65 662
e-mail: info@kintek.it
<http://www.kintek.it>