

KINTEK®



Use our QR Code to
know more about
Kintek.



**TOOLHOLDERS
FOR CNC LATHES
2022**

INNOVATIVE TECHNOMECHANICAL COMPONENTS



We brand Quality!

30+ years producing toolholders for milling and turning machines

www.kintek.it



TOOLHOLDERS FOR CNC LATHES (BMT, BOLT-ON, VDI DIN69880)



PORTAUTENSILI PER TORNII CNC
(BMT, BOLT-ON, VDI DIN69880)



CNC-DREHEMASCHINEN
(BMT, BOLT-ON, VDI DIN69880)



PORTA-HERRAMIENTAS PARA TORNOS CNC
(BMT, BOLT-ON, VDI DIN69880)



PORTE-OUTILS POUR TOURS CNC
(BMT, BOLT-ON, VDI DIN69880)



РЕЗЦЕДЕРЖАТЕЛИ ДЛЯ
ТОКАРНЫХ СТАНКОВ С ЧПУ
(BMT, BOLT-ON, VDI DIN69880)



数控车床刀柄
BMT, BOLT-ON, VDI DIN69880

TOOLHOLDERS FOR CNC LATHES (BMT, BOLT-ON, VDI DIN69880)

BIGLIA TOOLHOLDERS
PORTAUTENSILI BIGLIA

Pag. 02

CMZ TOOLHOLDERS
PORTAUTENSILI CMZ

Pag. 03

DMG MORI CMZ TOOLHOLDERS
GOODWAY TOOLHOLDERS
PORTAUTENSILI DMG MORI CMZ
PORTAUTENSILI GOODWAY

Pag. 04-10

OKUMA HAAS TOOLHOLDERS
PORTAUTENSILI OKUMA HAAS

Pag. 11-16

NAKAMURA TOME CMZ TOOLHOLDERS
PORTAUTENSILI NAKAMURA CMZ

Pag. 17-20

DOOSAN PUMA TOOLHOLDERS
BMT 45 /55/65/75
PORTAUTENSILI DEWOO PUMA
BMT 45 /55/65/75

Pag. 21-27

MAZAK TOOLHOLDERS
PORTAUTENSILI MAZAK

Pag. 28-31

MURATA MURATEC MW120 - MW200 TOOLHOLDERS
PORTAUTENSILI MURATA MURATEC MW120 - MW200

Pag. 32-33

BIGLIA

B301/445/470/501(Y-S)
510/545/550/565/650/658
1200/446/465/745
765-B750/1250 16 ST.

02 TOOLHOLDERS FOR CNC LATHES

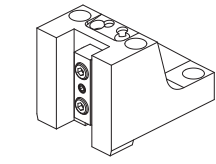

128-41524 (20x20 mm)
128-41525 (25x25 mm)

Face and O.D. cutting holder

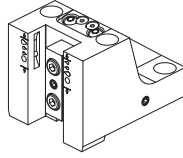

128-41524-IC (20x20 mm)
128-41525-IC (25x25 mm)
IC-TOOLTEK

Face and O.D. cutting holder

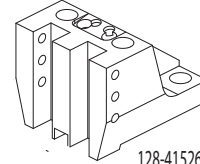

128-41526

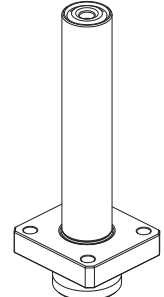

Control pin
137-00209

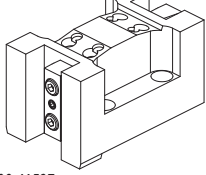

128-41527

Face and O.D. cutting holder

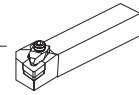

Qualified tool
20x20 mm

128-41527-IC

IC-TOOLTEK

Cut-off holder

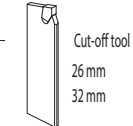

Cut-off tool
26 mm
32 mm

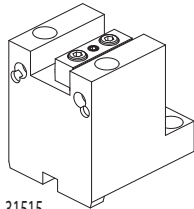

128-31515

Face and O.D. cutting holder

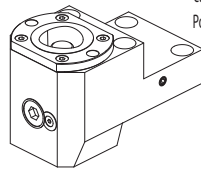

128-11580

Face and O.D. cutting holder
Poligonal C50

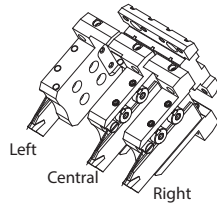

Left
Central
Right

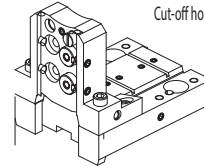

128-11566 (26 mm)

128-11567 (32 mm)

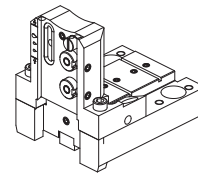

128-11566-IC (26 mm)

128-11567-IC (32 mm)

IC-TOOLTEK

ACCESSORIES

D32

Drill socket

114-33208 <MT1>

114-33209 <MT2>

D40

114-34008 <MT2>

114-34009 <MT3>

Boring bar sleeve

115-63260 (Ø8)

115-63261 (Ø10)

115-63211 (Ø12)

115-63212 (Ø16)

115-63213 (Ø20)

115-64043 (Ø8)

115-64044 (Ø10)

115-64045 (Ø12)

115-64046 (Ø16)

115-64047 (Ø20)

115-64048 (Ø25)

Boring bar sleeve

115-63214 (Ø25)

115-64049 (Ø32)

Boring bar sleeve

165-63352 (Ø8)

165-63353 (Ø10)

165-63354 (Ø12)

165-64247 (Ø8)

165-64248 (Ø10)

165-64249 (Ø12)

Boring bar sleeve

165-63356 (Ø16)

165-63358 (Ø20)

165-63359 (Ø25)

165-64251 (Ø16)

165-64253 (Ø20)

165-64254 (Ø25)

165-64255 (Ø32)

Boring bar sleeve

165-63347 (Ø16)

165-63349 (Ø20)

165-63350 (Ø25)

165-64241 (Ø16)

165-64243 (Ø20)

165-64244 (Ø25)

165-64245 (Ø32)

Boring bar sleeve

115-62573 (Ø6)

115-62538 (Ø8)

115-62539 (Ø10)

115-62540 (Ø12)

Boring bar sleeve

115-62541 (Ø16)

Protection cover
137-00244

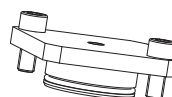

Driven tools

FAST-IN



124-05521
124-05522 i.coolant

124-05523
124-05524 i.coolant
124-05525 i.coolant **80 BAR**

CONNECTION

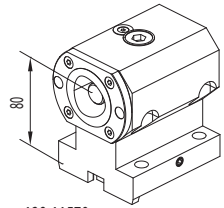
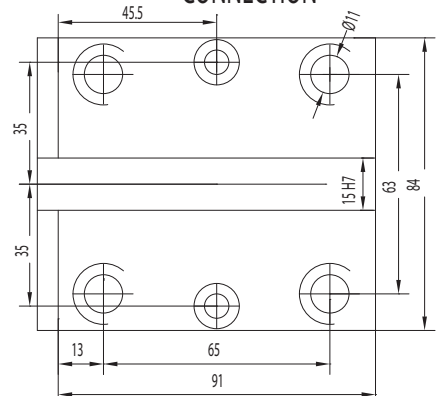

128-11579

Boring bar holder
Poligonal C50

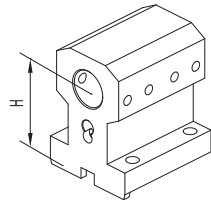

128-21538 D32 H=80
128-21540 D32 H=100
128-21548 D40 H=80

Toolholder
for boring bar

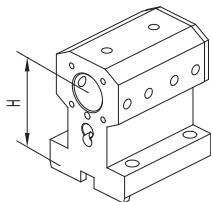

128-21539 D32 H=80
128-21541 D32 H=100
128-21549 D40 H=80

Combi toolholder
for boring bar
and insertdrill

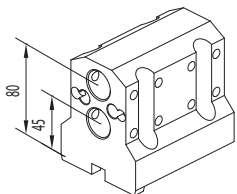

128-21542

Toolholder
for boring bar

2xØ25 mm

CMZ TL15T/M/TM/S/MS
TB46/67 M/CM

MIYANO ABX 51/64 THY / SY Y

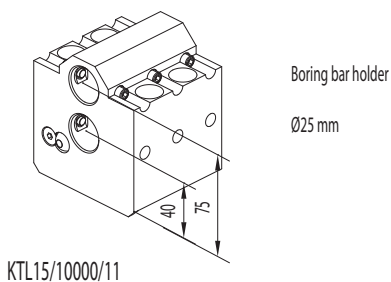
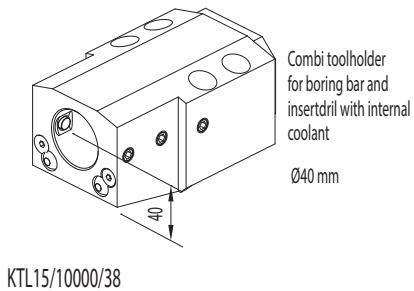
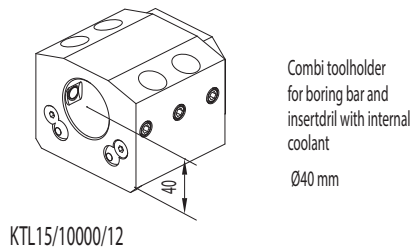
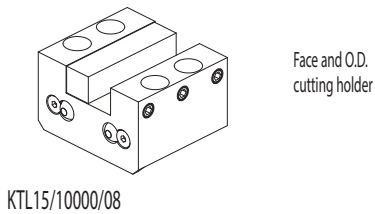
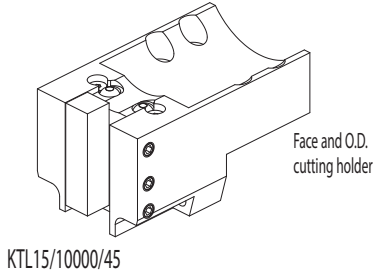
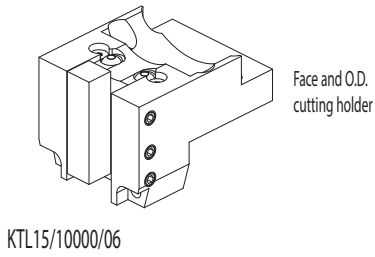

Qualified tool
20x20 mm

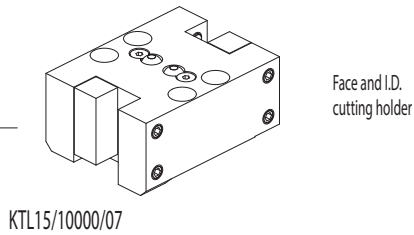

ACCESSORIES

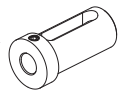

Boring bar sleeve
165-64241 (Ø16 mm)
165-64243 (Ø20 mm)
165-64244 (Ø25 mm)
165-64245 (Ø32 mm)

Boring bar sleeve
165-62545 (Ø12 mm)
165-62547 (Ø16 mm)
165-62549 (Ø20 mm)

CONNECTION

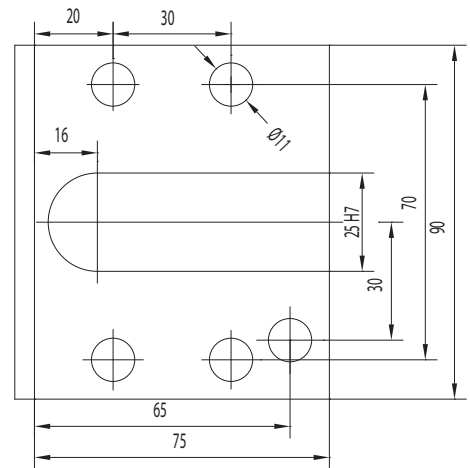

DMG MORI (VDI30)

CTX310/410 V4/V6 - CTX 320 V4/V6
 CTX420 V4/V6 (option) - CTX Alpha 300 V4
 CTX Alpha 500 V4/V6
 CTX Beta 500/800/1250 V4/V6 (option)
 TWIN 42/65/102
 SPRINT 65/50

RADIAL TURRET

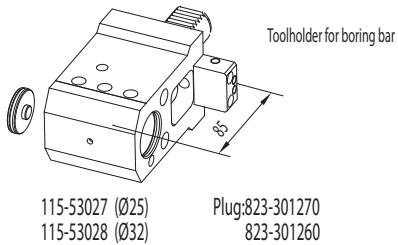
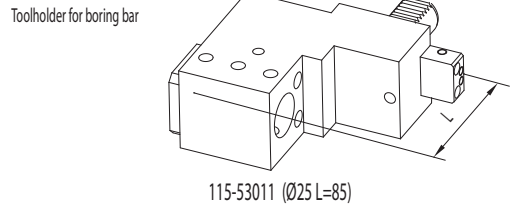
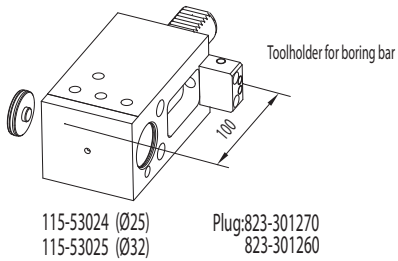
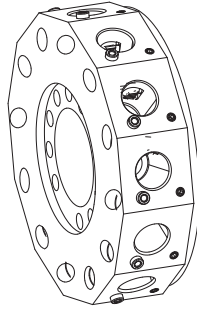

Toolholder for boring bar

- Boring bar sleeve
- 165-62551 (Ø25/Ø8)
 - 165-62552 (Ø25/Ø10)
 - 165-62553 (Ø25/Ø12)
 - 165-63352 (Ø32/Ø8)
 - 165-63353 (Ø32/Ø10)
 - 165-63354 (Ø32/Ø12)

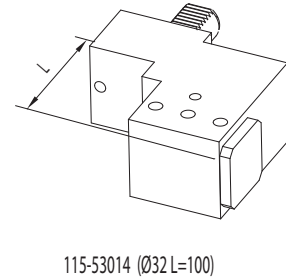

- Boring bar sleeve
- 165-62555 (Ø25/Ø16)
 - 165-62557 (Ø25/Ø20)
 - 165-63356 (Ø32/Ø16)
 - 165-63358 (Ø32/Ø20)
 - 165-63359 (Ø32/Ø25)

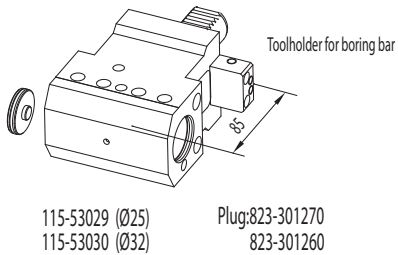

- Boring bar sleeve
- 165-62545 (Ø25/Ø12)
 - 165-62547 (Ø25/Ø16)
 - 165-62549 (Ø25/Ø20)
 - 165-63347 (Ø32/Ø16)
 - 165-63349 (Ø32/Ø20)
 - 165-63350 (Ø32/Ø25)

DMG MORI
(VDI40)

CTX410 V4/V6 (option)
CTX420 V4/V6
CTXBeta 500/800/1250 V4/V6
TWIN42/65/102 RG2
GMX250/300/400/500
SPRINT65 (option)

RADIAL TURRET

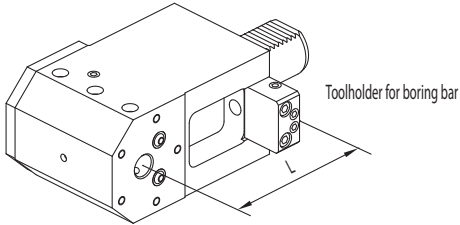

115-54076 (Ø16 L=120)
115-54077 (Ø20 L=120)

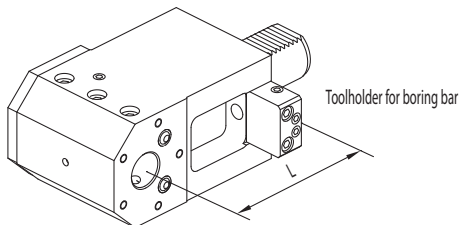

115-54130 (Ø25 L=100)

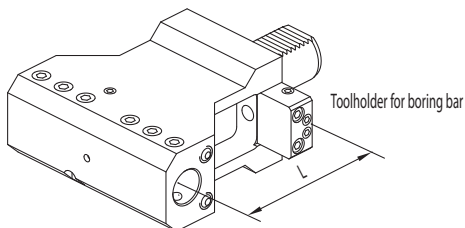

115-54133 (Ø25 L=100)

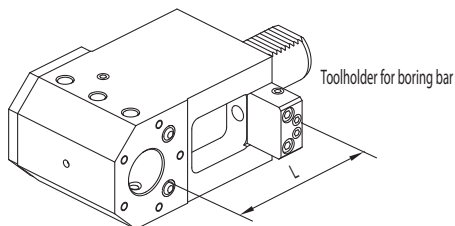

115-54131 (Ø32 L=100)
115-54078 (Ø25 L=120)
115-54079 (Ø32 L=120)

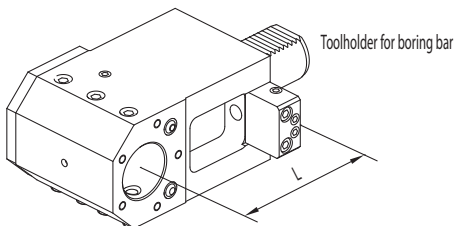

115-54132 (Ø40 L=100)
115-54080 (Ø40 L=120)

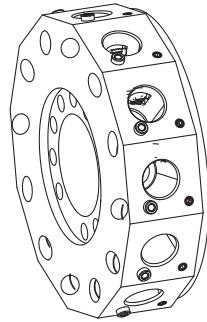

ACCESSORIES

Boring bar sleeve



165-62551 (Ø25/Ø8)
165-62552 (Ø25/Ø10)
165-62553 (Ø25/Ø12)

165-62555 (Ø25/Ø16)
165-62557 (Ø25/Å20)

165-63352 (Ø32/Ø8)
165-63353 (Ø32/Ø10)
165-63354 (Ø32/Ø12)

165-63356 (Ø32/Ø16)
165-63358 (Ø32/Ø20)
165-63359 (Ø32/Ø25)

165-64247 (Ø40/Ø8)
165-64248 (Ø40/Ø10)
165-64249 (Ø40/Ø12)

165-64251 (Ø40/Ø16)
165-64253 (Ø40/Ø20)
165-64254 (Ø40/Ø25)
165-64255 (Ø40/Ø32)

Boring bar sleeve

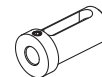

115-62044 (Ø20/Ø8)
115-62045 (Ø20/Ø10)
115-62046 (Ø20/Ø12)

165-62545 (Ø25/Ø12)
165-62547 (Ø25/Ø16)
165-62549 (Ø25/Ø20)

165-63347 (Ø32/Ø16)
165-63349 (Ø32/Ø20)
165-63350 (Ø32/Ø25)

165-64241 (Ø40/Ø16)
165-64243 (Ø40/Ø20)
165-64244 (Ø40/Ø25)
165-64245 (Ø40/Ø32)

Double toolholder for boring bar

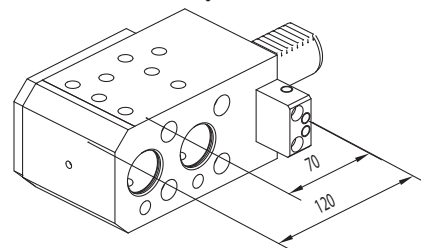

115-54147 (Ø32)

DMG MORI (BMT40)

NZ 1500/2000/3100
 NZ / NTZ 1000/2000/3000/3100/3150/3200
 NZ / NZX 2000/2500 (16 station turret)
 NL / NLX 1500/2000/2500 (20 station turret)
 DURATURN 2050/2550 MC
 LTX310ECO-BMT

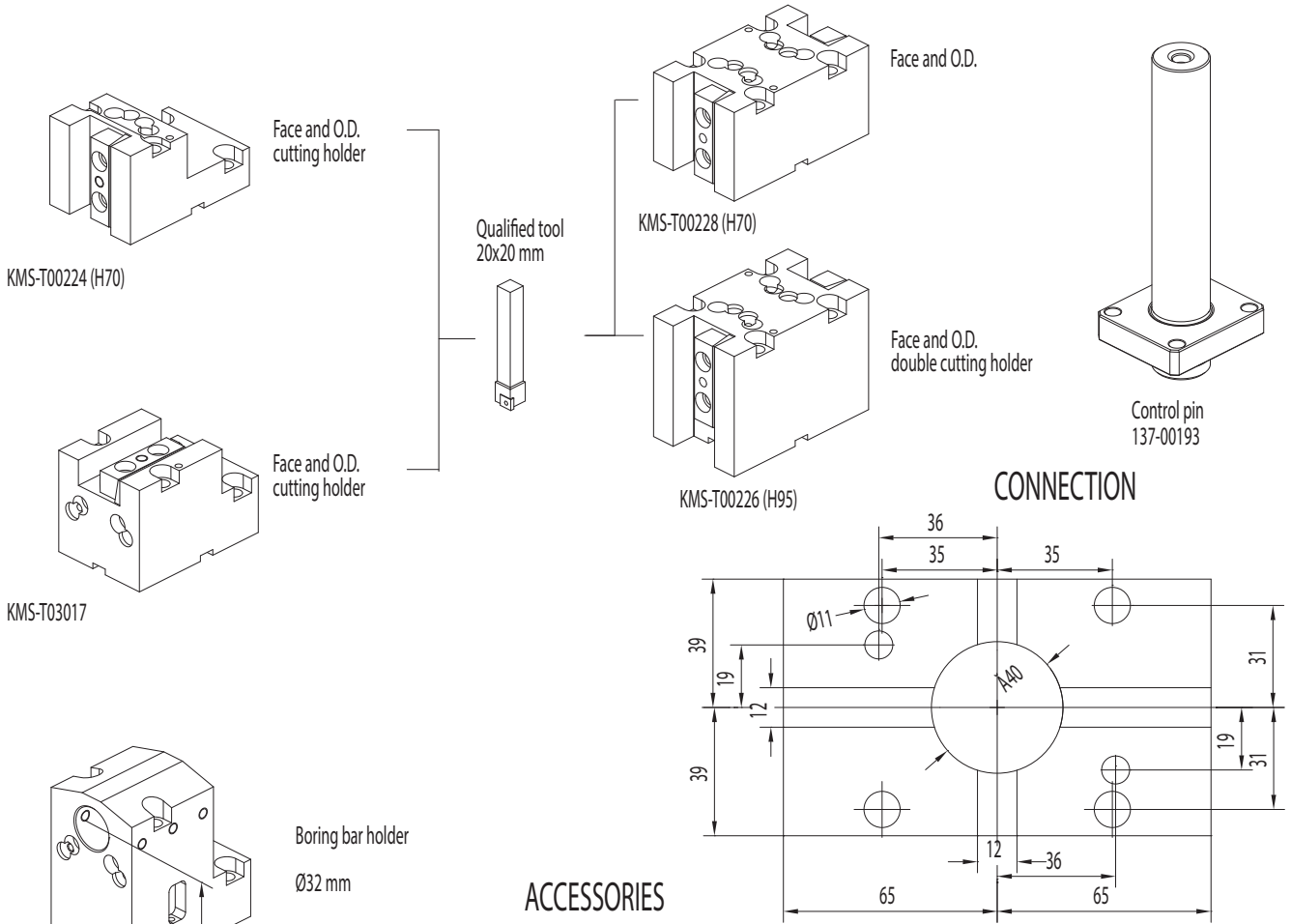

ACCESSORIES

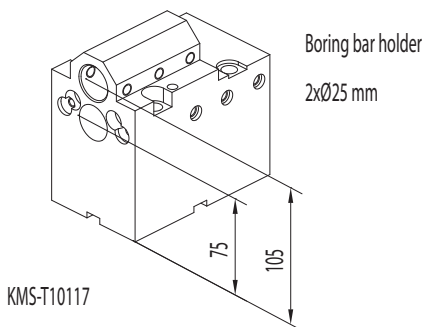
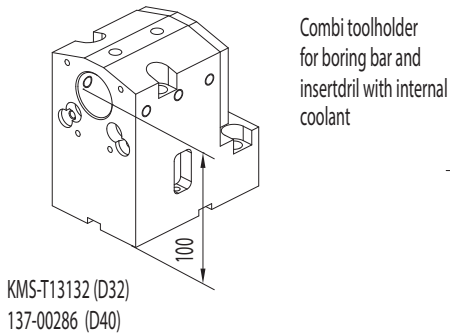
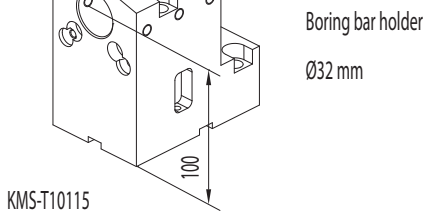

Boring bar sleeve D32

- KMS-T20122 (Ø25 mm)
- KMS-T20120 (Ø20 mm)
- KMS-T20118 (Ø16 mm)
- KMS-T20116 (Ø12 mm)
- KMS-T20114 (Ø10 mm)
- KMS-T20112 (Ø8 mm)

Boring bar sleeve D40

- KMS-T20098 (Ø32 mm)
- KMS-T20096 (Ø25 mm)
- KMS-T20094 (Ø20 mm)
- KMS-T20092 (Ø16 mm)
- KMS-T20090 (Ø12 mm)
- KMS-T20088 (Ø10 mm)
- KMS-T20086 (Ø8 mm)

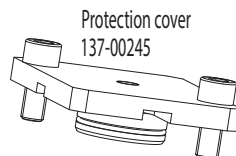

Driven tools

FAST-IN



124-04005
 124-04006 i.coolant

124-04007
 124-04008 i.coolant
 124-04009 i.coolant **80 BAR**

DMG MORI (BMT60)

NLX1500 (12 stazioni) - NLX2000
 NLX2500 - NLX3000 - NLX4000
 NL2000 (S)MC - 2500 (S)MC
 NL3000MC (12 STATIONS)
 NT3250 - NT4200 - NT4250
 NT4300 - NT5400 - NZL2500
 NT4000 - NT5000
 NZL 2000/2500
 NZX 2500 (station turret)
 NTX 2000/2500/3000
 2ND GEN. 10ST. - (TX2500 BMT60)

GOODWAY

G4/G5 200
 2600/280
 3000/3300
 3600
 GS2000 SERIES
 GS3000 SERIES
 GS4000 SERIES

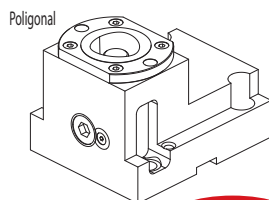
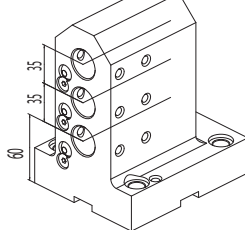
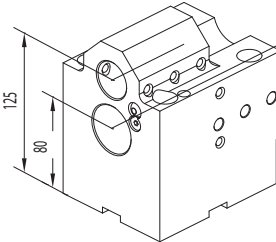
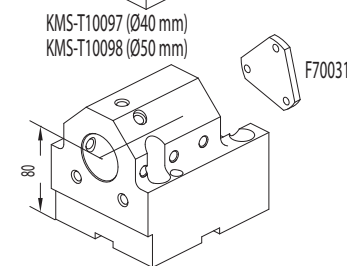
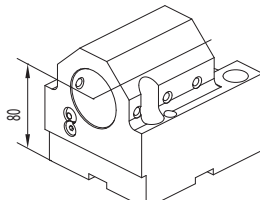
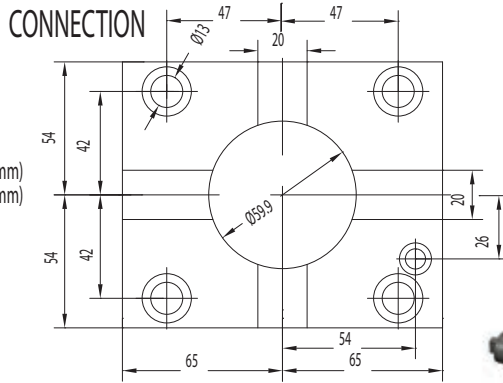
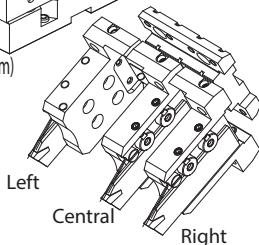
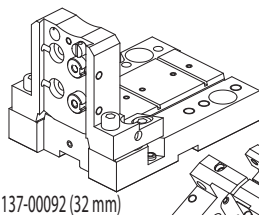
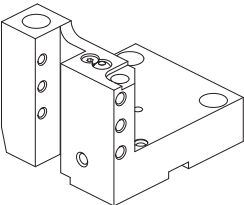
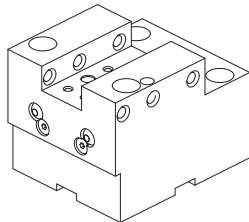
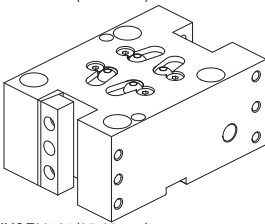
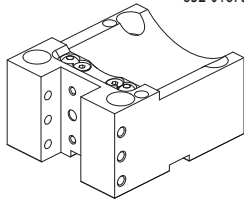
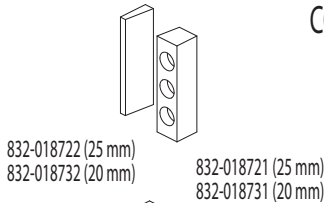

137-00241 (C40) **NEWS**
 137-00187 (C50)

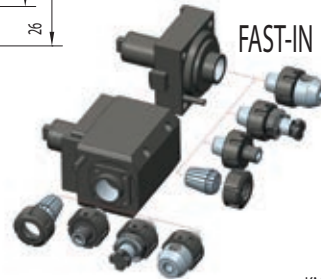

ACCESSORIES

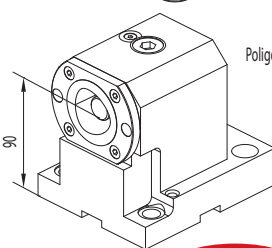
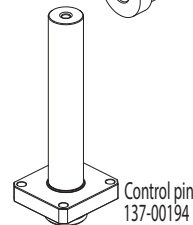
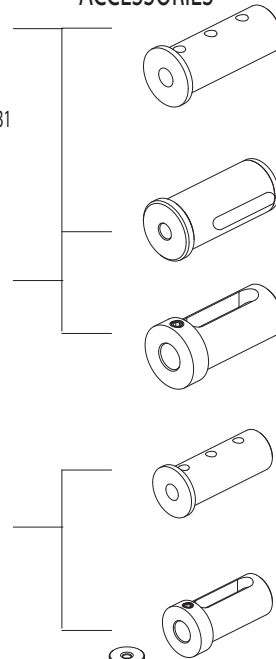

137-00242 (C40) **NEWS**
 137-00183 (C50)

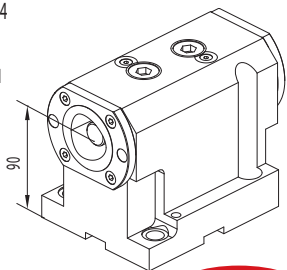

137-00243 (C40) **NEWS**
 137-00185 (C50)

DMG MORI

CL 200/203
SL 20/25
SL 203/204/250/253
SL 254 (MC, SMC)/2500Y
SL 203MC
SL 253MC
ZL 200MC
ZL 250SMC
SL 204SMC
SL 300MC

CMZ

TBI 520
TL 20/25
TC 15/20/25/30/35
TA 15M/Y/MS/MY/YS
TA 20M/Y/MS/MY/YS
TA 25M/Y/MS/MY/YS
TA 30M/Y/MS/MY/YS
TD 15/20/25/30/35/45
TD 55M/Y/MS/MY/YS

GOODWAY

GS 200/260/280
GA 2000/2600/2800
GA 3000/3300/3600

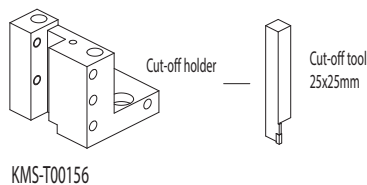
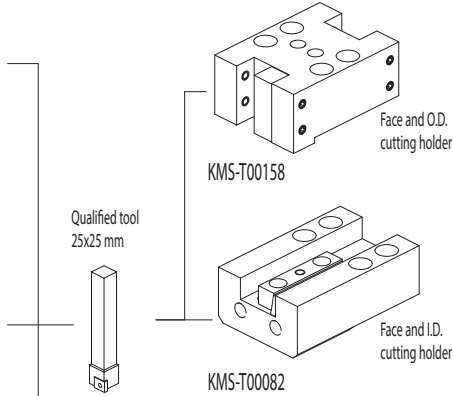
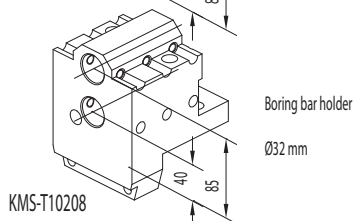
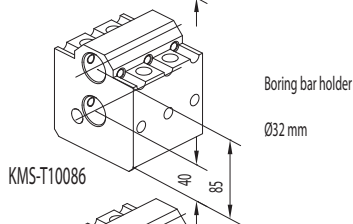
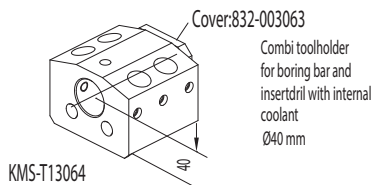
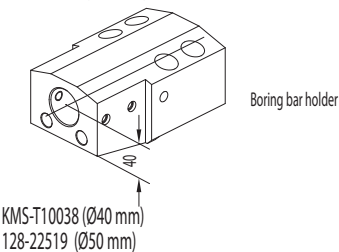
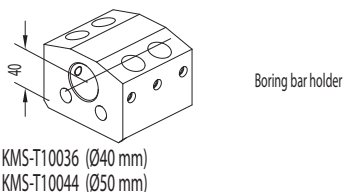
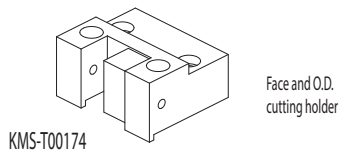
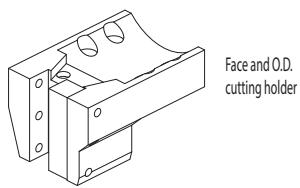
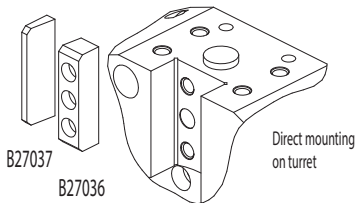

ACCESSORIES

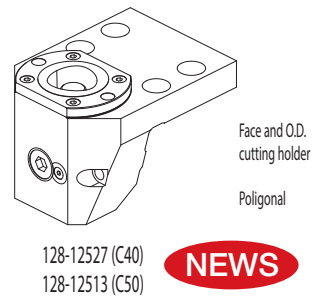
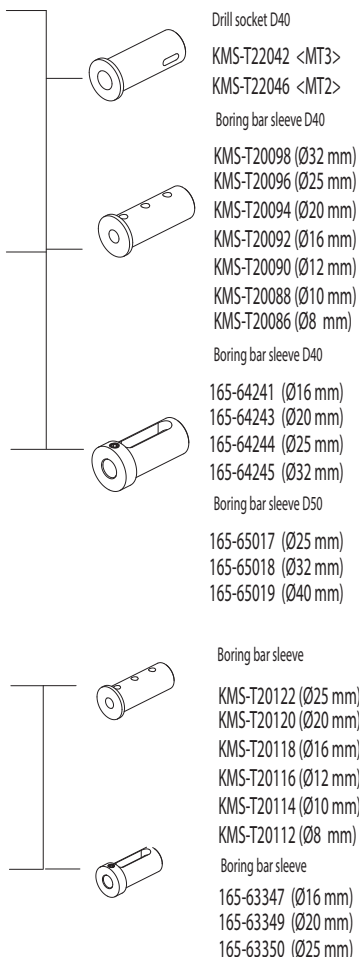

NEWS

Driven tools

FAST-IN



CONNECTION

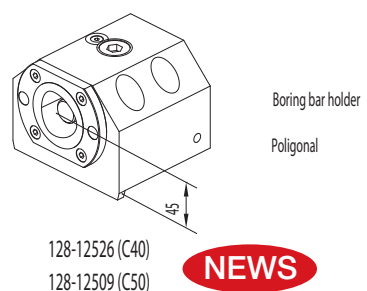
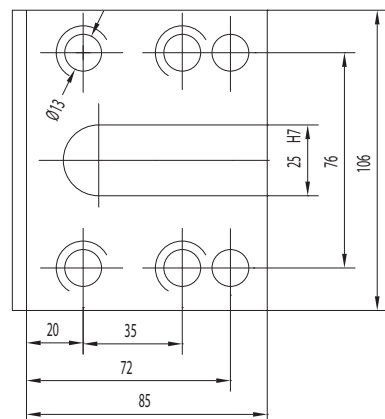

NEWS

DMG MORI

CMZ TL15

SL150
SL153
ZL150
CL150
SL154
SL153MC
ZL150MC
SL154MC

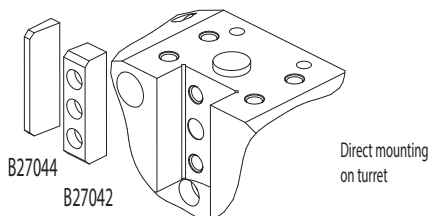

Direct mounting
on turret

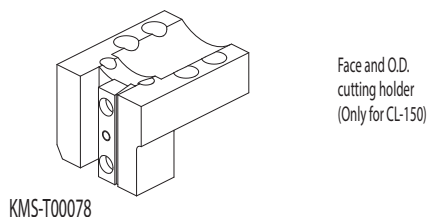

Face and O.D.
cutting holder
(Only for CL-150)

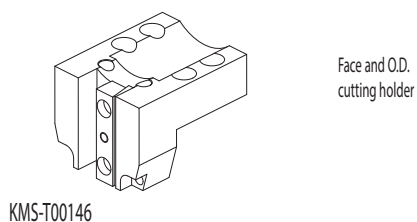

Face and O.D.
cutting holder

Qualified tool
20x20 mm

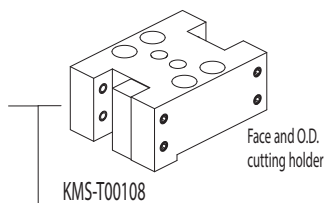

Face and O.D.
cutting holder

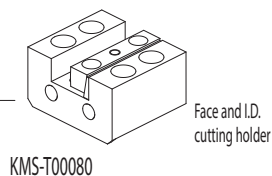

Face and I.D.
cutting holder

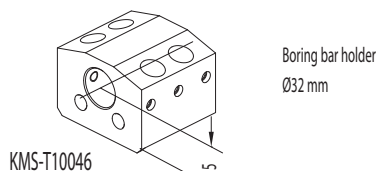

Boring bar holder
Ø32 mm

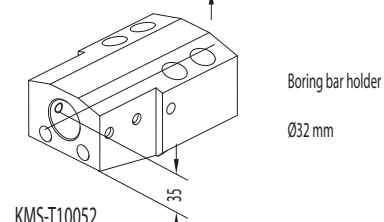

Boring bar holder
Ø32 mm

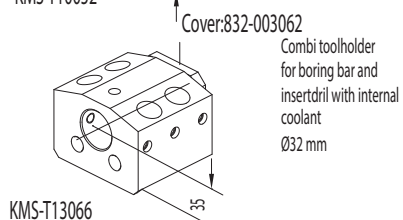

Cover: 832-003062

Combi toolholder
for boring bar and
insert/drill with internal
coolant
Ø32 mm

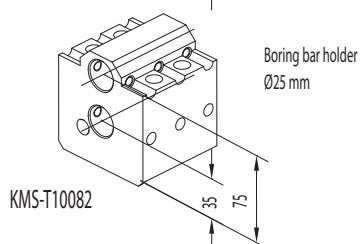

Boring bar holder
Ø25 mm

ACCESSORIES

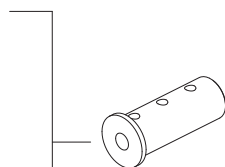

Boring bar sleeve

KMS-T20122 (Ø25 mm)
KMS-T20120 (Ø20 mm)
KMS-T20118 (Ø16 mm)
KMS-T20116 (Ø12 mm)
KMS-T20114 (Ø10 mm)
KMS-T20112 (Ø8 mm)

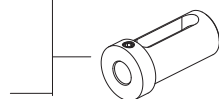

Boring bar sleeve

165-63347 (Ø16 mm)
165-63349 (Ø20 mm)
165-63350 (Ø25 mm)



Boring bar sleeve

165-62545 (Ø12 mm)
165-62547 (Ø16 mm)
165-62549 (Ø20 mm)

CONNECTION

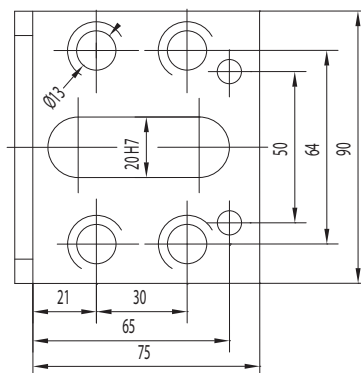

DMG MORI

CL 200/203
 SL 20/25
 SL 200/203/204/250
 253/254 (MC, SMD) - 2500Y
 ZL/DL 200/250 (MC)
 DURATURN 2030
 DURATURN 2050
 DURATURN 2550

GOODWAY

GS 200/260/280
 GA 2000/2600
 GA 2800/3000
 GA 3300/3600

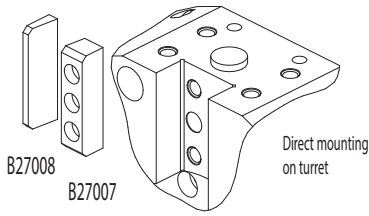

Direct mounting on turret

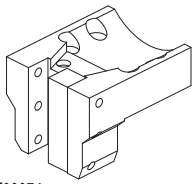

Face and O.D. cutting holder
 Also for machines
 CLB2000B-MT2000
 ZT2500-DURATURN2550

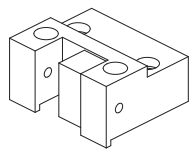

Face and O.D. cutting holder

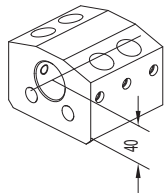

Boring bar holder

KMS-T10036 (Ø40 mm)
 KMS-T10044 (Ø50 mm)

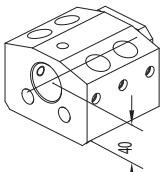

Combi toolholder for boring bar and insert drill with internal coolant

KMS-T13064 (Ø40 mm)
 128-22540 (Ø50 mm)

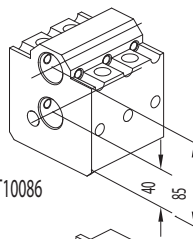

Boring bar holder

Ø32 mm

KMS-T10086

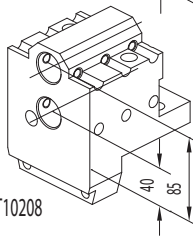

Boring bar holder

Ø32 mm

KMS-T10208

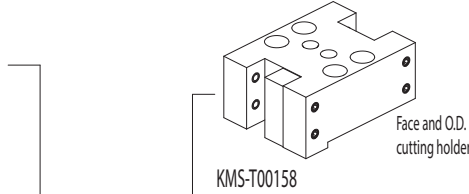

Face and O.D. cutting holder

KMS-T00158

Qualified tool 25x25 mm

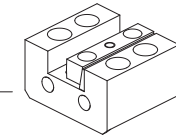

Face and I.D. cutting holder

KMS-T00068

Suitable also for machines
 CLB2000B-MT2000
 ZT2500-DURATURN2550

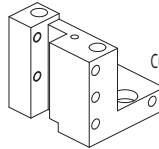

Cut-off holder

KMS-T00156

Suitable also for machines
 CLB2000B-MT2000
 ZT2500-DURATURN2550



Cut-off tool 25x25mm

ACCESSORIES

D40

Drill socket

- KMS-T22042 <MT3>
- KMS-T22046 <MT2>

Boring bar sleeve

- KMS-T20098 (Ø32 mm)
- KMS-T20096 (Ø25 mm)
- KMS-T20094 (Ø20 mm)
- KMS-T20092 (Ø16 mm)
- KMS-T20090 (Ø12 mm)
- KMS-T20088 (Ø10 mm)
- KMS-T20086 (Ø8 mm)

Boring bar sleeve

- 165-64241 (Ø16 mm)
- 165-64243 (Ø20 mm)
- 165-64244 (Ø25 mm)
- 165-64245 (Ø32 mm)

Boring bar sleeve

- KMS-T20122 (Ø25 mm)
- KMS-T20120 (Ø20 mm)
- KMS-T20118 (Ø16 mm)
- KMS-T20116 (Ø12 mm)
- KMS-T20114 (Ø10 mm)
- KMS-T20112 (Ø8 mm)

Boring bar sleeve

- 165-63347 (Ø16 mm)
- 165-63349 (Ø20 mm)
- 165-63350 (Ø25 mm)

CONNECTION

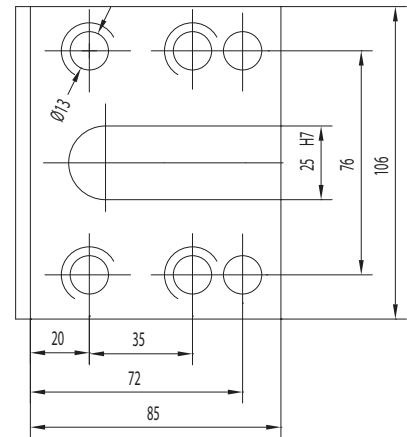

D50

- 165-65017 (Ø25 mm)
- 165-65018 (Ø32 mm)
- 165-65019 (Ø40 mm)

OKUMA LT10M (VDI30) LT200M LB10

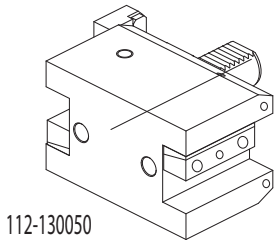

112-130050

Face and I.D.
cutting holder

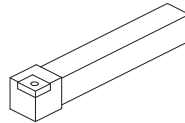

Qualified tool
20x20 mm

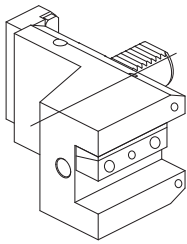

112-330080

Face and I.D.
cutting holder

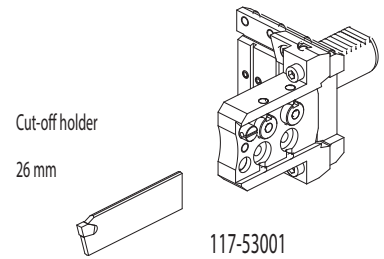

Cut-off holder
26 mm

117-53001

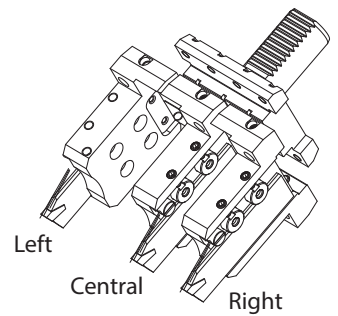

Left

Central

Right

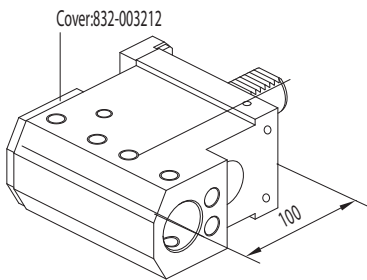

Cover:832-003212

115-230450

Combi toolholder
for boring bar and
insertdril with internal
coolant

Ø32 mm

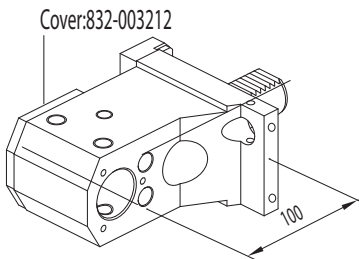

Cover:832-003212

115-230460

Combi toolholder
for boring bar and
insertdril with internal
coolant

Ø32 mm

ACCESSORIES

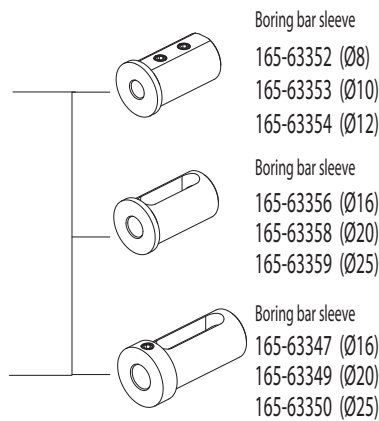

Boring bar sleeve

165-63352 (Ø8)

165-63353 (Ø10)

165-63354 (Ø12)

Boring bar sleeve

165-63356 (Ø16)

165-63358 (Ø20)

165-63359 (Ø25)

Boring bar sleeve

165-63347 (Ø16)

165-63349 (Ø20)

165-63350 (Ø25)

OKUMA (VDI40)

LT15M
LT300M
MT250
LB300
LB300M
LV300

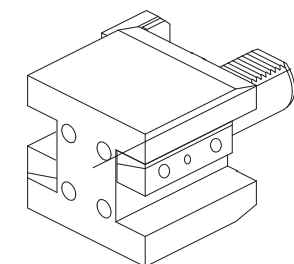

112-14009

Face and O.D.
cutting holder

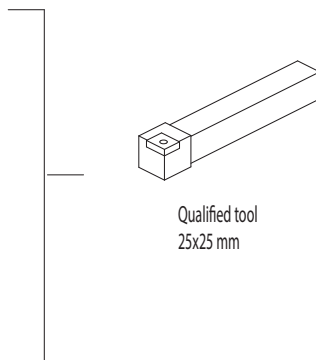

Qualified tool
25x25 mm

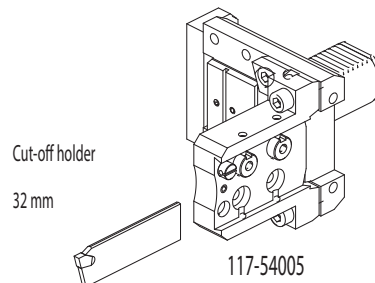

Cut-off holder
32 mm

117-54005

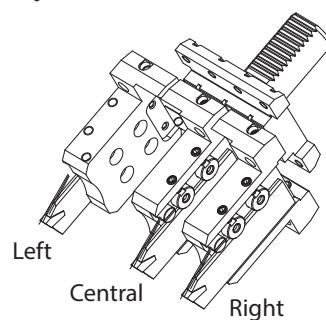

Left

Central

Right

Cover:832-003104

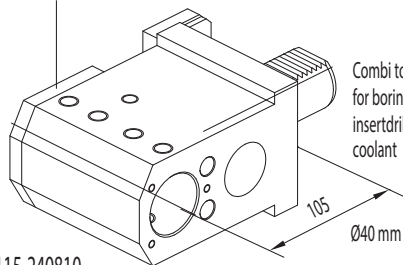

115-240810

Combi toolholder
for boring bar and
insertdrill with internal
coolant

105
Ø40 mm

ACCESSORIES

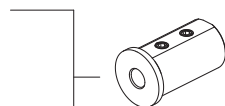

Boring bar sleeve
165-64247 (Ø8)
165-64248 (Ø10)
165-64249 (Ø12)

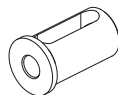

Boring bar sleeve
165-64251 (Ø16)
165-64253 (Ø20)
165-64254 (Ø25)
165-64255 (Ø32)

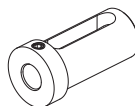

Boring bar sleeve
165-64241 (Ø16)
165-64243 (Ø20)
165-64244 (Ø25)
165-64245 (Ø32)

Cover:832-003104

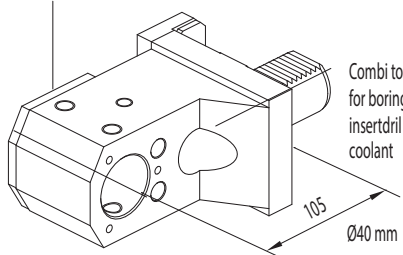

115-240700

Combi toolholder
for boring bar and
insertdrill with internal
coolant

105
Ø40 mm

OKUMA

LB15
LB25
LB15II
LB300

HAAS

SL20 - SL30
ST-20 - ST-25
ST-30 - ST-35
DS-30

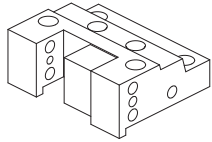

128-420110

Face and O.D.
cutting holder

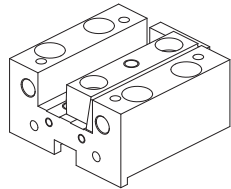

128-32001

Face and I.D.
cutting holder

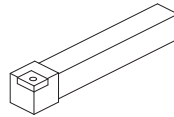

Qualified tool
25x25 mm

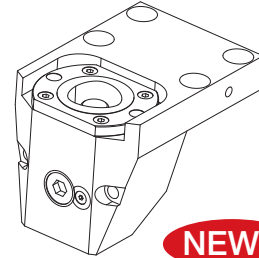

128-12072 (C40)
128-12059 (C50)

Face and O.D.
cutting holder
Polygonal

NEWS

CONNECTION

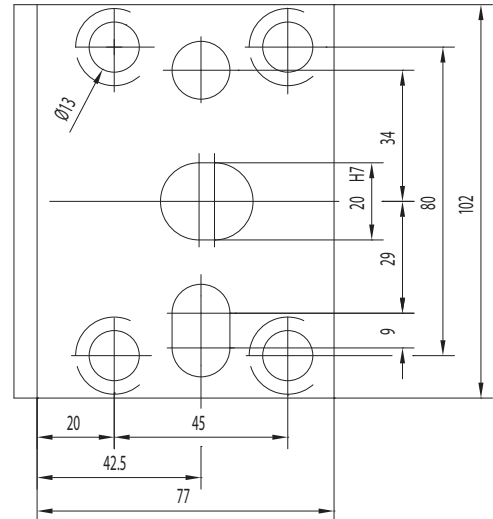

ACCESSORIES

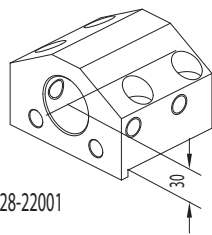

128-22001

Toolholder
for boring bar
 $\varnothing 40$ mm

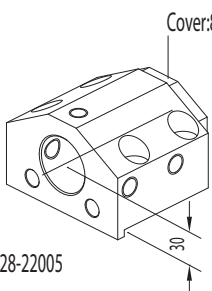

128-22005

Cover: 832-003056

Combi toolholder
for boring bar and
insertdrill with internal
coolant
 $\varnothing 40$ mm

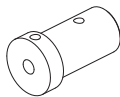

Boring bar sleeve and
throw-away drill socket

165-64013 ($\varnothing 10$)
165-64014 ($\varnothing 12$)
165-64015 ($\varnothing 16$)
165-64016 ($\varnothing 20$)

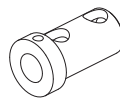

Boring bar sleeve and
throw-away drill socket

165-64017 ($\varnothing 25$)
165-64018 ($\varnothing 32$)

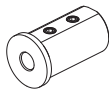

Boring bar sleeve
165-64247 ($\varnothing 8$)
165-64248 ($\varnothing 10$)
165-64249 ($\varnothing 12$)

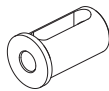

Boring bar sleeve
165-64251 ($\varnothing 16$)
165-64253 ($\varnothing 20$)
165-64254 ($\varnothing 25$)
165-64255 ($\varnothing 32$)

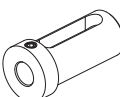

Boring bar sleeve
165-64241 ($\varnothing 16$)
165-64243 ($\varnothing 20$)
165-64244 ($\varnothing 25$)
165-64245 ($\varnothing 32$)

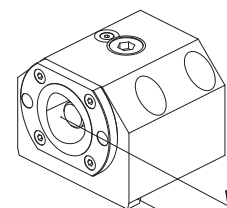

128-12071 (C40)
128-12057 (C50)

Boring bar holder
Polygonal

NEWS

OKUMA (BMT60)

LB2000 EX (M)
 LB2500 EX (M)
 LB3000 EX (M, MY)
 LT2000 EX
 LT3000 EX
 LB3000 EX (MW, MYW)

LU2000 EX
 LU2500 EX
 LU3000 EX (M, MW, MY)
 GENOS L300 (MY, MW, MYW)

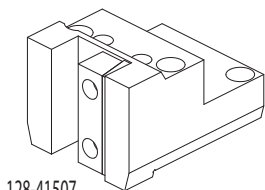

128-41507

Face and O.D.
cutting holder

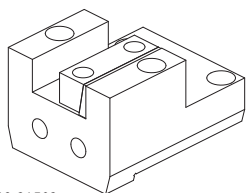

128-31503

Face and I.D.
cutting holder

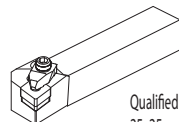

Qualified tool
25x25 mm

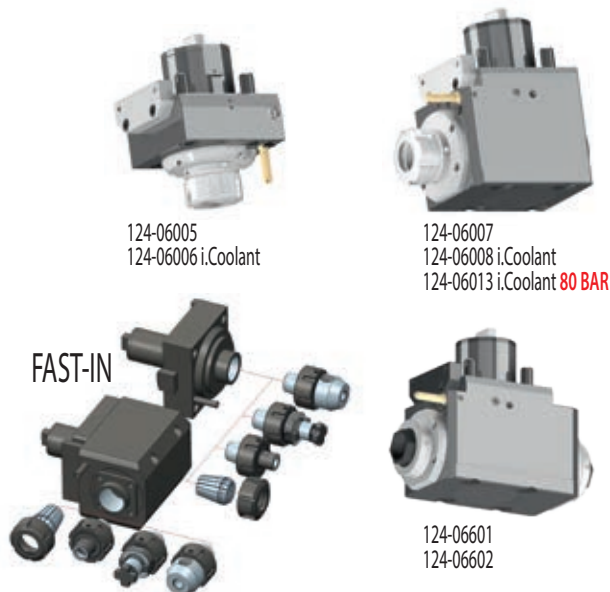

124-06005
124-06006 i.Coolant

124-06007
124-06008 i.Coolant
124-06013 i.Coolant **80 BAR**

124-06601
124-06602

ACCESSORIES

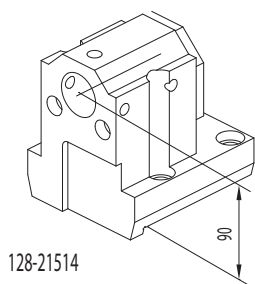

128-21514

Combi toolholder
for boring bar and
insert drill
Ø32 mm

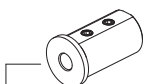

Boring bar sleeve
165-63352 (Ø8)
165-63353 (Ø10)
165-63354 (Ø12)

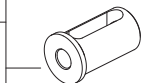

Boring bar sleeve
165-63356 (Ø16)
165-63358 (Ø20)
165-63359 (Ø25)



Boring bar sleeve
165-63347 (Ø16)
165-63349 (Ø20)
165-63350 (Ø25)

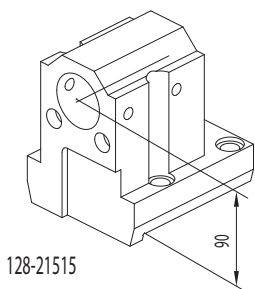

128-21515

Toolholder
for boring bar
Ø40 mm



Throw-away drill socket
165-64205 (Ø25)
165-64206 (Ø32)

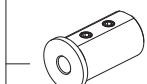

Boring bar sleeve
165-64247 (Ø8)
165-64248 (Ø10)
165-64249 (Ø12)

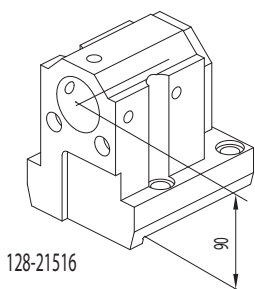

128-21516

Combi toolholder
for boring bar and
insert drill
Ø40 mm

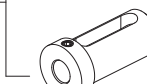

Boring bar sleeve
165-64241 (Ø16)
165-64243 (Ø20)
165-64244 (Ø25)
165-64245 (Ø32)

CONNECTION

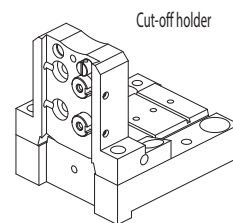
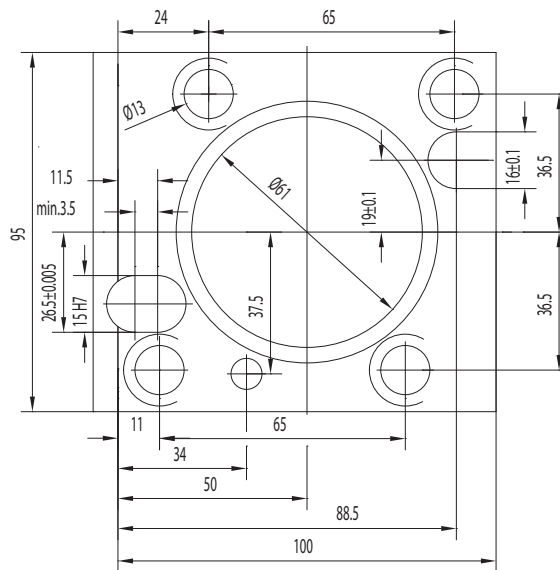

128-11535 (h=32 mm)
128-11534 (h=26 mm)

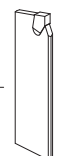

Cut-off tool
32 mm
26 mm

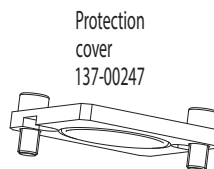

Protection cover
137-00247

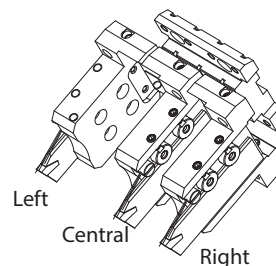

Left
Central
Right

OKUMA LB3000 EX (MW, MYW) (BMT60)

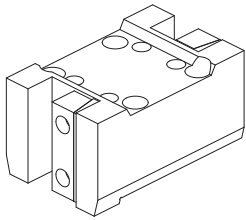

128-41509

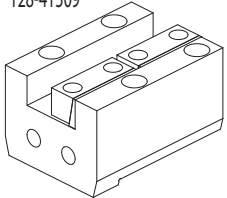

128-31505

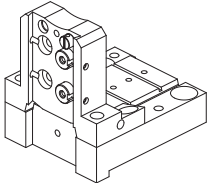

128-11535 (h=32 mm)

Face and O.D. cutting holder

Face and I.D. cutting holder

Cut-off holder

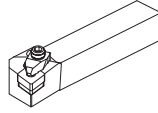

Qualified tool
25x25 mm

Cut-off tool
32 mm
26 mm

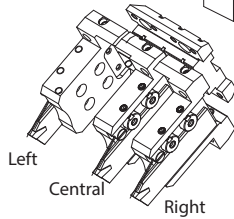

Left

Central

Right

Toolholder for boring bar

Ø40 mm

Combi toolholder for boring bar and insertdrill

Ø40 mm

Double toolholder for boring bar

Ø40 mm

Double combi toolholder for boring bar and insertdrill

Ø40 mm

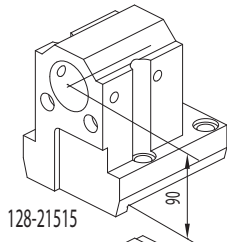

128-21515

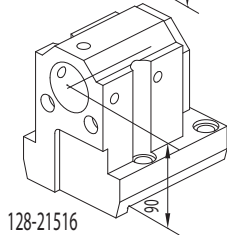

128-21516

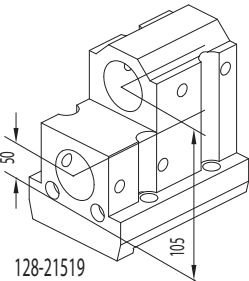

128-21519

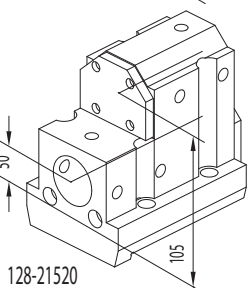

128-21520



124-06005
124-06006 i.Coolant



124-06007
124-06008 i.Coolant
124-06013 i.Coolant **80 BAR**

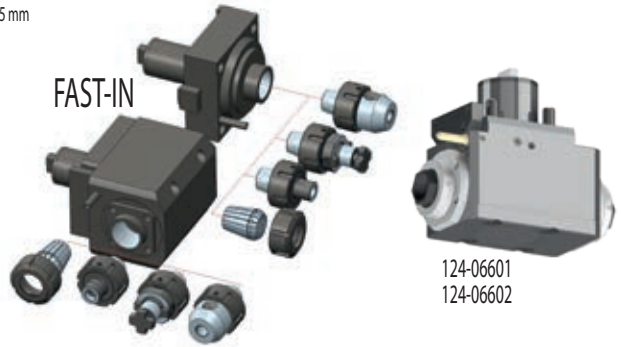

FAST-IN

124-06601
124-06602

CONNECTION

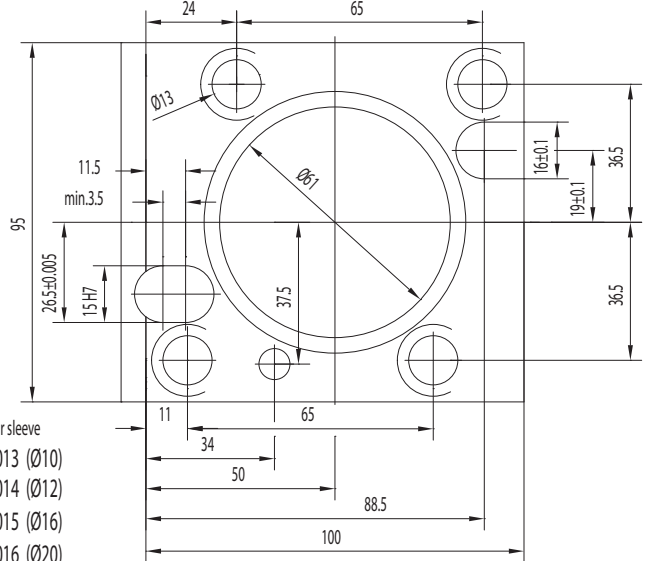

ACCESSORIES

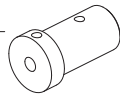

Boring bar sleeve
165-64013 (Ø10)
165-64014 (Ø12)
165-64015 (Ø16)
165-64016 (Ø20)

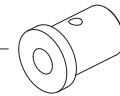

Throw-away drill socket
165-64205 (Ø25)
165-64206 (Ø32)

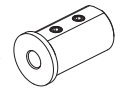

Boring bar sleeve
165-64247 (Ø8)
165-64248 (Ø10)
165-64249 (Ø12)



Boring bar sleeve
165-64251 (Ø16)
165-64253 (Ø20)
165-64254 (Ø25)
165-64255 (Ø32)

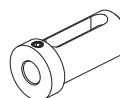

Boring bar sleeve
165-64241 (Ø16)
165-64243 (Ø20)
165-64244 (Ø25)
165-64245 (Ø32)



Control pin
137-00195



Protection cover
137-00247

OKUMA LB4000 EX (M, MY) (BMT60)

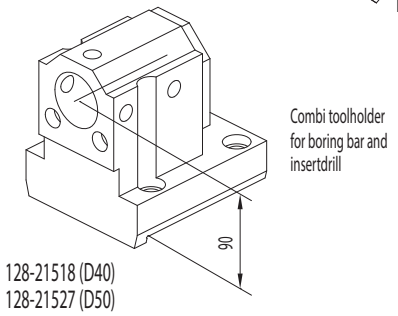
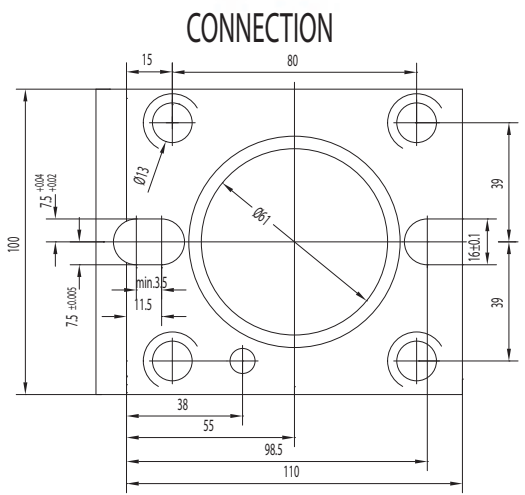
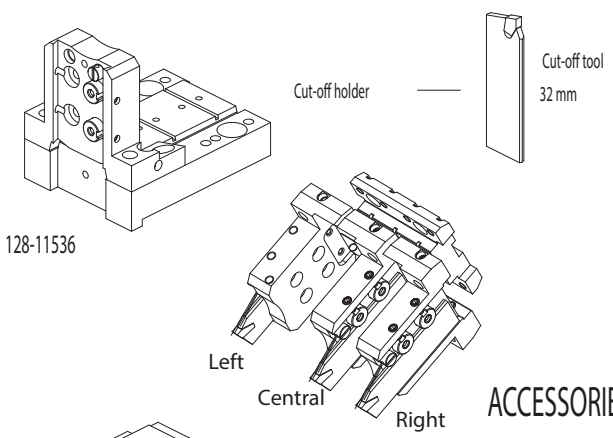
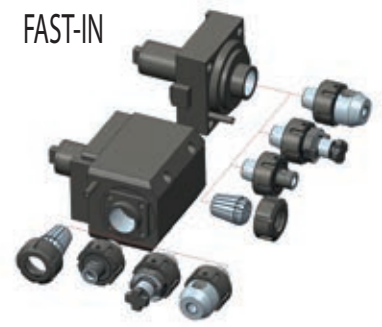
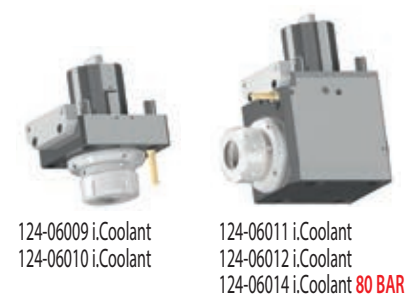
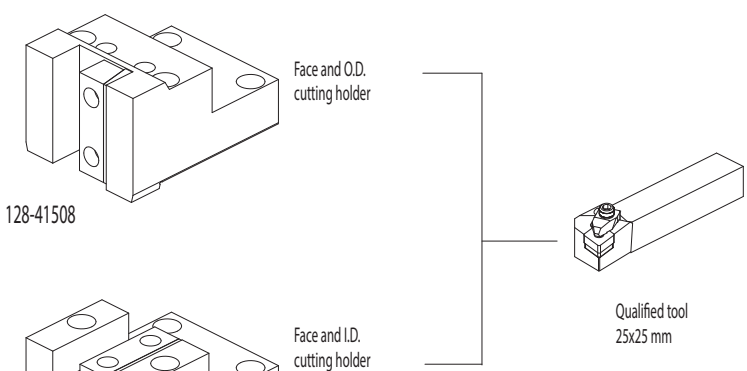

ACCESSORIES

- Boring bar sleeve D40
165-64013 (Ø10)
165-64014 (Ø12)
165-64015 (Ø16)
165-64016 (Ø20)
- Throw-away drill socket D40
165-64205 (Ø25)
165-64206 (Ø32)
- Boring bar sleeve D40
165-64247 (Ø8)
165-64248 (Ø10)
165-64249 (Ø12)
- Boring bar sleeve D40
165-64251 (Ø16)
165-64253 (Ø20)
165-64254 (Ø25)
165-64255 (Ø32)
- Boring bar sleeve
165-64241 (D40/Ø16)
165-64243 (D40/Ø20)
165-64244 (D40/Ø25)
165-64245 (D40/Ø32)
165-65017 (D50/Ø25)
165-65018 (D50/Ø32)
165-65019 (D50/Ø40)

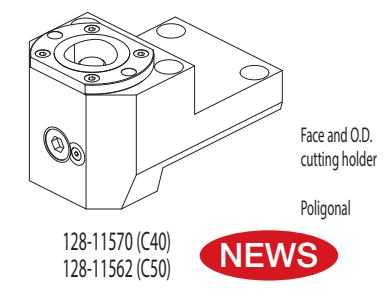
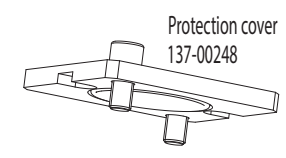
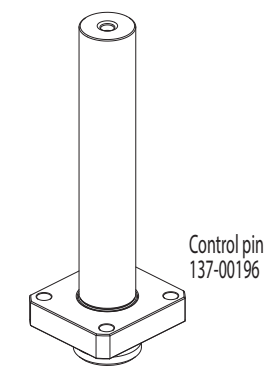

NEWS

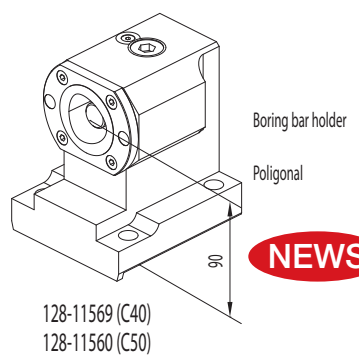

NEWS

NAKAMURA TOME (BMT44)

NTY3/ SUPER NTMX/NTMXL / WT100
MURATA MURATEC MT100
WY-100II / NTJ100

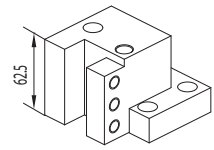

C21410

Face and O.D. cutting holder

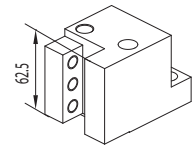

C21420

Face and O.D. cutting holder

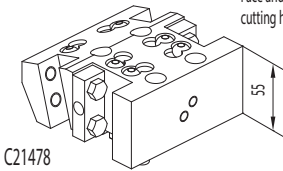

C21478

Face and O.D. cutting holder



Protection cover
137-00251

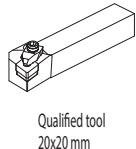

Qualified tool
20x20 mm

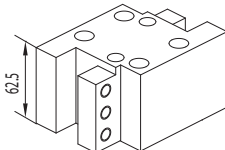

C21416

Face and O.D. cutting holder

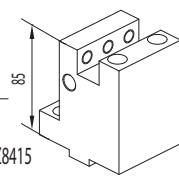

Z8415

Face and I.D. cutting holder



124-04401
124-04402 i.Coolant

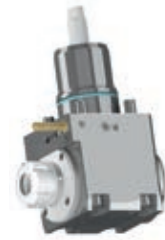

124-04403
124-04404 i.Coolant
124-04405 i.Coolant 80 BAR

FAST-IN

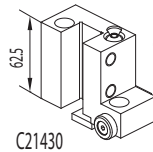

C21430

Cut-off holder



Cut-off tool
20x20 mm

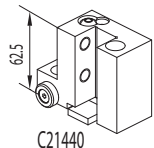

C21440

Cut-off holder

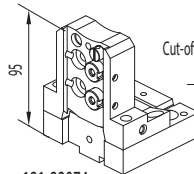

121-22074

Cut-off holder



Cut-off tool
26 mm

ACCESSORIES

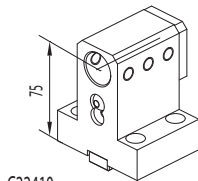

C22410

Toolholder for boring bar

Ø25 mm

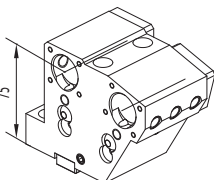

C22412

Double toolholder for boring bar

Ø25 mm

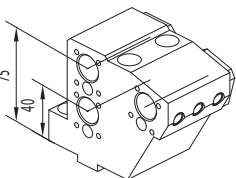

121-22071

Treble toolholder for boring bar

Ø20 mm

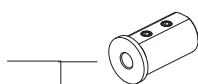

Boring bar sleeve

- 165-62551 (Ø8)
- 165-62552 (Ø10)
- 165-62553 (Ø12)

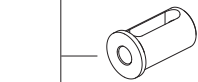

Boring bar sleeve

- 165-62555 (Ø16)

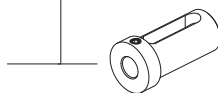

Boring bar sleeve

- 165-62545 (Ø12)
- 165-62547 (Ø16)
- 165-62549 (Ø20)

CONNECTION

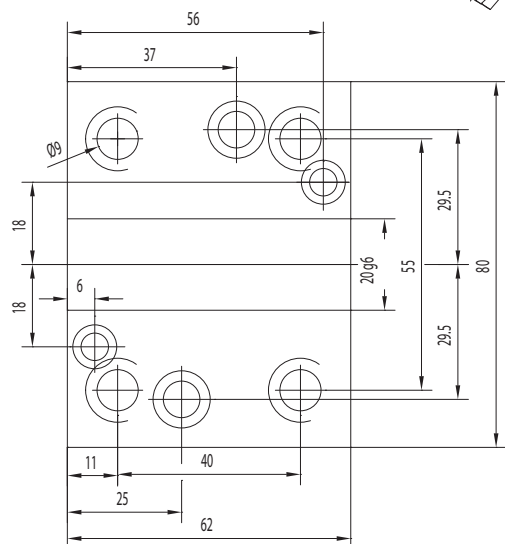

NAKAMURA TOME (BMT55)

AS-200 / NTM 3 / NTY3-250
 SC-150M / SC-200MY / SC-250M / SuperNTJ
 TMC-20 II M/ML / TW-10 / TW-20
 WT-20 II M/MY / WT150/200 / WT-250
 WTS-150 / WTW-150/160 / WT200 II (M,MY)
 WY-250 / CMZ TX52/66
 SUPER NTJ/NTM3 / SC150/250

CMZ TX52/66

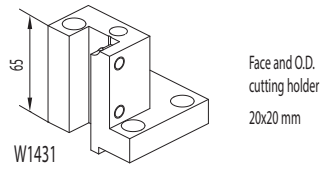

W1431

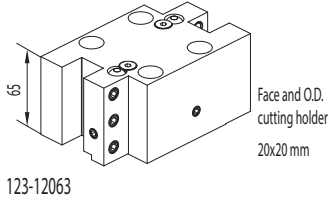

123-12063

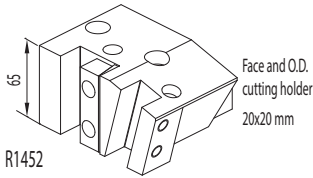

R1452

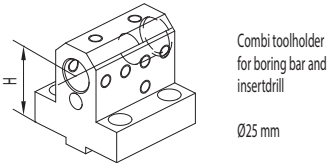

W1417 D25 (H=55 mm)
 W4437 D25 (H=75 mm)
 G1417 D25 (H=85 mm)

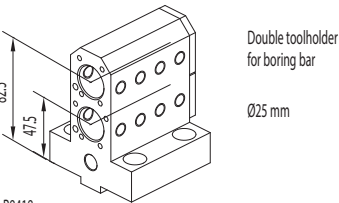

R8418

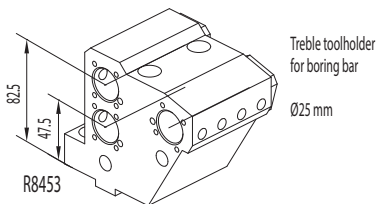

R8453

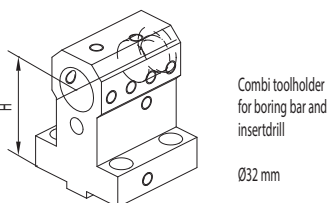

W1417 D32 (H=55 mm)
 Z2417 D32 (H=70 mm)
 Z7417 D32 (H=80 mm)

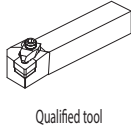

Qualified tool

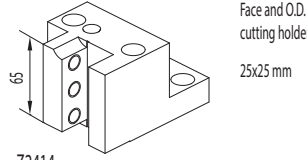

Z2414

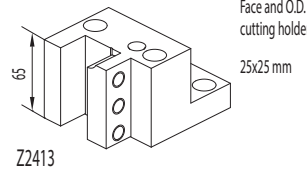

Z2413

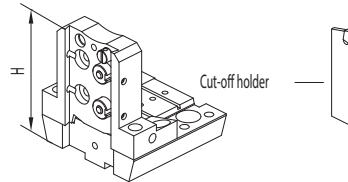

121-22076 (h=32 mm H=100 mm)

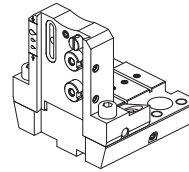

121-22076-1C i.Coolant

ACCESSORIES

Boring bar sleeve D25
 165-62551 (Ø8)
 165-62552 (Ø10)
 165-62553 (Ø12)

Boring bar sleeve D32
 165-63352 (Ø8)
 165-63353 (Ø10)
 165-63354 (Ø12)

Boring bar sleeve D25
 165-62555 (Ø16)

Boring bar sleeve D32
 165-63356 (Ø16)
 165-63358 (Ø20)
 165-63359 (Ø25)

Boring bar sleeve D25
 165-62545 (Ø12)
 165-62547 (Ø16)
 165-62549 (Ø20)

Boring bar sleeve D32
 165-63347 (Ø16)
 165-63349 (Ø20)
 165-63350 (Ø25)

Boring bar sleeve D25
 115-62573 (Ø6)
 115-62538 (Ø8)
 115-62539 (Ø10)
 115-62540 (Ø12)

Boring bar sleeve D25
 115-62541 (Ø16)

Protection cover
 137-00249

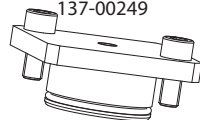

FAST-IN



124-05507
 124-05508 i.Coolant



124-05509
 124-05510 i.Coolant
 124-05517 i.Coolant 80 BAR

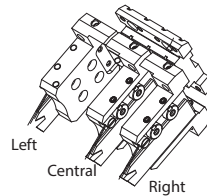

CONNECTION

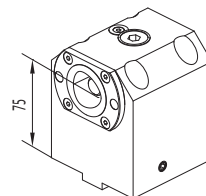
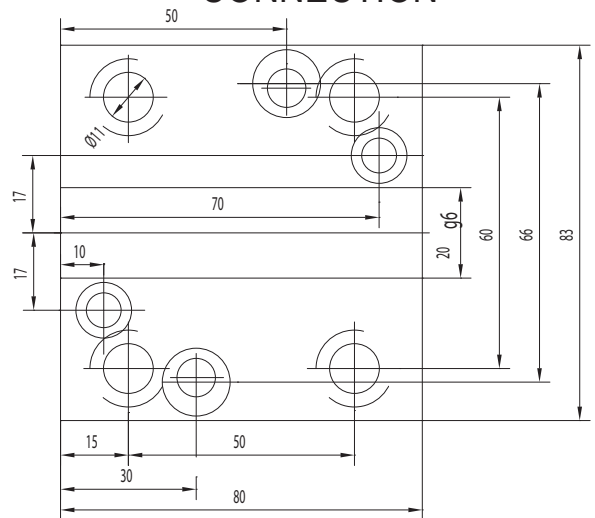

121-22098

NEWS

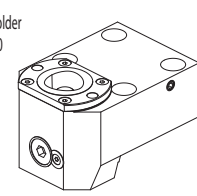

121-22099

NEWS

NAKAMURA TOME (BMT55)

AS-200 / NTM 3 / NTY3-250
 SC-150M / SC-200MY / SC-250M
 SuperNTJ / TMC-20 II M/ML
 TW-10 / TW-20 / WT-20 II M/MY
 WT150/200 / WT-250 / WTS-150
 WTW-150/160 / WT200 II (M,MY)
 WY-250

CMZ CMZ TX52/66 / SUPER NTJ
 NTM3 / SC150/250
 TX52 Y3-Y2 QUATTRO-Y2 TW IN
 TX66 Y3-Y2 QUATTRO-Y2 TW IN
 TTL 52 / TTL 66
 TA15-20-25-30M/Y/MS/MY/YS 15ST

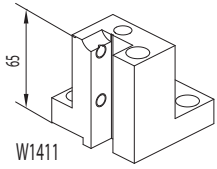

W1411

Face and O.D. cutting holder

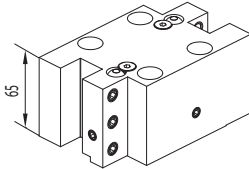

123-12063

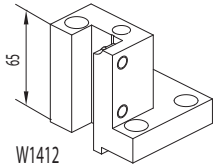

W1412

Face and O.D. cutting holder

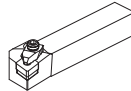

Qualified tool
20x20 mm

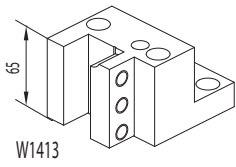

W1413

Face and O.D. cutting holder

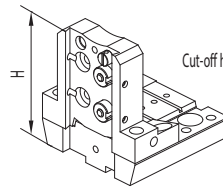

121-22076 (h=32 mm H=100 mm)

Cut-off holder



Cut-off tool

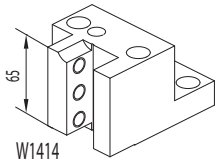

W1414

Face and O.D. cutting holder

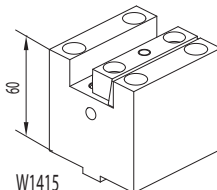

W1415

Face and I.D. cutting holder

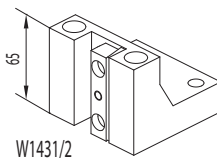

W1431/2

Face and O.D. cutting holder

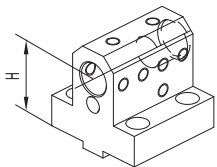

W1417 D25 (H=55 mm)
W4437 D25 (H=75 mm)

Combi toolholder for boring bar and insertdrill
Ø25 mm

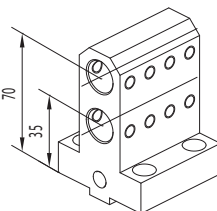

W1418 D25

Double toolholder for boring bar
Ø25 mm



Boring bar sleeve
165-62551 (Ø8)
165-62552 (Ø10)
165-62553 (Ø12)



Boring bar sleeve
165-62555 (Ø16)

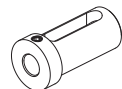

Boring bar sleeve
165-62545 (Ø12)
165-62547 (Ø16)
165-62549 (Ø20)



Boring bar sleeve
115-62573 (Ø6)
115-62538 (Ø8)
115-62539 (Ø10)
115-62540 (Ø12)



Boring bar sleeve
115-62541 (Ø16)



124-05507
124-05508 I.Coolant



124-05509
124-05510 I.Coolant

FAST-IN

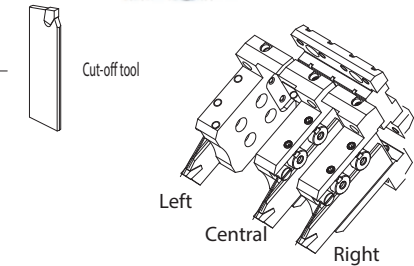
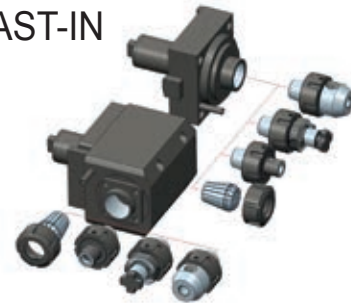

Left

Central

Right

ACCESSORIES

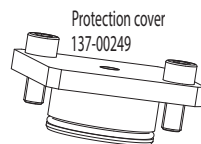

Protection cover
137-00249

CONNECTION

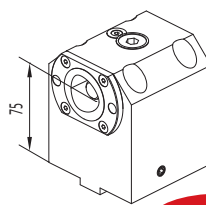
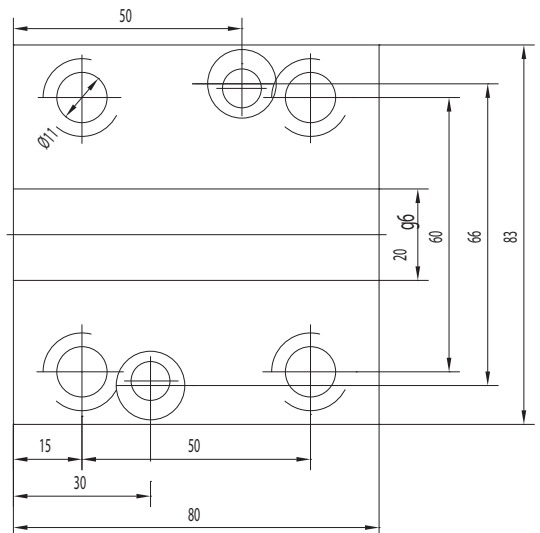

121-22098

NEWS

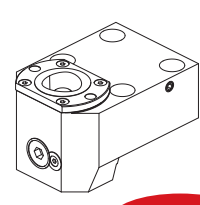

121-22099

NEWS

Face and O.D. cutting holder
Poligonal C40

Face and O.D. cutting holder
Poligonal C40

DOOSAN PUMA 230M/MS 240M/MS

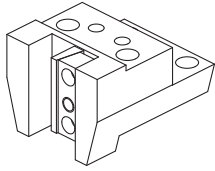

128-41501

Face and O.D.
cutting holder

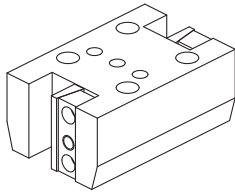

128-41502

Face and O.D.
cutting holder

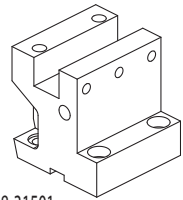

128-31501

Face and I.D.
cutting holder

Qualified tool
25x25 mm



Cut-off holder

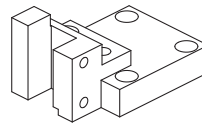

128-41503

Cut-off tool
25x25 mm

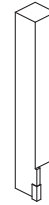

ACCESSORIES

Drill socket

- 114-34012 <MT1>
- 114-34013 <MT2>
- 114-34014 <MT3>

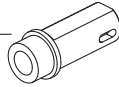

Boring bar sleeve

- 165-64089 (Ø10)
- 165-64090 (Ø12)
- 165-64091 (Ø16)

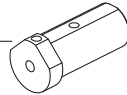

Boring bar sleeve

- 165-64092 (Ø20)
- 165-64093 (Ø25)
- 165-64094 (Ø32)

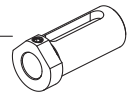

Throw-away drill socket

- 165-64095 (Ø20)
- 165-64096 (Ø25)

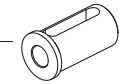

Boring bar sleeve

- 165-64247 (Ø8)
- 165-64248 (Ø10)
- 165-64249 (Ø12)

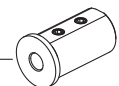

Boring bar sleeve

- 165-64251 (Ø16)
- 165-64253 (Ø20)
- 165-64254 (Ø25)
- 165-64255 (Ø32)

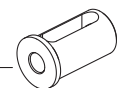

Boring bar sleeve

- 165-64241 (Ø16)
- 165-64243 (Ø20)
- 165-64244 (Ø25)
- 165-64245 (Ø32)

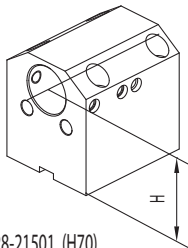
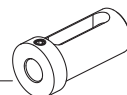

Boring bar holder
Ø40 mm

128-21501 (H70)
128-21521 (H60)

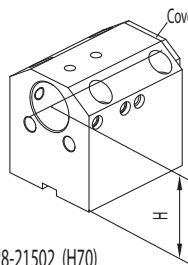

Combi toolholder
for boring bar and
insertdrill with internal
coolant
Ø40 mm

128-21502 (H70)
128-21522 (H60)

CONNECTION

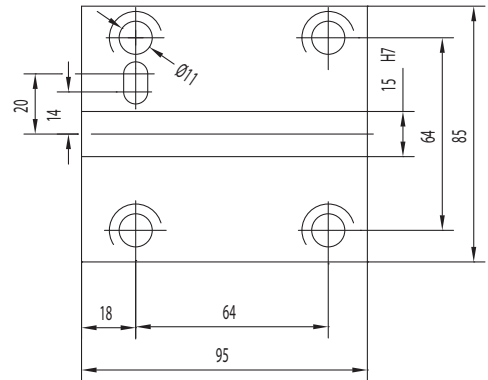

DOOSAN PUMA

230S
240S
LYNX210

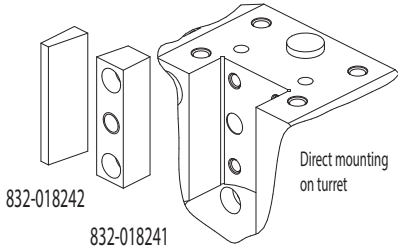

Qualified tool
25x25 mm



Face and I.D.
cutting holder

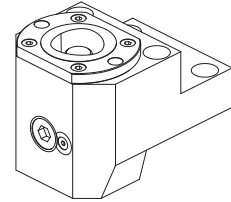
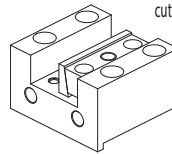

Face and O.D.
cutting holder
Polygonal

NEWS

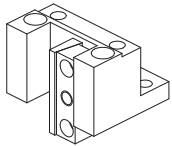

Face and O.D.
cutting holder

ACCESSORIES

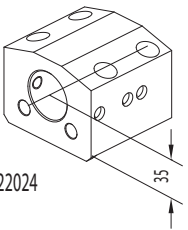

Boring bar holder
Ø40 mm

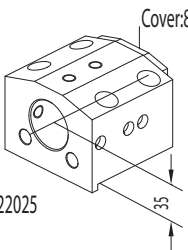

Combi toolholder
for boring bar and
insert drill with internal
coolant
Ø40 mm

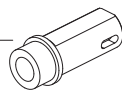

Drill socket
114-34012 <MT1>
114-34013 <MT2>
114-34014 <MT3>

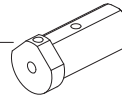

Boring bar sleeve
165-64089 (Ø10)
165-64090 (Ø12)
165-64091 (Ø16)

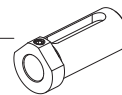

Boring bar sleeve
165-64092 (Ø20)
165-64093 (Ø25)
165-64094 (Ø32)

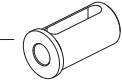

Throw-away drill socket
165-64095 (Ø20)
165-64096 (Ø25)

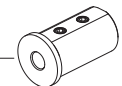

Boring bar sleeve
165-64247 (Ø8)
165-64248 (Ø10)
165-64249 (Ø12)

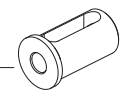

Boring bar sleeve
165-64251 (Ø16)
165-64253 (Ø20)
165-64254 (Ø25)
165-64255 (Ø32)

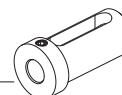

Boring bar sleeve
165-64241 (Ø16)
165-64243 (Ø20)
165-64244 (Ø25)
165-64245 (Ø32)

CONNECTION

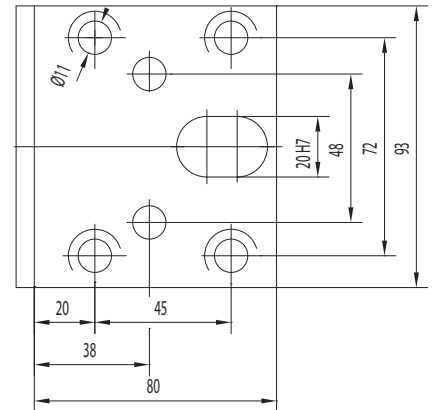

DOOSAN (BMT45)

LYNX 2100LYA/LYB (24 POSITION INDEX)
 LYNX 2100MA/220 (LMSA,LMSC)
 220 (LSYA,LSYC), 220 (M,LM)
 LYNX 220 (MA,LMA,MC,LMC)
 220 (YA,YC,LYA,LYC)
 PUMA MX1600 (T,ST)

HARDINGE BMT45
SMEC PL1600 (M,CM)

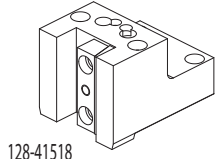

128-41518

Face and O.D. cutting holder

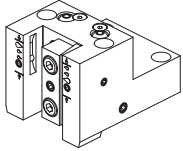

128-41518-IC

I.Coolant

Face and O.D. cutting holder

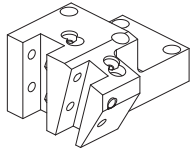

128-41519

Face and O.D. cutting holder

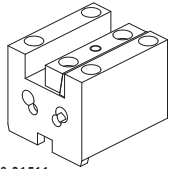

128-31511

Face and O.D. cutting holder

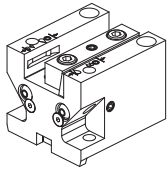

128-31511-IC

I.Coolant

Face and O.D. cutting holder



Protection cover
137-00252

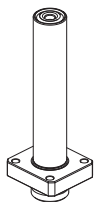

Control pin
137-00197

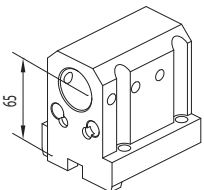

128-21529

Toolholder for boring bar

Ø32 mm

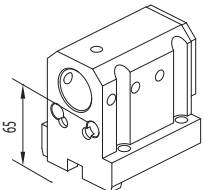

128-21530 (D32)
128-21547 (D40)

Combi toolholder

for boring bar and insertdrill

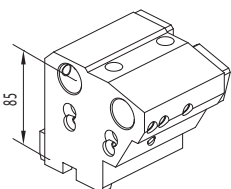

128-21531

Combi toolholder for boring bar

2xØ25 mm

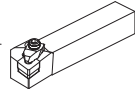

Qualified tool
20x20 mm

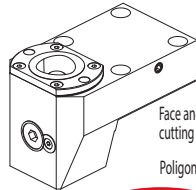

128-11572

NEWS

NEWS



124-04501
124-04502 I.Coolant

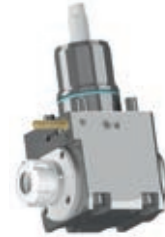

124-04503
124-04504 I.Coolant

FAST-IN

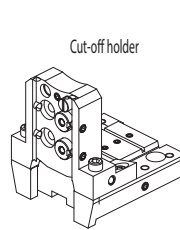
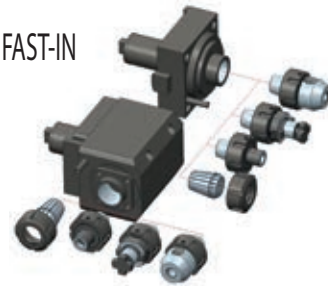

128-11546

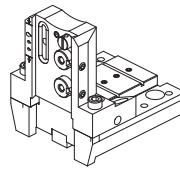

128-11546-IC

Cut-off tool
26 mm

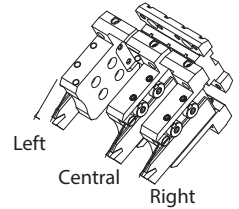

CONNECTION

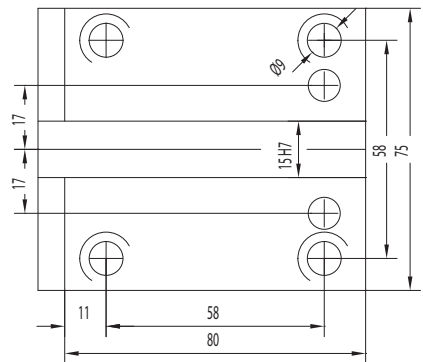

ACCESSORIES

D32

Drill socket

- 114-33208 <MT1>
- 114-33209 <MT2>

Boring bar sleeve

- 115-63260 (Ø8)
- 115-63261 (Ø10)
- 115-63211 (Ø12)
- 115-63212 (Ø16)
- 115-63213 (Ø20)

Boring bar sleeve

- 115-63214 (Ø25)

Boring bar sleeve

- 165-63352 (Ø8)
- 165-63353 (Ø10)
- 165-63354 (Ø12)

Boring bar sleeve

- 165-63356 (Ø16)
- 165-63358 (Ø20)
- 165-63359 (Ø25)

Boring bar sleeve

- 165-63347 (Ø16)
- 165-63349 (Ø20)
- 165-63350 (Ø25)

Boring bar sleeve

- 115-62538 (Ø8 mm)
- 115-62539 (Ø10 mm)
- 115-62540 (Ø12 mm)

Boring bar sleeve

- 115-62541 (Ø16 mm)

D40

- 165-64247 (Ø8)
- 165-64248 (Ø10)
- 165-64249 (Ø12)
- 165-64251 (Ø16)
- 165-64253 (Ø20)
- 165-64254 (Ø25)
- 165-64255 (Ø32)
- 165-64241 (Ø16)
- 165-64243 (Ø20)
- 165-64244 (Ø25)
- 165-64245 (Ø32)

- Boring bar sleeve
- 165-62551 (Ø8)
- 165-62552 (Ø10)
- 165-62553 (Ø12)

- Boring bar sleeve
- 165-62555 (Ø16)
- 165-62557 (Ø20)

- Boring bar sleeve
- 165-62545 (Ø12)
- 165-62547 (Ø16)
- 165-62549 (Ø20)

DOOSAN (BMT55)

LYNX 300 (M)
 PUMA 1500/2000/2500 (M,S,Y)
 PUMA 2100 (Y,LY,SY,LSY)
 PUMA 2100/2600/3100 M/Y/MS/SY
 PUMA 230/240/280 (M,LM,S)
 PUMA GT2100M / PUMA H250TM
 PUMA H250TM
 PUMA MX2100 (ST/LST)
 PUMA TL2000/2500 (M,LM)
 PUMA TT1500/1800 (MS,SY)

**SAMSUNG
 HARDINGE
 HYUNDAI WIA**

**HWACHEON
 VICTOR**

PL 240LM
 T-51 / 65 super precision H51
 WIA L230 LMSA
 SKT-160 / 180 TTMS / TTSY
 LM 1600 / 1800 TTSY
 CUTEX-160 / 240 / T2
 VTURN-A16/A20 (YSCM)

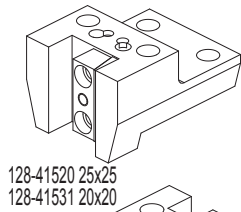

128-41520 25x25
 128-41531 20x20

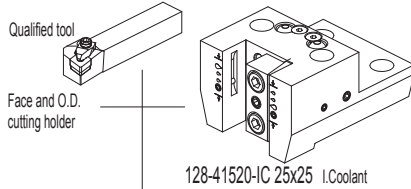

128-41520-IC 25x25 I.Coolant

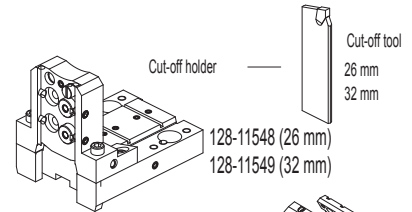

128-11548 (26 mm)
 128-11549 (32 mm)

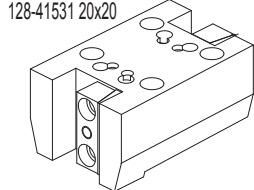

128-41521 25x25
 128-41533 20x20

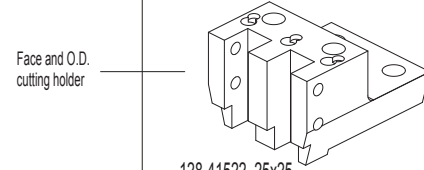

128-41522 25x25

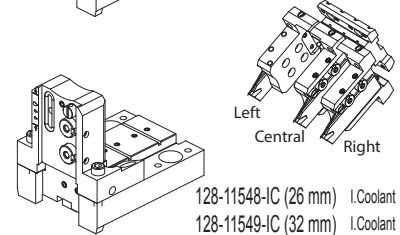

128-11548-IC (26 mm) I.Coolant
 128-11549-IC (32 mm) I.Coolant

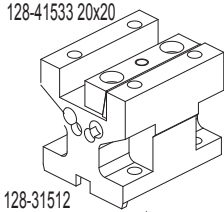

128-31512

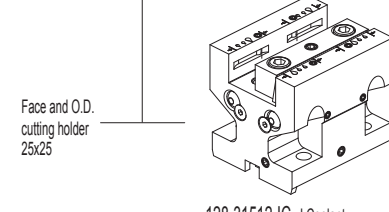

128-31512-IC I.Coolant

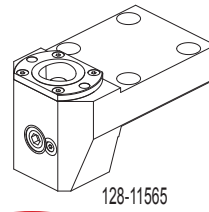

128-11565

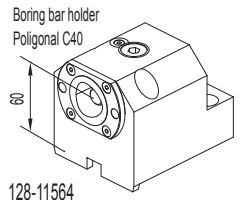

128-11564

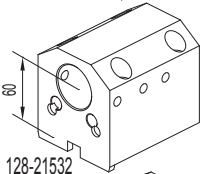

128-21532

Toolholder
 for boring bar
 Ø40 mm

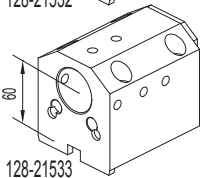

128-21533

Combi toolholder
 for boring bar
 and insertdrill
 Ø40 mm

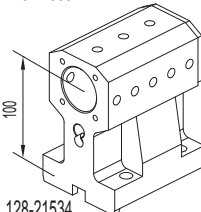

128-21534

Combi toolholder
 for boring bar
 and insertdrill
 Ø40 mm

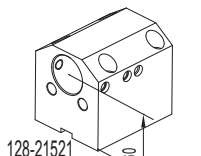

128-21521

Boring bar holder
 Ø40 mm

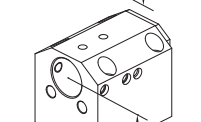

128-21522

Combi toolholder
 for boring bar
 and insertdrill with internal
 coolant
 Ø40 mm

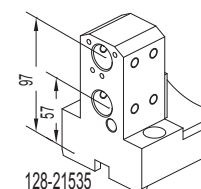

128-21535

Combi toolholder
 for boring bar
 and insertdrill
 2xØ20 mm

ACCESSORIES



Drill socket
 114-34012 <MT1>
 114-34013 <MT2>
 114-34014 <MT3>

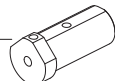

Boring bar sleeve
 165-64089 (Ø10)
 165-64090 (Ø12)
 165-64091 (Ø16)

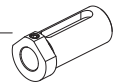

Boring bar sleeve
 165-64092 (Ø20)
 165-64093 (Ø25)
 165-64094 (Ø32)

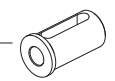

Throw-away drill socket
 165-64095 (Ø20)
 165-64096 (Ø25)
 165-64097 (Ø32)

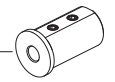

Boring bar sleeve
 165-64247 (Ø8)
 165-64248 (Ø10)
 165-64249 (Ø12)



Boring bar sleeve
 165-64251 (Ø16)
 165-64253 (Ø20)
 165-64254 (Ø25)
 165-64255 (Ø32)

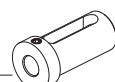

Boring bar sleeve
 165-64241 (Ø16)
 165-64243 (Ø20)
 165-64244 (Ø25)
 165-64245 (Ø32)

NEWS

Driven tools

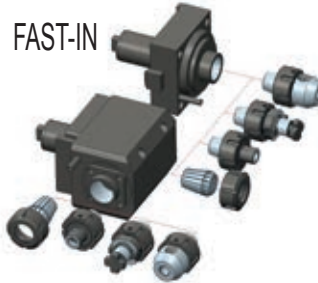

FAST-IN



Protection cover
 137-00253

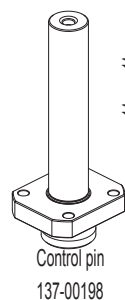

Control pin
 137-00198



124-05501
 124-06509 i.coolant



124-05502
 124-06510 i.coolant
 124-06519 i.coolant 80 BAR

CONNECTION

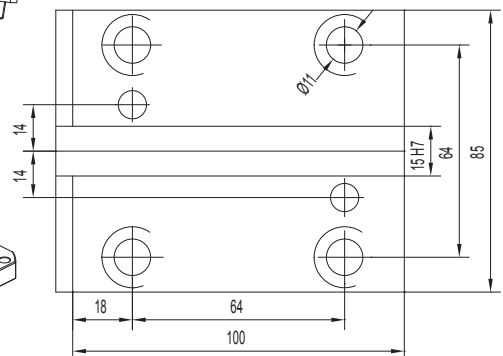

DOOSAN PUMA (BMT65)

PUMA 2100/2600 (M,LM,MS,LMS)
 PUMA 2100/2600 (Y,LY,SY,LSY)
 PUMA 300 (M,MS,MB,MC)
 PUMA 3100 (M,LM,LY,XLM,XLY,ULM,ULY)
 PUMA MX2000/2500
 PUMA MX2600 (T,ST)
 PUMA TT2500 (MS/SY)
 PUMA V400 (M)
 PUMA VT450 (M,2SP)
 PUMA TT2000

HWACHEON
 CUTEX-240
 HI-TECH200/T2-Series
 HI-TECH300/400
 VT-450

HYUNDAI WIA
 L2100SY
 SKT-200/250TTSY
 SKT-250/300 (L,M)
 SKT-250/300 (MS)
 L300M / MS
 LM 2000 / 2500 TTM
 2500 TTMS / 2500 TTSY

MAXSIN
 BMT65

SMEC/SAMSUNG
 SL25 / SL35
 PL 20/25M - PL 35LM - PL 2000/2500Y

TONGTAI
 TMT2000

VICTOR
 VTURN-A26 (YSCM)

HAAS
 ST-20 - ST-25 - ST-30
 ST-35 - DS-30Y
 ST-20Y - ST-25Y - ST-30Y - ST-35Y

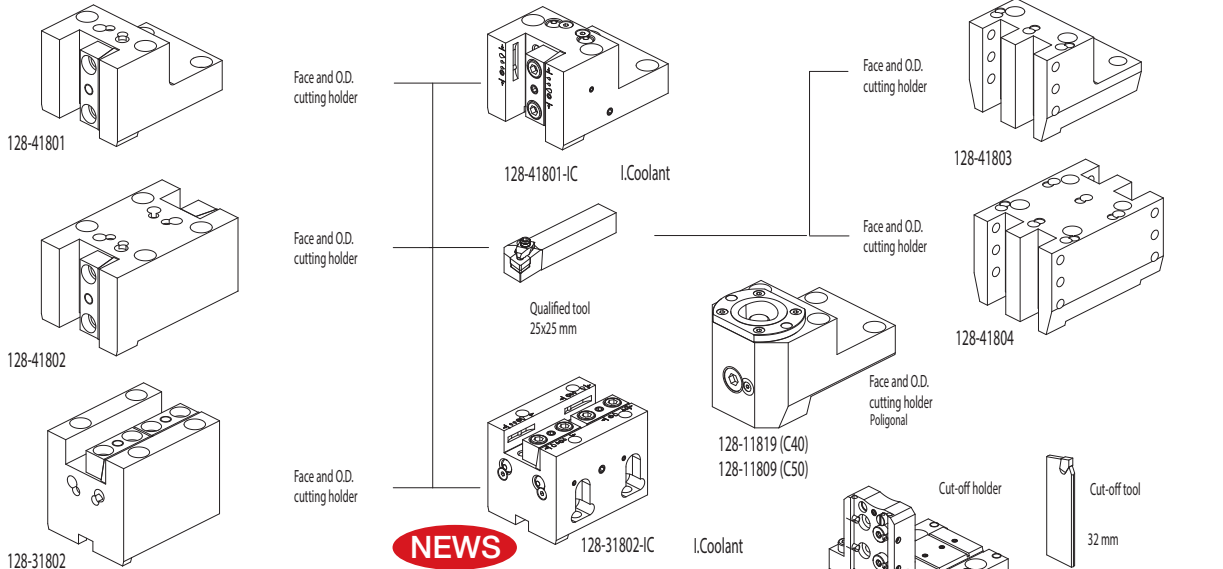

NEWS

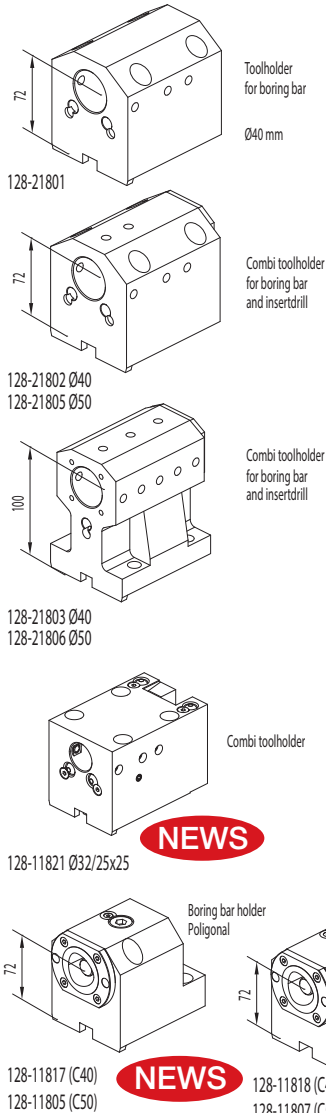

ACCESSORIES

- Drill socket D40
 - 114-34012 <MT1>
 - 114-34013 <MT2>
 - 114-34014 <MT3>
- Boring bar sleeve D40
 - 165-64089 (Ø10)
 - 165-64090 (Ø12)
 - 165-64091 (Ø16)
- Boring bar sleeve D40
 - 165-64092 (Ø20)
 - 165-64093 (Ø25)
 - 165-64094 (Ø32)
- Throw-away drill socket D40
 - 165-64095 (Ø20)
 - 165-64096 (Ø25)
 - 165-64097 (Ø32)
- Boring bar sleeve D40
 - 165-64247 (Ø8)
 - 165-64248 (Ø10)
 - 165-64249 (Ø12)
- Boring bar sleeve D40
 - 165-64251 (Ø16)
 - 165-64253 (Ø20)
 - 165-64254 (Ø25)
 - 165-64255 (Ø32)
- Boring bar sleeve D40
 - 165-64241 (Ø16)
 - 165-64243 (Ø20)
 - 165-64244 (Ø25)
 - 165-64245 (Ø32)
- Boring bar sleeve D50
 - 165-65017 (Ø25)
 - 165-65018 (Ø32)
 - 165-65019 (Ø40)

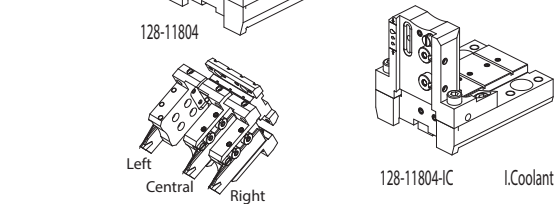

Driven tools

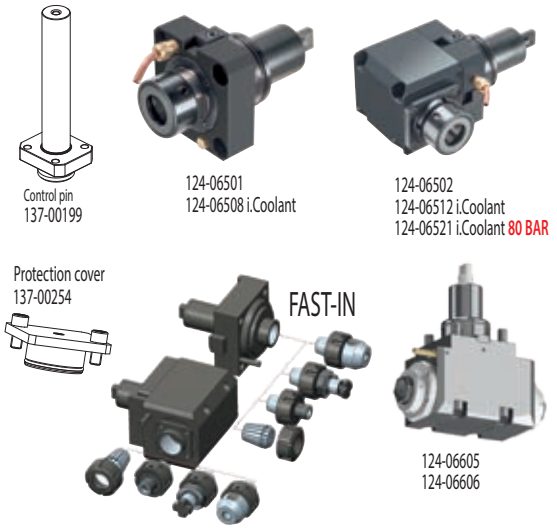

FAST-IN

CONNECTION

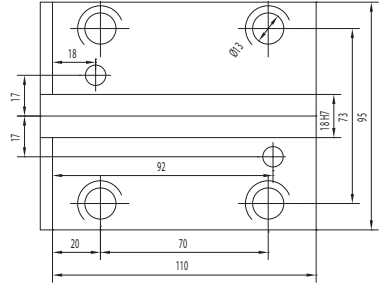

DOOSAN PUMA (BMT75)

400/480 (M,LM,XML)
500 (M)
V550(M)
VT750 (TM, 2SP)

SAMSUNG
HYUNDAI WIA
HWACHEON

PL 45LM
LV800RM /SKT-V80R
RM / SKT400M / MA / MC / LMC
HI-TECH 550 / 700 / 7026
VT-550

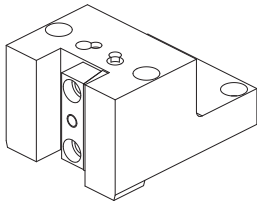

128-42508 25x25 mm
128-42516 32x32 mm

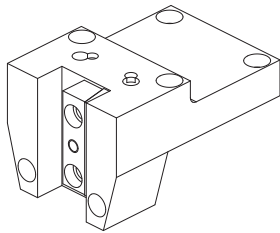

128-42509 25x25 mm
128-42510 32x32 mm

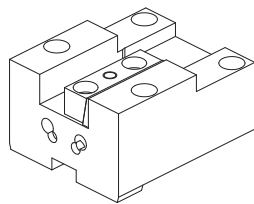

128-32506 25x25 mm

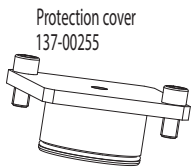

Protection cover
137-00255

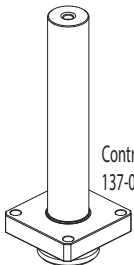

Control pin
137-00200

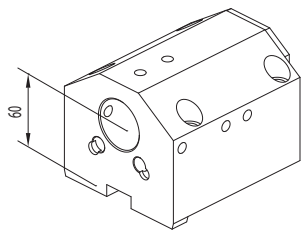

128-22522 Ø40 mm
128-22523 Ø50 mm
128-22539 Ø60 mm

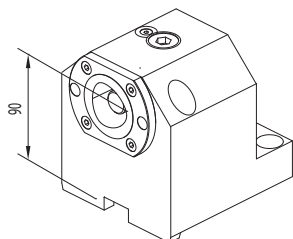

128-12515 (C50)
128-12528 (C63)

NEWS

Face and O.D.
cutting holder

Face and O.D.
cutting holder

Face and O.D.
cutting holder

ACCESSORIES

Combi toolholder
for boring bar
and insert drill

Boring bar holder
Polygonal

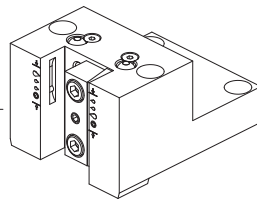

128-42508-IC 25x25 mm I.Coolant

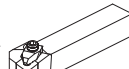

Qualified tool

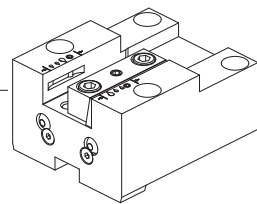

128-32506-IC 25x25 mm I.Coolant

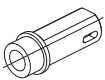

Drill socket D40
114-34012 <MT1>
114-34013 <MT2>
114-34014 <MT3>

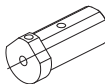

Boring bar sleeve D40
165-64089 (Ø10)
165-64090 (Ø12)
165-64091 (Ø16)

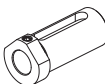

Boring bar sleeve D40
165-64092 (Ø20)
165-64093 (Ø25)
165-64094 (Ø32)

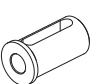

Throw-away drill socket D40
165-64095 (Ø20)
165-64096 (Ø25)
165-64097 (Ø32)



Boring bar sleeve D40
165-64247 (Ø8)
165-64248 (Ø10)
165-64249 (Ø12)



Boring bar sleeve D40
165-64251 (Ø16)
165-64253 (Ø20)
165-64254 (Ø25)
165-64255 (Ø32)



Boring bar sleeve D40
165-64241 (Ø16)
165-64243 (Ø20)
165-64244 (Ø25)
165-64245 (Ø32)

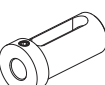

Boring bar sleeve D50
165-65017 (Ø25)
165-65018 (Ø32)
165-65019 (Ø40)



Boring bar sleeve D60
165-66056 (Ø25)
165-66057 (Ø32)
165-66058 (Ø40)
165-66059 (Ø50)

CONNECTION

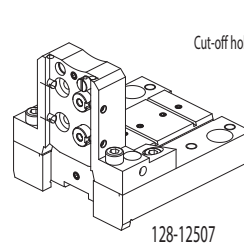
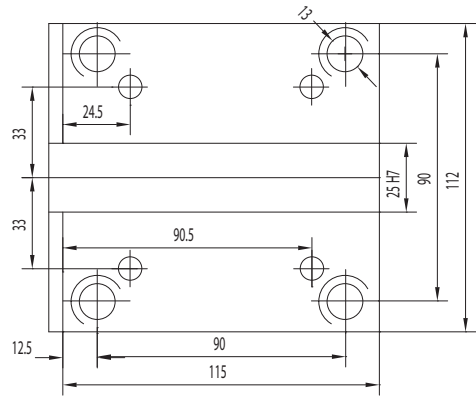

Cut-off holder



Cut-off tool
32 mm

128-12507

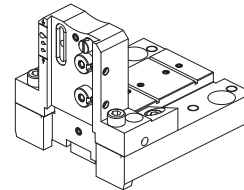

128-12507-IC I.Coolant

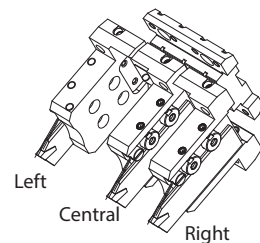

Left

Central

Right

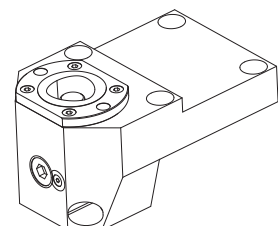

Face and O.D.
cutting holder
Polygonal

128-12517 (C50)
128-12529 (C63)

NEWS

DOOSAN PUMA (BMT85)

600M/LM
700M/LM
800M/LM
VT900M/TM
VT1100M

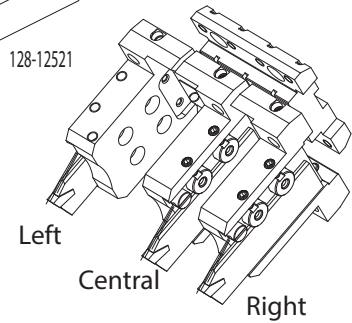
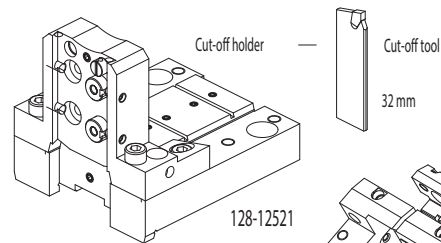
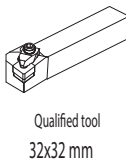
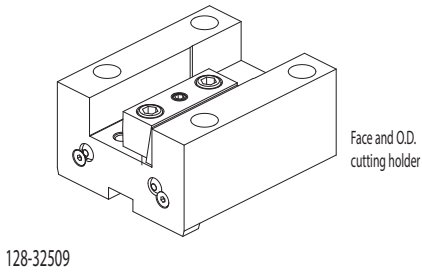
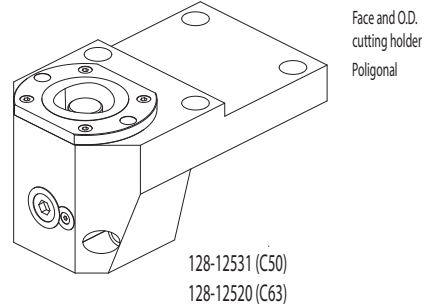
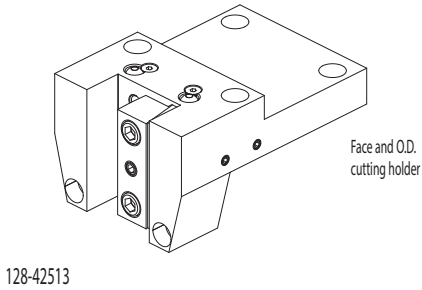

ACCESSORIES

Boring bar sleeve D50
115-65053 (Ø12)
115-65013 (Ø16)
115-65014 (Ø20)
115-65015 (Ø25)
115-65016 (Ø32)
Boring bar sleeve D60
115-66017 (Ø20)
115-66018 (Ø25)
115-66019 (Ø32)
115-66020 (Ø40)

Boring bar sleeve D50
115-65017 (Ø40)
Boring bar sleeve D60
115-66021 (Ø50)

Boring bar sleeve D50
165-65017 (Ø25)
165-65018 (Ø32)
165-65019 (Ø40)

Boring bar sleeve D60
165-66056 (Ø25)
165-66057 (Ø32)
165-66058 (Ø40)
165-66059 (Ø50)

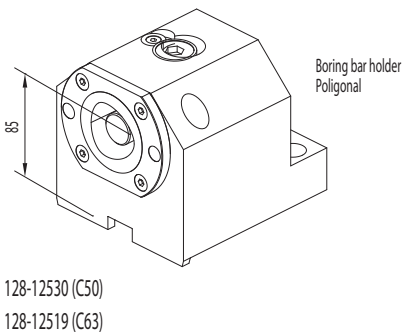
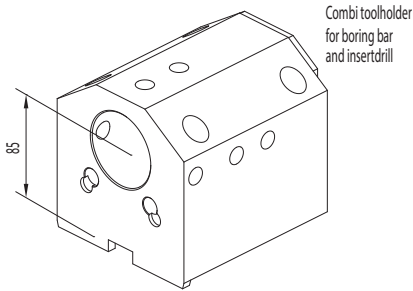

CONNECTION

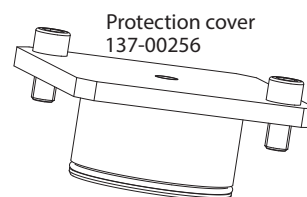
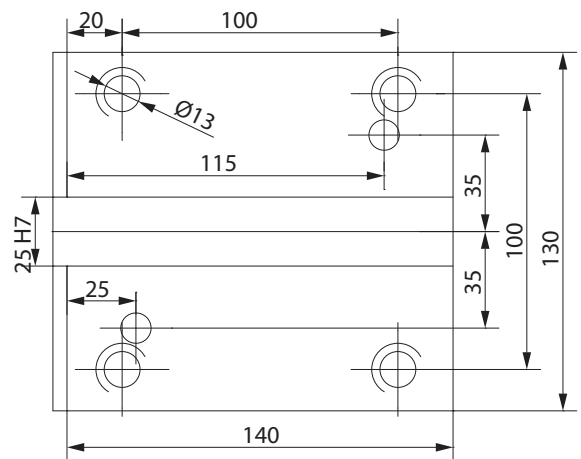

MAZAK NEXUS SQT100/150

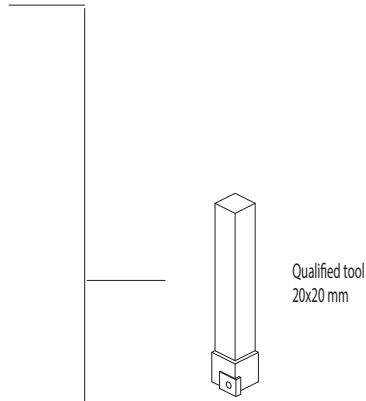
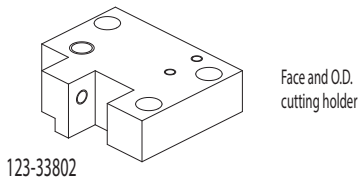
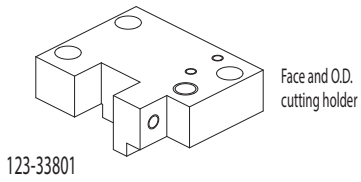

CONNECTION

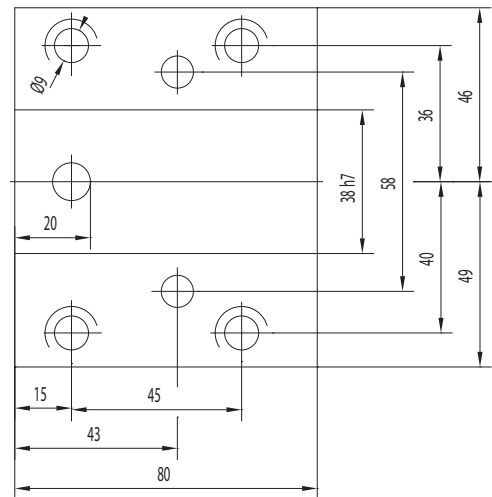

ACCESSORIES

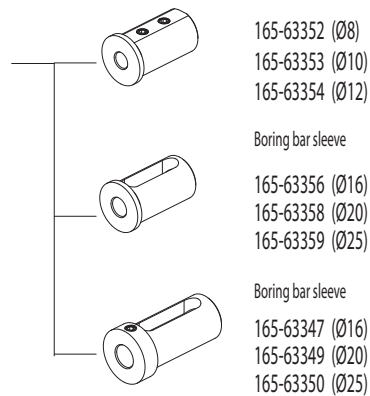
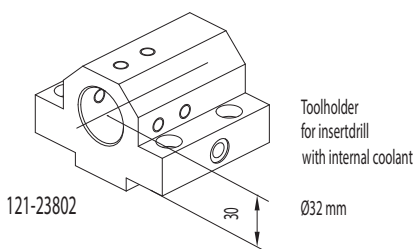
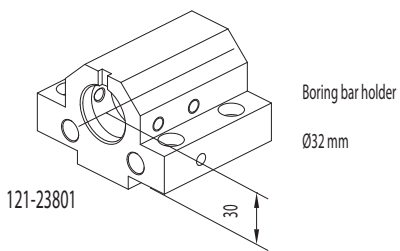

MAZAK NEXUS QTN200/250

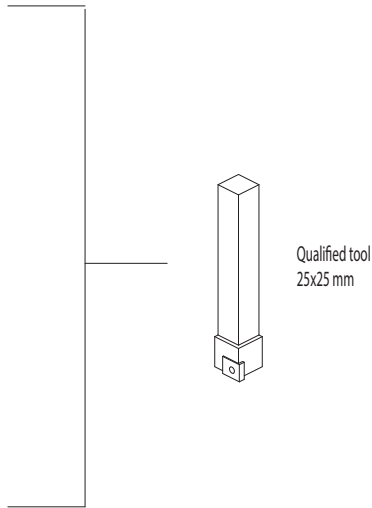
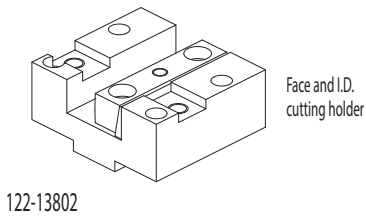
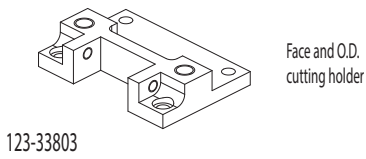

CONNECTION

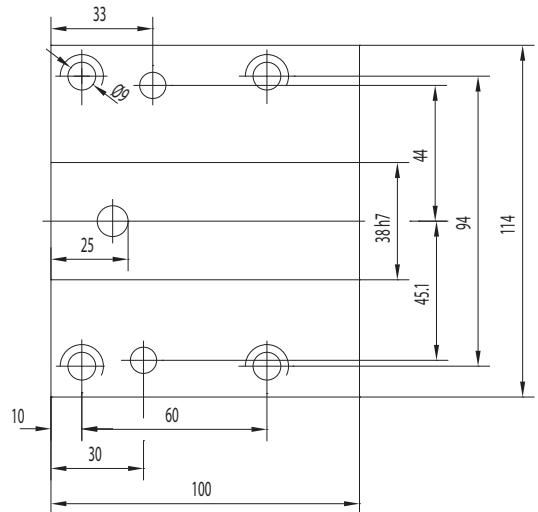

ACCESSORIES

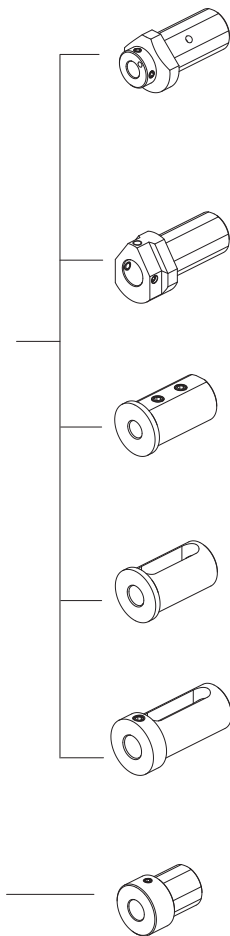
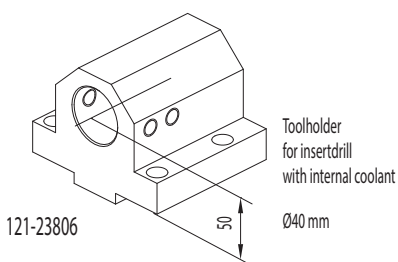
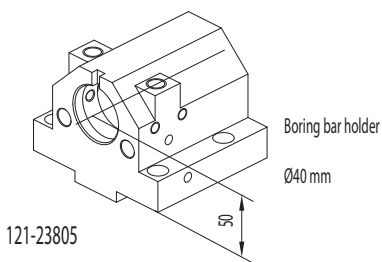

Boring bar sleeve

- 165-64114 (Ø8)
- 165-64115 (Ø10)
- 165-64116 (Ø12)
- 165-64117 (Ø16)
- 165-64118 (Ø20)

Boring bar sleeve

- 165-64119 (Ø25)
- 165-64120 (Ø32)

Boring bar sleeve

- 165-64247 (Ø8)
- 165-64248 (Ø10)
- 165-64249 (Ø12)

Boring bar sleeve

- 165-64251 (Ø16)
- 165-64253 (Ø20)
- 165-64254 (Å25)
- 165-64255 (Å32)

Boring bar sleeve

- 165-64241 (Ø16)
- 165-64243 (Ø20)
- 165-64244 (Ø25)
- 165-64245 (Ø32)

Throw-away drill socket

- 165-64121 (Ø20 mm)
- 165-64122 (Ø25 mm)
- 165-64123 (Ø32 mm)

MAZAK SQT

SQT 15, SQT 18 M / MS - 12 Stations
SQT 200, SQT 250 M / MS - 12 Stations

MAZAK QTN (VDI40)

QTN 200, QTN 250 M / MB / MS / MY / MSY - 12 Stations

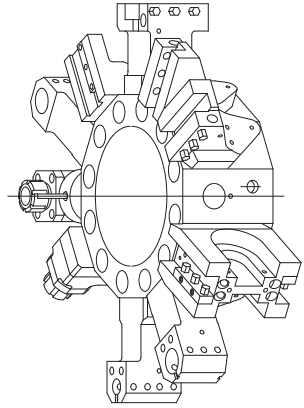
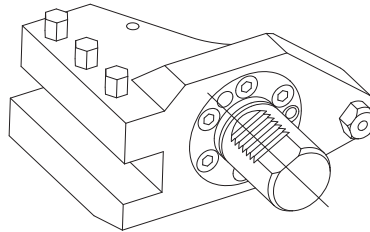
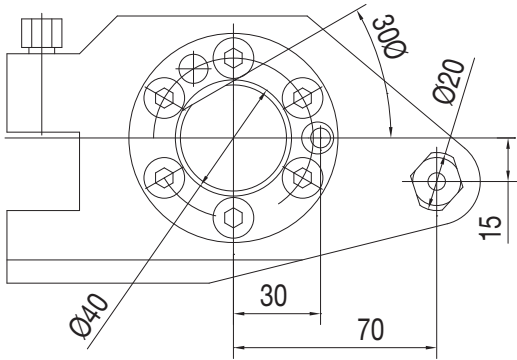

ACCESSORIES

Qualified tool
25x25 mm

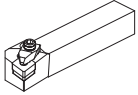

KMZ-53618000100

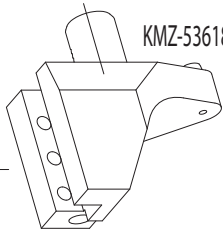

KMZ-53618000600

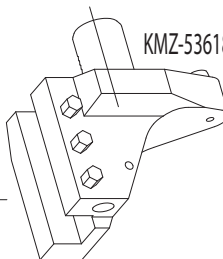

KMZ-53638000300

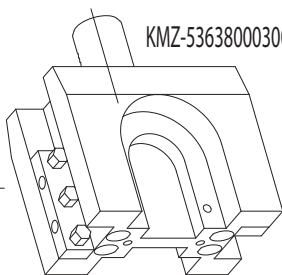

KMZ-53618000300

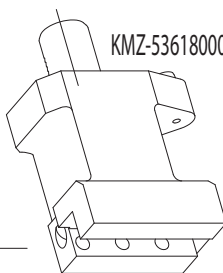

Boring bar sleeve

- 165-64114 (Ø8)
- 165-64115 (Ø10)
- 165-64116 (Ø12)
- 165-64117 (Ø16)
- 165-64118 (Ø20)

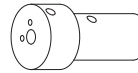

Boring bar sleeve

- 165-64119 (Ø25)
- 165-64120 (Ø32)

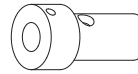

Boring bar sleeve

- 165-64247 (Ø8)
- 165-64248 (Ø10)
- 165-64249 (Ø12)

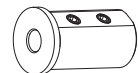

Boring bar sleeve

- 165-64251 (Ø16)
- 165-64253 (Ø20)
- 165-64254 (Ø25)
- 165-64255 (Ø32)



Boring bar sleeve

- 165-64241 (Ø16)
- 165-64243 (Ø20)
- 165-64244 (Ø25)
- 165-64245 (Ø32)



Throw-away drill socket

- 165-64121 (Ø20)
- 165-64122 (Ø25)
- 165-64123 (Ø32)

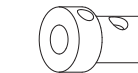

Cut-off tool
32 mm

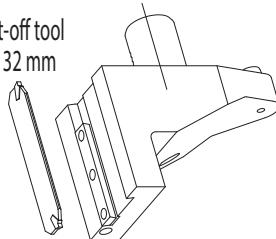

KMZ-53618000400

ER32
COLLET

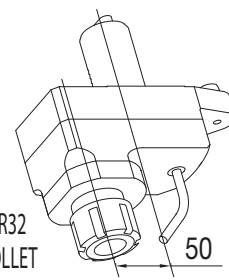

116-54019

ER32
COLLET

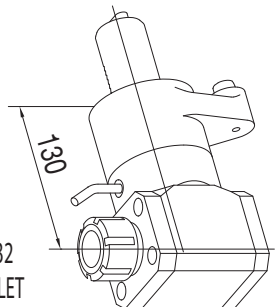

116-54020

KMZ-53208005100

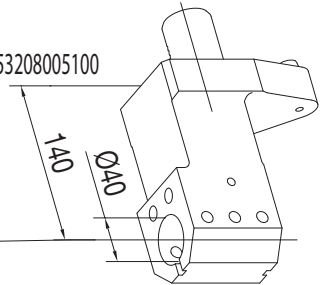

KMZ-53638000400

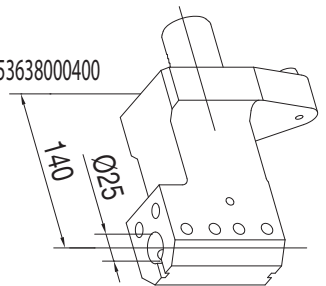

KMZ-53208005200

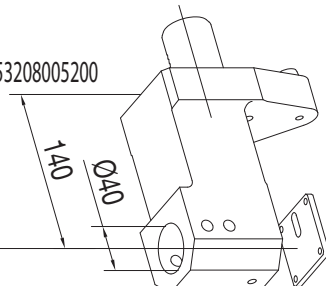

MAZAK
(BMT68)

QTC/QTU 100-350 M/MY/MS/MSY
QT/QTS 100-250 M/MY//MS/MSY
QT 200-250 M/MY//MS/MSY (16D)

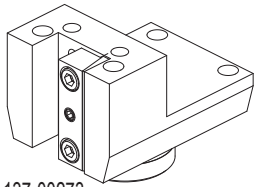

Face and O.D. cutting holder

137-00273

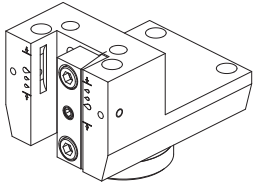

Face and O.D. cutting holder

137-00273-IC I.Coolant

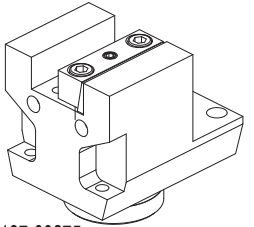

Face and I.D. cutting holder

137-00275

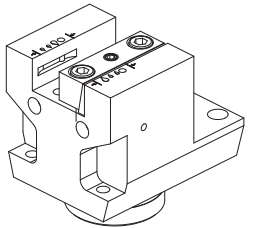

Face and I.D. cutting holder

137-00275-IC I.Coolant

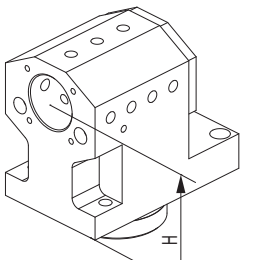

Combi toolholder for boring bar and insertdrill
Ø40 mm

137-00277 (H=90 mm)
137-00278 (H=95 mm)

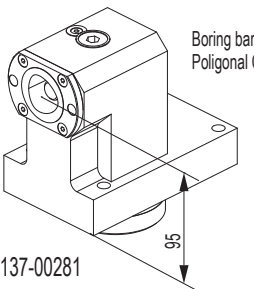

Boring bar holder
Polygonal C40

137-00281

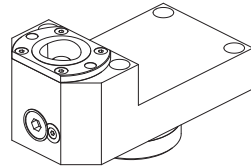

Face and O.D. cutting holder
Polygonal C40

137-00282



Qualified tool
25x25 mm

CONNECTION

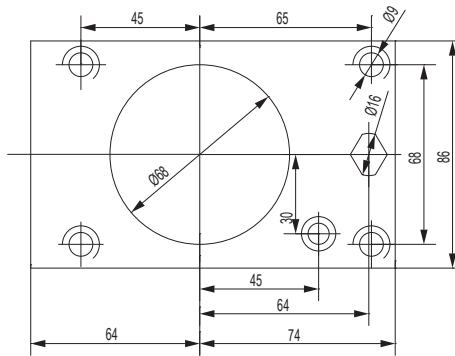

ACCESSORIES

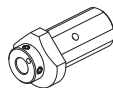

Boring bar sleeve

- 165-64114 (Ø8)
- 165-64115 (Ø10)
- 165-64116 (Ø12)
- 165-64117 (Ø16)
- 165-64118 (Ø20)

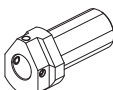

Boring bar sleeve

- 165-64119 (Ø25)
- 165-64120 (Ø32)



Throw-away drill socket

- 165-64121 (Ø20)
- 165-64122 (Ø25)
- 165-64123 (Ø32)

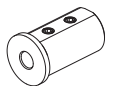

Boring bar sleeve

- 165-64247 (Ø8)
- 165-64248 (Ø10)
- 165-64249 (Ø12)



Boring bar sleeve

- 165-64251 (Ø16)
- 165-64253 (Ø20)
- 165-64254 (Ø25)
- 165-64255 (Ø32)

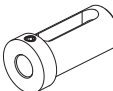

Boring bar sleeve

- 165-64241 (Ø16)
- 165-64243 (Ø20)
- 165-64244 (Ø25)
- 165-64245 (Ø32)

Driven tools

FAST-IN

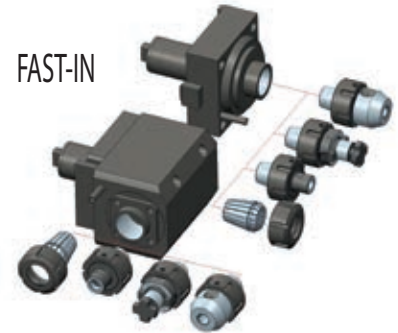

124-06805
124-06806 i.coolant



124-06807
124-06808 i.coolant
124-06809 i.coolant **80 BAR**

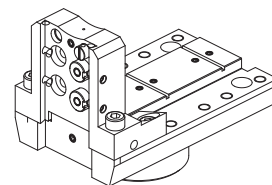

Cut-off holder

137-00279

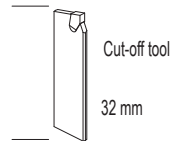

Cut-off tool
32 mm

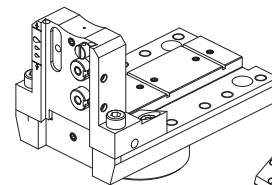

137-00279-IC I.Coolant

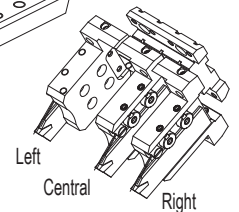

Left
Central
Right

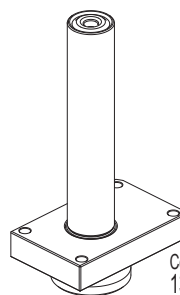

Control pin
137-00201

Protection cover
137-00272

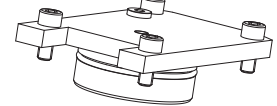

MURATA MURATEC MW120

MW120 8ST
MS60 8ST
MJ60 8ST

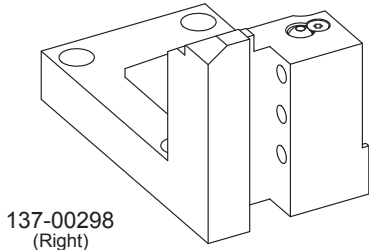

137-00298 (Right)

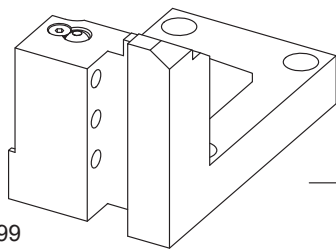

137-00299 (Left)

Qualified tool
20x20 mm

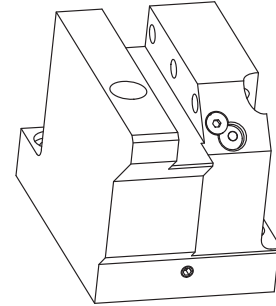

137-00296 (Right)

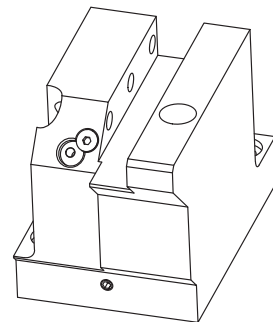

137-00297 (Left)

ACCESSORIES

Combi toolholder
for boring bar
and insertdrill
Ø40

Cover
832-003402

137-00300

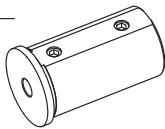
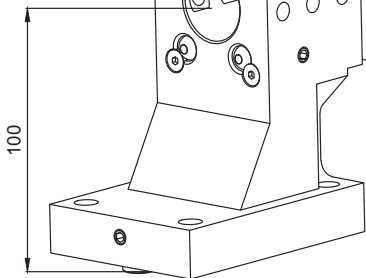

- 165-64247(Ø8 mm)
- 165-64248(Ø10 mm)
- 165-64249(Ø12 mm)

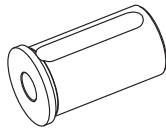

- 165-64251(Ø16 mm)
- 165-64253(Ø20 mm)
- 165-64254(Ø25 mm)
- 165-64255(Ø32 mm)

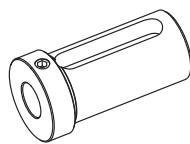

- 165-64241(Ø16 mm)
- 165-64243(Ø20 mm)
- 165-64244(Ø25 mm)
- 165-64245(Ø32 mm)

Boring bar holder
Polygonal

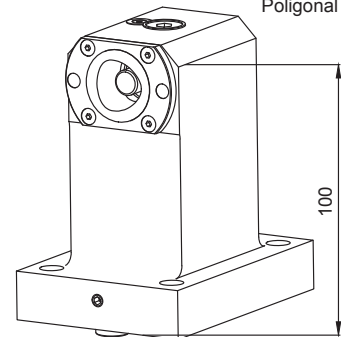

137-00263 (C40)
137-00313 (C50)

CONNECTION

Cutting holder
Polygonal

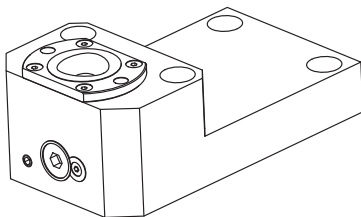

137-00262 (C40)
137-00314 (C50)

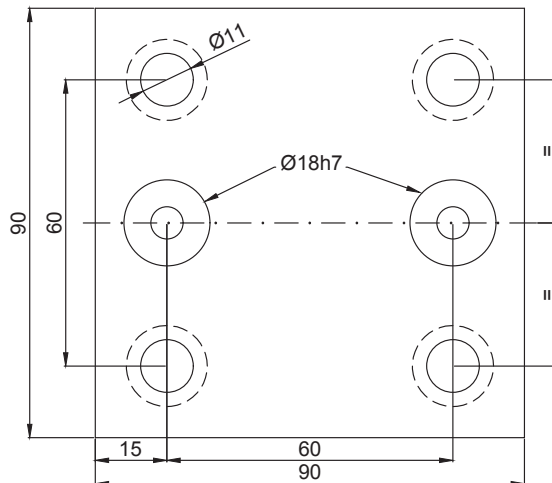

MURATA MURATEC MW200

MW200 10ST
 MW180 10ST
 MS100 10ST
 MS90 10ST
 MJ100 10ST

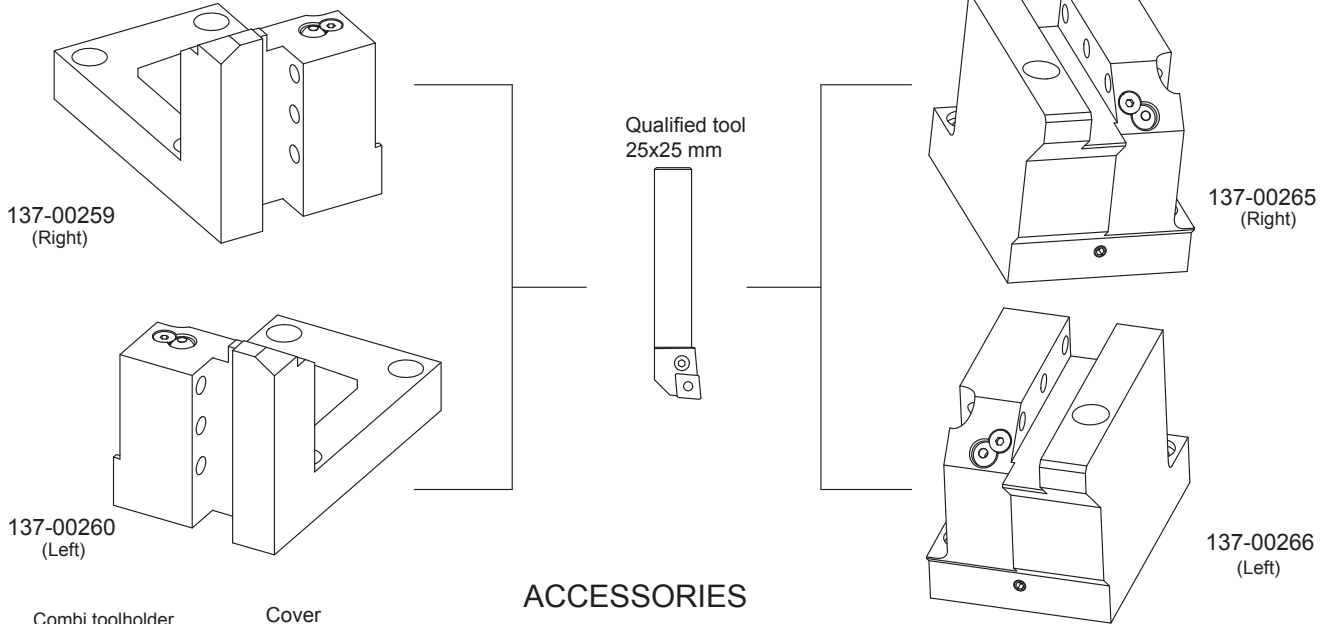

ACCESSORIES

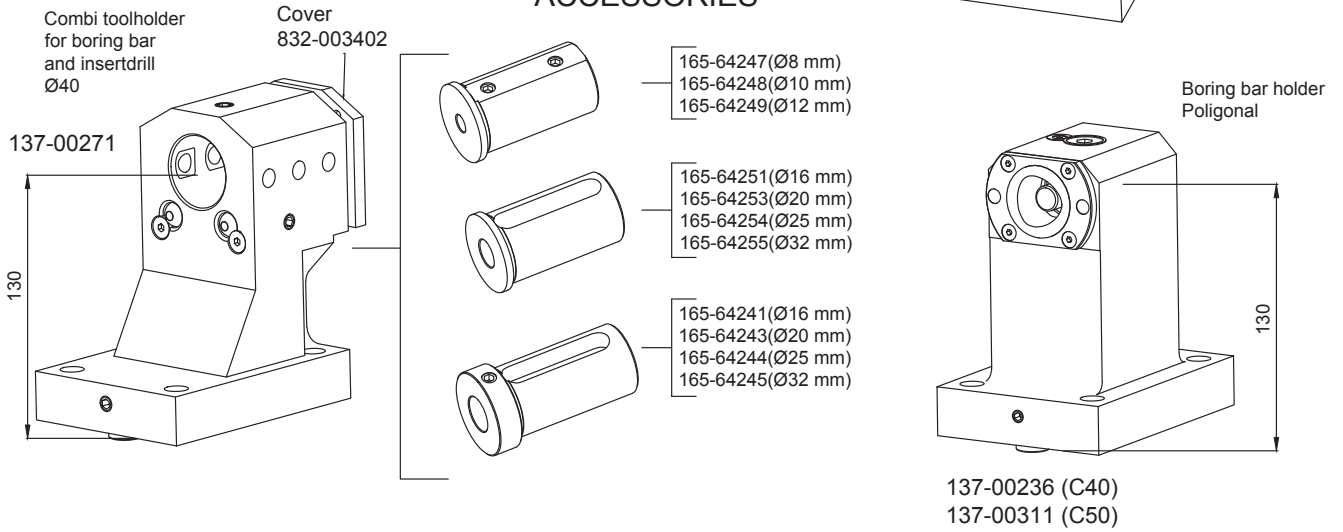

CONNECTION

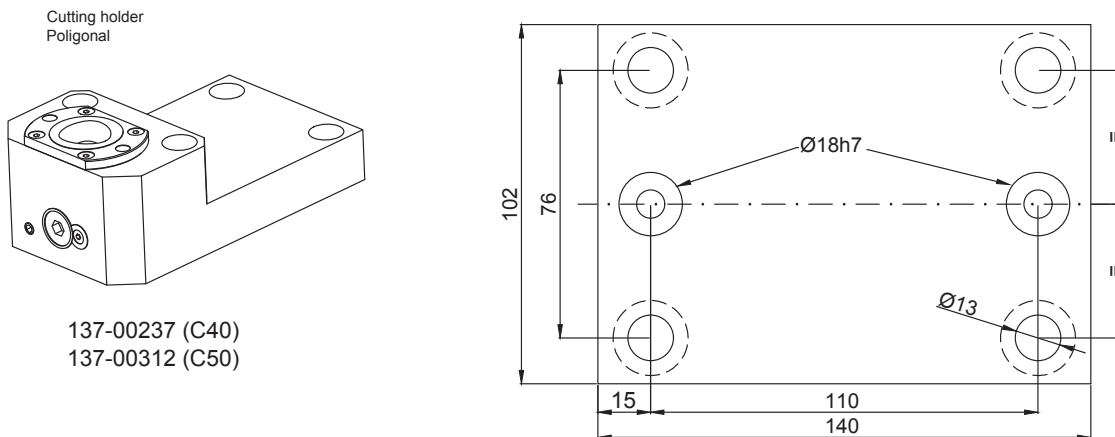

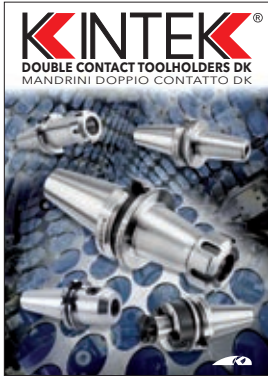
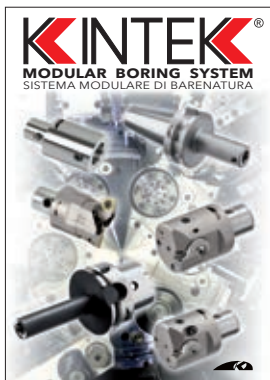

OUR COMPLETE RANGE



NEW PRODUCTION PLANT
KINTEK S.R.L. - MAPPANO - TORINO - ITALY



HEAD OFFICE
KINTEK S.R.L. - MAPPANO - TORINO - ITALY



MAIN PRODUCTION PLANT
KINTEK TOOLING KFT - BEKESCSABA - HUNGARY



KINTEK s.r.l.

Società a responsabilità limitata Unipersonale
Società soggetta alla direzione e coordinamento di KINTEK HOLDING S.r.l.

Via Goretta 88/G - 10079 MAPPANO (TO) - Italy
Tel.: +39 011 99 68 065 - Fax: +39 011 99 65 662
E-mail: info@kintek.it - Url: www.kintek.it

Cod. Fisc. e Partita Iva: 08746040016 - Cap. Soc.: € 179.850,00
R.E.A: 997323 - R.I. Uff. To: 08746040016
Codice Univoco: M5UXCR1

